

1104

Claim of Beneficial Use
Application G-9714; Permit G-17842
Water Right in the Name of City of Troutdale
Multnomah County
Township 1 North, Range 3 and 4 East;
Township 1 South, Range 3 East (W.M.)

RECEIVED BY OWRD

NOV 09 2017

SALEM, OR

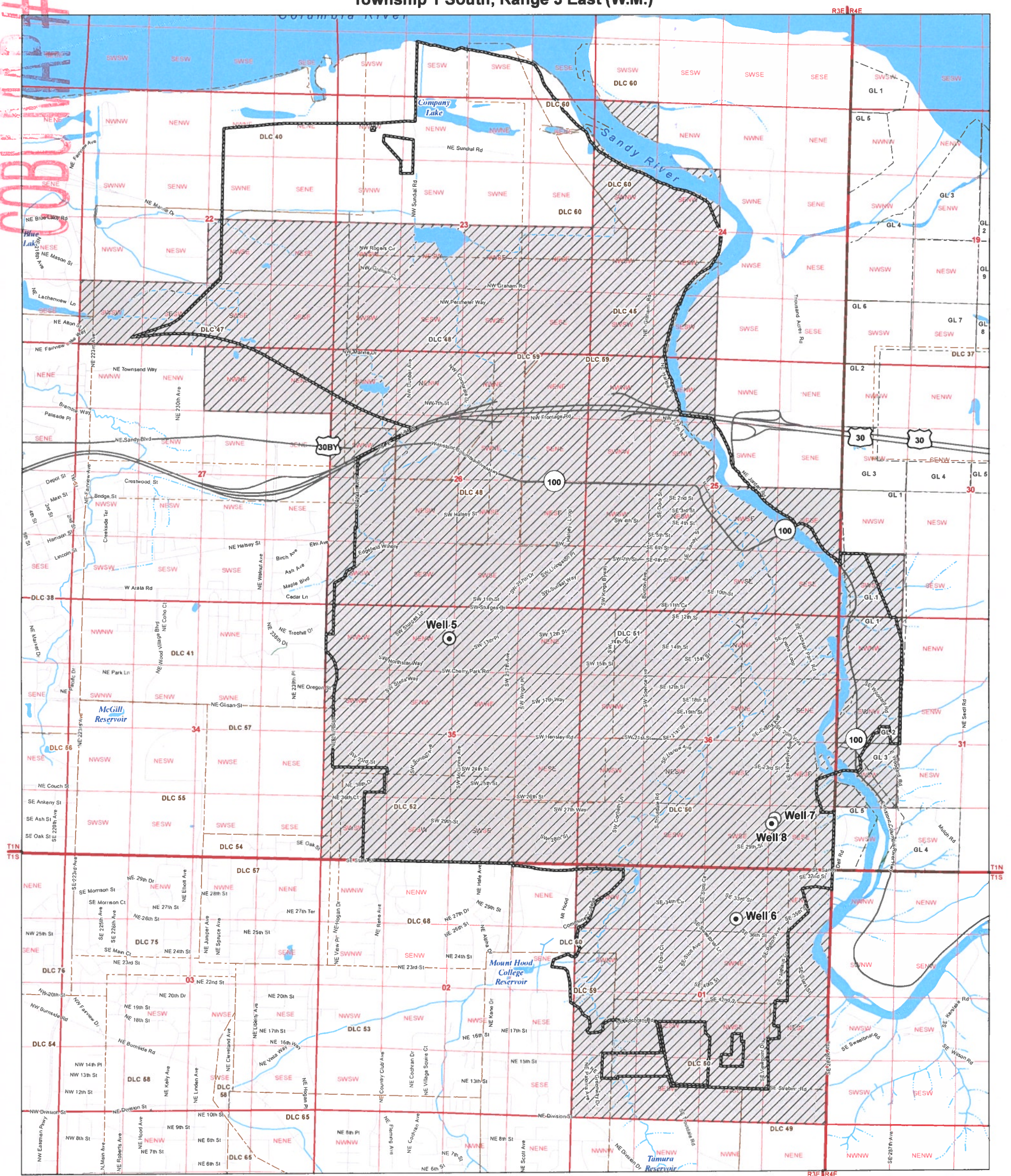

LEGEND

- ⊙ Point of Appropriation (POA)
- Flowmeter
- ▨ Place of Use (POU)
- ▭ Troutdale City Limits
- ▭ Donation Land Claim (DLC)
- Street
- Watercourse, Perennial
- Watercourse, Intermittent
- Waterbody

Certified Water Rights Examiner Stamp

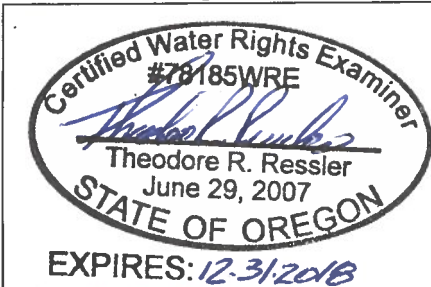

DISCLAIMER
 This map was prepared for the purpose of identifying the location of a water right only and it is not intended to provide legal dimensions or location of property ownership lines.

MAP NOTES

Date: October 24, 2017
 Data Sources: OWRD, US BLM, USGS, OGIC, ESRI
 Prepared By: GSI Water Solutions, Inc.



0 1,000 2,000
 1 inch = 2,000 feet



COBU MAP # 1104