

MAR 14 2016

SALEM, OR

Application for a Historic Point of Diversion in the Name of Stateline Ranch

Certificate 14551, Permit S-15258

Township 6 North, Range 34 East (W.M.)

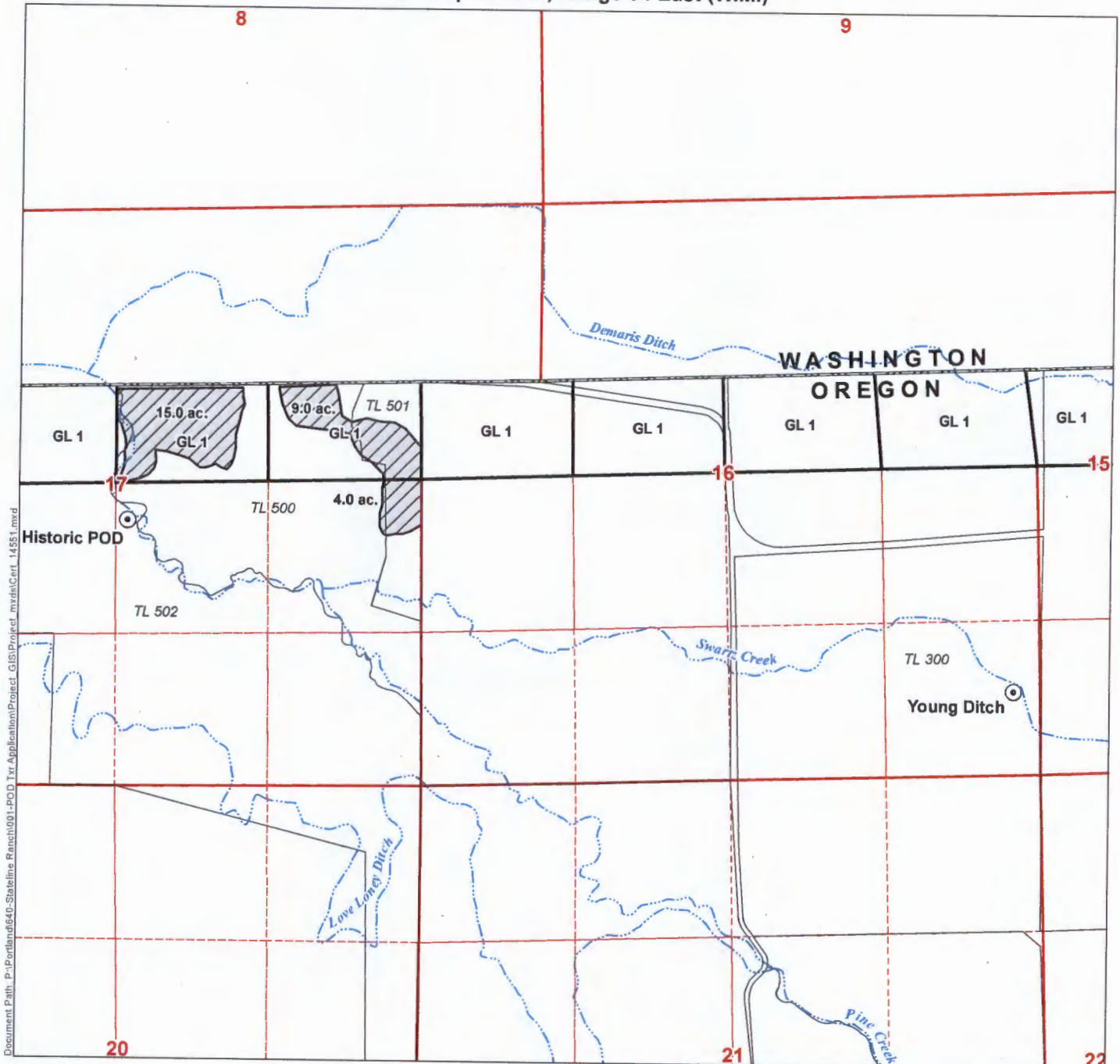

Document Path: P:\Portland\640-Stateline_Ranch\001-POD_Trx_Application\Project_GIS\Project_mv\sh\Cert_14551.mxd

LEGEND

- Point of Diversion (POD)
- Place of Use (POU)
- Tax Lot
- Government Lot (GL)
- Waterbody
- Watercourse

POD LOCATION DESCRIPTIONS

Authorized POD - Young Ditch

Located in the SESE of Section 16, Township 6 North, Range 34 East (W.M.); Young Ditch

Historic POD

Located 2,335 feet North and 2,575 feet West from the SE corner of Section 17, Township 6 North, Range 34 East (W.M.)

DISCLAIMER

This map was prepared for the purpose of identifying the location of a water right only and it is not intended to provide legal dimensions or location of property ownership lines.

MAP NOTES

Date: February 22, 2016
Data Sources: OWRD, Umatilla Co. GIS, US BLM, USGS
Prepared By: GSI Water Solutions, Inc.

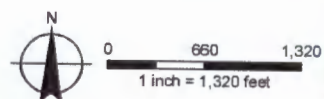

T - 12312