

Application for a Historic Point of Diversion in the Name of Stateline Ranch

Certificates 84152 and 83914, Permit S-19609

Township 6 North, Range 34 East (W.M.)

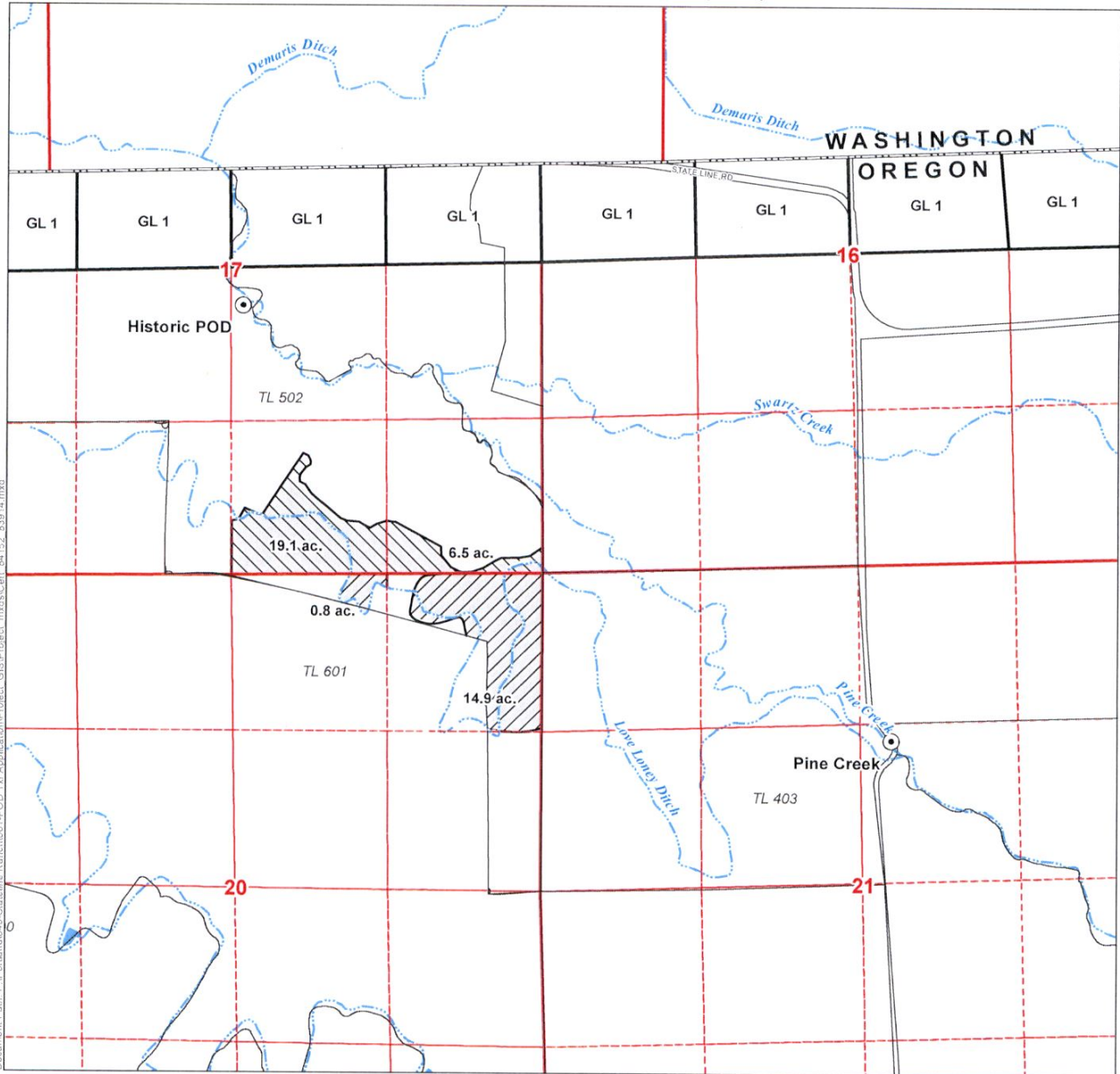

Document Path: P:\Portland\640-Stateline Ranch\001-POD Trx Application\Project_GIS\Project_mxd\84152_83914.mxd

LEGEND

- Point of Diversion (POD)
- Government Lot (GL)
- Place of Use (POU) - Cert. 83914
- Waterbody
- POU - Cert. 84152
- Watercourse
- Tax Lot

DISCLAIMER

This map was prepared for the purpose of identifying the location of a water right only and it is not intended to provide legal dimensions or location of property ownership lines.

MAP NOTES

Date: February 19, 2016
Data Sources: OWRD, Umatilla Co. GIS, US BLM, USGS
Prepared By: GSI Water Solutions, Inc.
Revised: April 20, 2018

POD LOCATION DESCRIPTIONS

Authorized POD - Pine Creek
Located 1,530 feet South and 270 feet East from the N1/4 corner of Section 21, Township 6 North, Range 34 East (W.M.)

Historic POD
Located 2,335 feet North and 2,575 feet West from the SE corner of Section 17, Township 6 North, Range 34 East (W.M.)

