

T. 30S., R. 4 W., W.M.

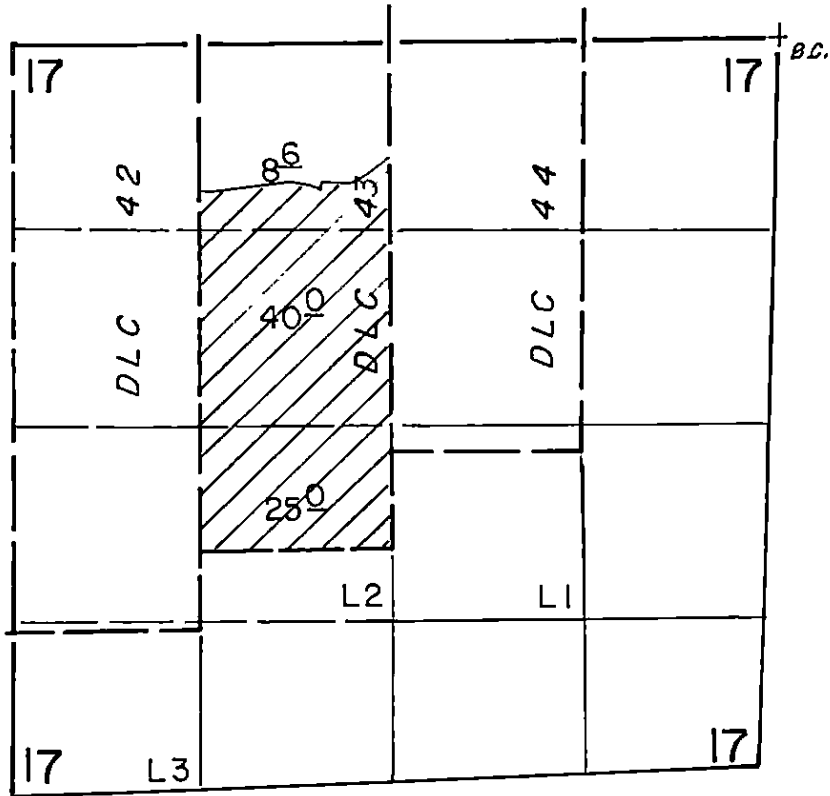

Div. Pt. - 1750' N & 2200' E from SE cor. Sec. 7

Scale 1" = 1320'

FINAL PROOF SURVEY UNDER

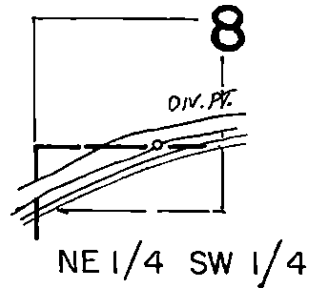

Application No. 63175 Permit No. 47148
IN NAME OF

Surveyed July 20, 1995, by L.M. SMITH