

**Claim of Beneficial Use Map  
 Application G-17341, Permit G-16947  
 Application G-18028, Permit G-17775**

**A Water Right in the Name of Cascade Academy of Central Oregon  
 Township 17 South, Range 12 East, Section 6 (W.M.)**

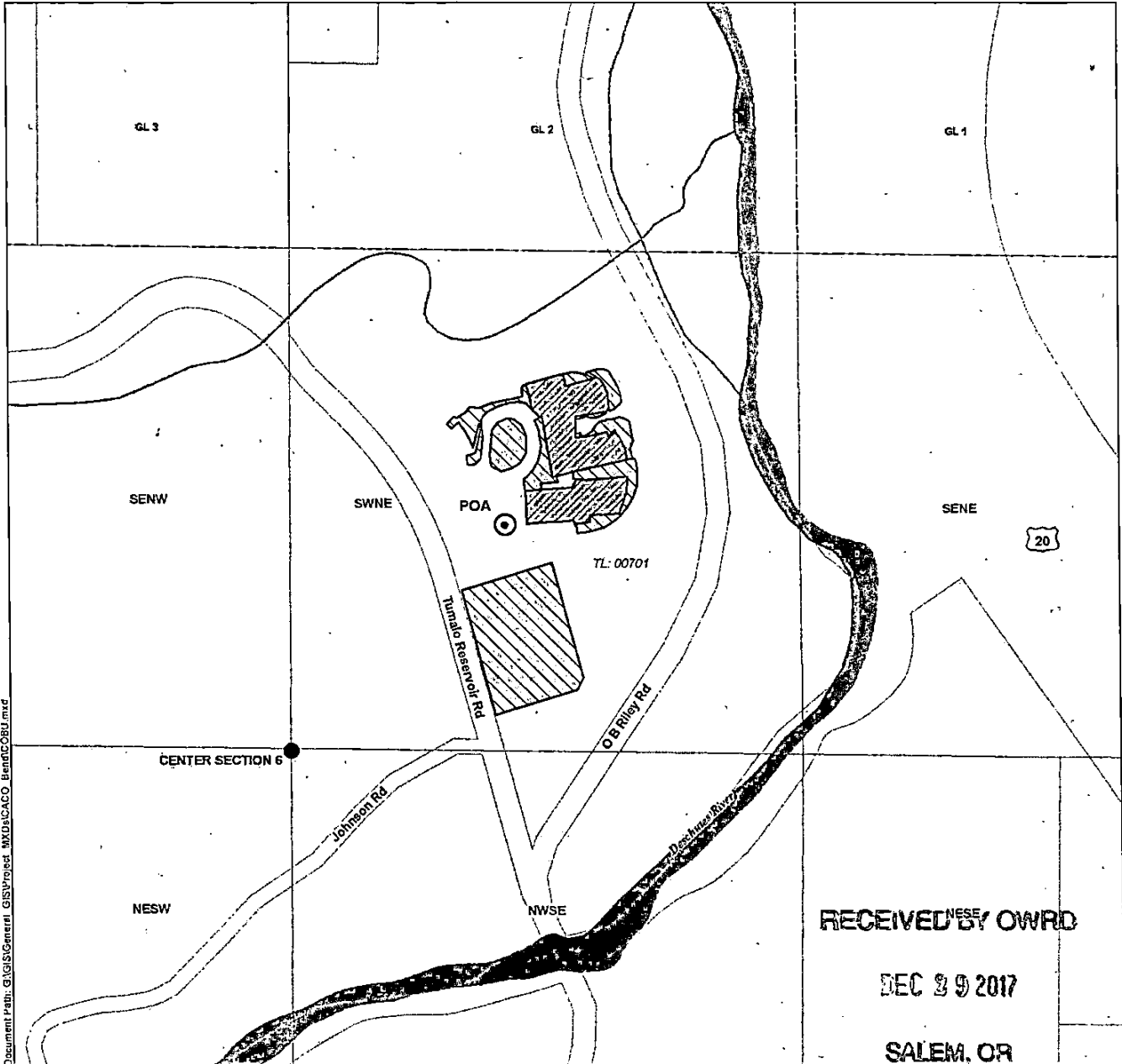

Document Path: G:\GIS\General\_GIS\Project\_MXD\CACO\_BenefCOBU.mxd

**LEGEND**

- |                              |                     |
|------------------------------|---------------------|
| Point of Appropriation (POA) | Tax Lot             |
| Place of Use (POU)           | Government Lot (GL) |
| Commercial                   | Watercourse         |
| Irrigation, 3 acres          | Waterbody           |

**LOCATION-DESCRIPTIONS**

**Point of Appropriation**  
 Located 595 feet North and 575 feet East from the C1/4 corner of Section 6, Township 16 South, Range 12 East (W.M.)  
**Water Meter Location**  
 Located 5 feet south of wellhead in a in-ground irrigation box

**Certified Water Rights Examiner Stamp**

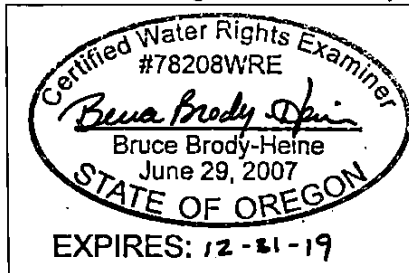

**DISCLAIMER**

This map was prepared for the purpose of identifying the location of a water right only and it is not intended to provide legal dimensions or location of property ownership lines.

**MAP NOTES**

Meter location is in a vault 3 feet south of the well.

Date: December 19, 2017  
 Data Sources: BLM, ESRI, Deschutes Co., USGS

