

Claim of Beneficial Use Map

Application G-17341, Permit G-16947

Application G-18028, Permit G-17775

A Water Right in the Name of Cascade Academy of Central Oregon
Township 17 South, Range 12 East, Section 6 (W.M.)

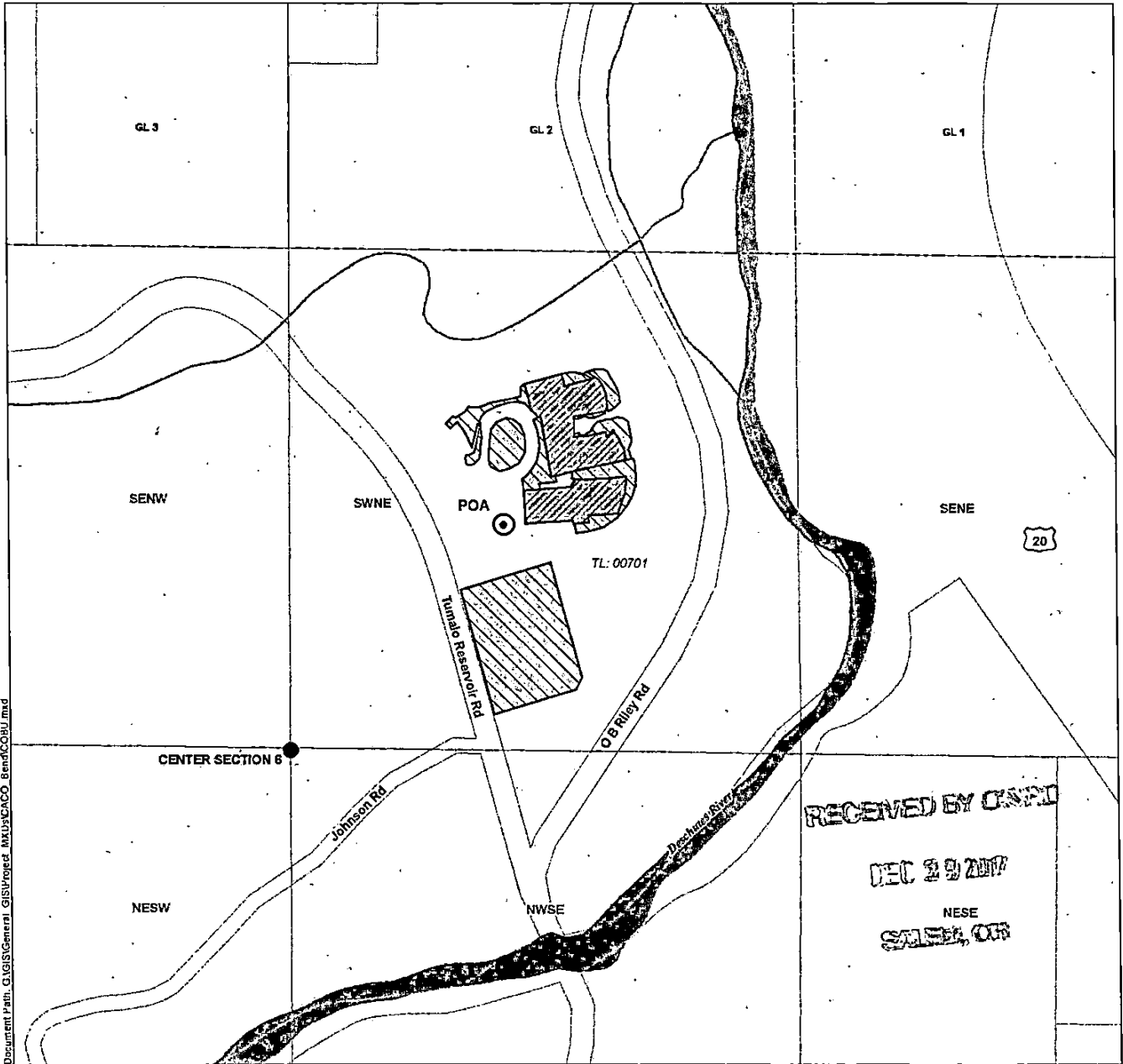

Document Path: G:\GIS\General GIS\Project_MXDs\CACCO_BenefitCOBU.mxd

LEGEND

- | | |
|------------------------------|---------------------|
| Point of Appropriation (POA) | Tax Lot |
| Place of Use (POU) | Government Lot (GL) |
| Commercial | Watercourse |
| Irrigation, 3 acres | Waterbody |

LOCATION-DESCRIPTIONS

Point of Appropriation
Located 595 feet North and 575 feet East from the C1/4 corner of Section 6, Township 16 South, Range 12 East (W.M.)

Water Meter Location
Located 5 feet south of wellhead in a in-ground irrigation box

Certified Water Rights Examiner Stamp

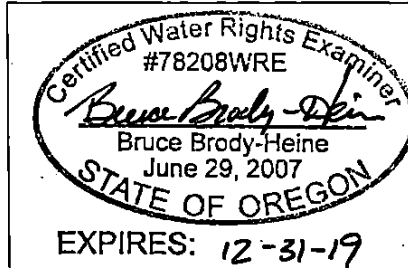

DISCLAIMER
This map was prepared for the purpose of identifying the location of a water right only and it is not intended to provide legal dimensions or location of property ownership lines.

MAP NOTES

Meter location is in a vault 3 feet south of the well.
Date: December 19, 2017
Data Sources: BLM, ESRI, Deschutes Co., USGS

