







**T25S, R30E,
SECTIONS 21,22,27,28, WM**

HARNEY COUNTY, OREGON



0 1,320
Feet

1" = 1,320'

-  POU Irrigation
-  Section
-  Quarter Quarter
-  Tax lot
-  Well & Meter
-  Reservoir
-  Pipeline

WELL & METER LOCATION:
1,486' S, 200' W OF NE COR
SEC 28

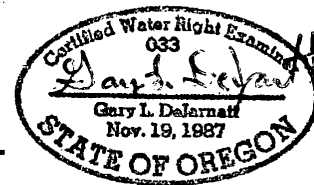

RENEWAL DATE 12/31/2017

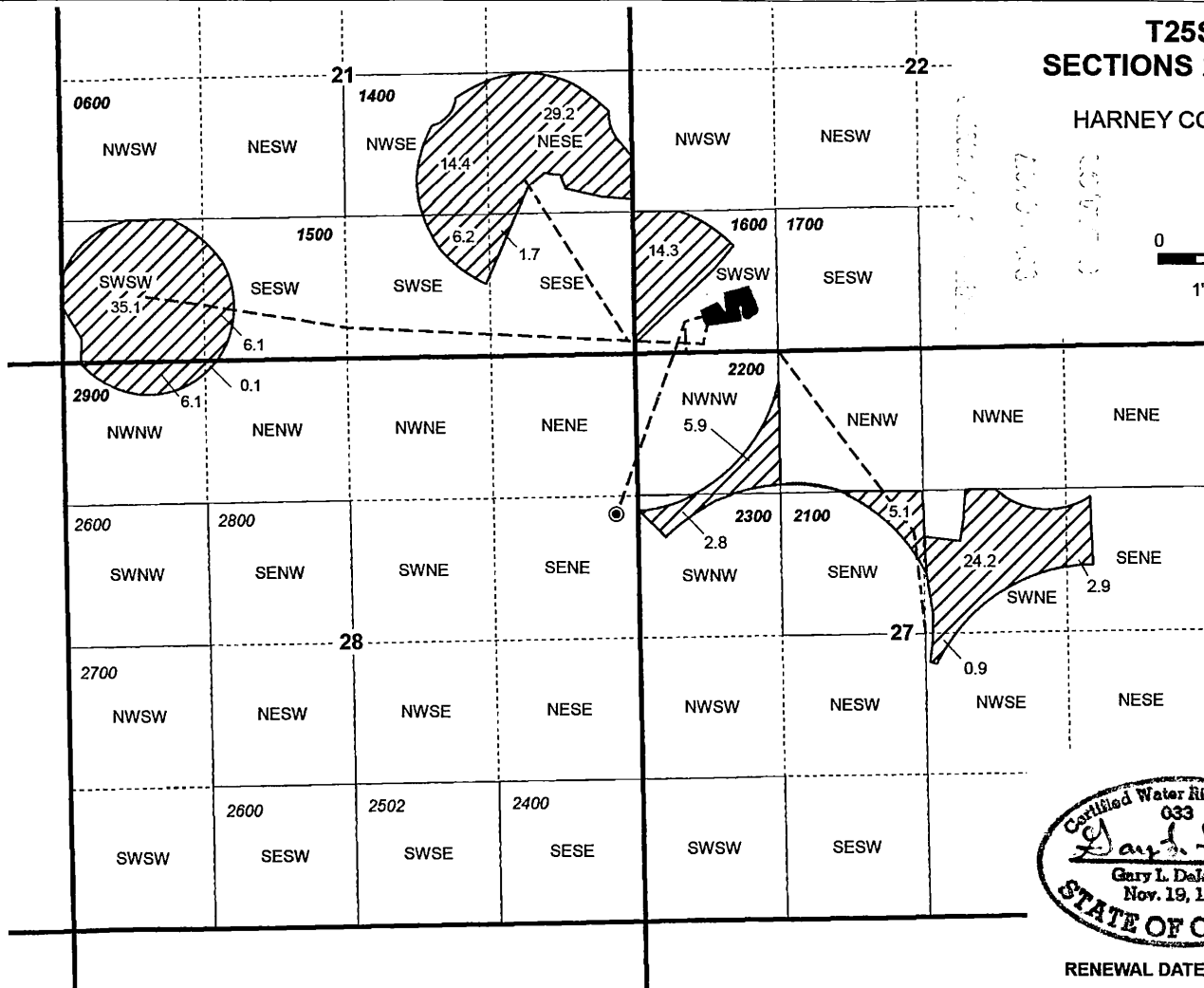

CLAIM OF BENEFICIAL USE
Travis and Kelly Singhose

NOTE: THIS MAP IS NOT INTENDED TO
PROVIDE LEGAL DIMENSIONS OR LOCATIONS
OF PROPERTY OWNERSHIP LINES.

WATER RIGHT SERVICES, LLC

PO BOX 1830, BEND, OR 97709

CCB# 197121 www.oregonwater.us

541-389-2837 JOHNSHORT@USA.COM

APPLICATION G-16670

PERMIT G-16217

JOB # 17051

OCTOBER 10, 2017