

# Historic POD Transfer Map for C-16427

## Map ID: 38S-4W-22 TL 206

### Lands Irrigated 0.5 acres in NWNE

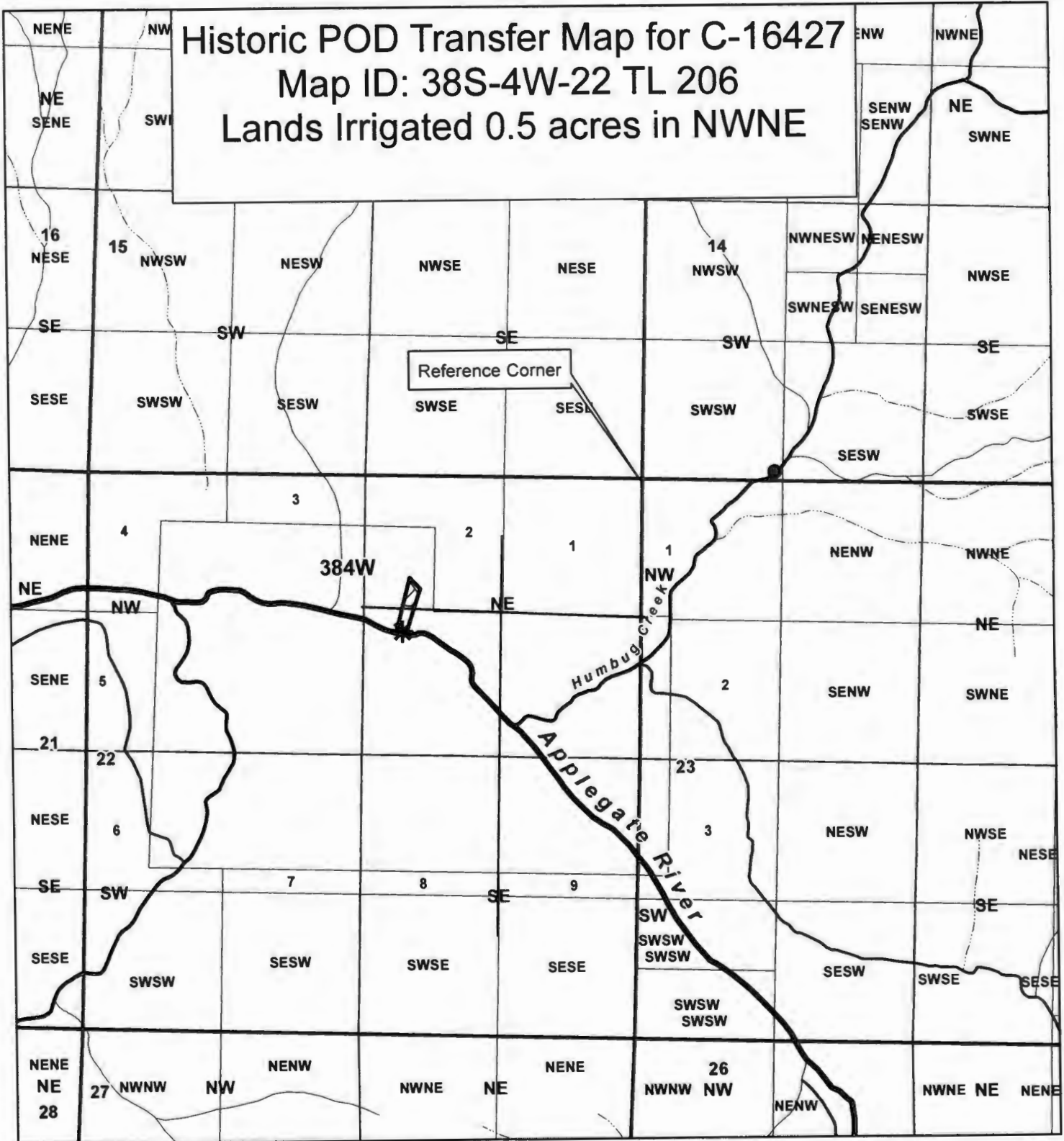

#### Legend

- Benedict Ditch POD
- \* POD #2
- ▨ POU from POD #2
- ▭ TL 206
- ▭ Quarter Sections
- ▭ Quarter Quarter Sections

Benedict Ditch POD (Authorized)  
1320 ft East and 125 ft North  
from SW Corner Section 14

POD #2 Pump  
2295 ft West and 1487 ft South  
from SW Corner Section 14

1 inch = 1,250 feet



RECEIVED BY OWRD JACKSON COUNTY  
**WATERMASTER**

JUN 05 2007 Prepared by Shavon Haynes

SALEM, OR

This map is based on a digital database compiled by Jackson County from a variety of sources. Jackson County cannot accept responsibility for errors, omissions, or positional accuracy. There are no warranties, expressed or implied.

Date: 01-31-17 38-4W-22 T. 2 Q. C-16427.mxd shaynes

T 12683



RECEIVED BY OWRD

JUN 05 2017

SALEM, OR



T 12683

RECEIVED BY OWRD

JUN 05 2017

SALEM, OR



T 12683

RECEIVED BY OWRD

JUN 05 2017

SALEM, OR





T 12683

RECEIVED BY OWRD

JUN 05 2017

SALEM, OR