

G-3547  
3808614

# T.36S.R.12E.W.M.

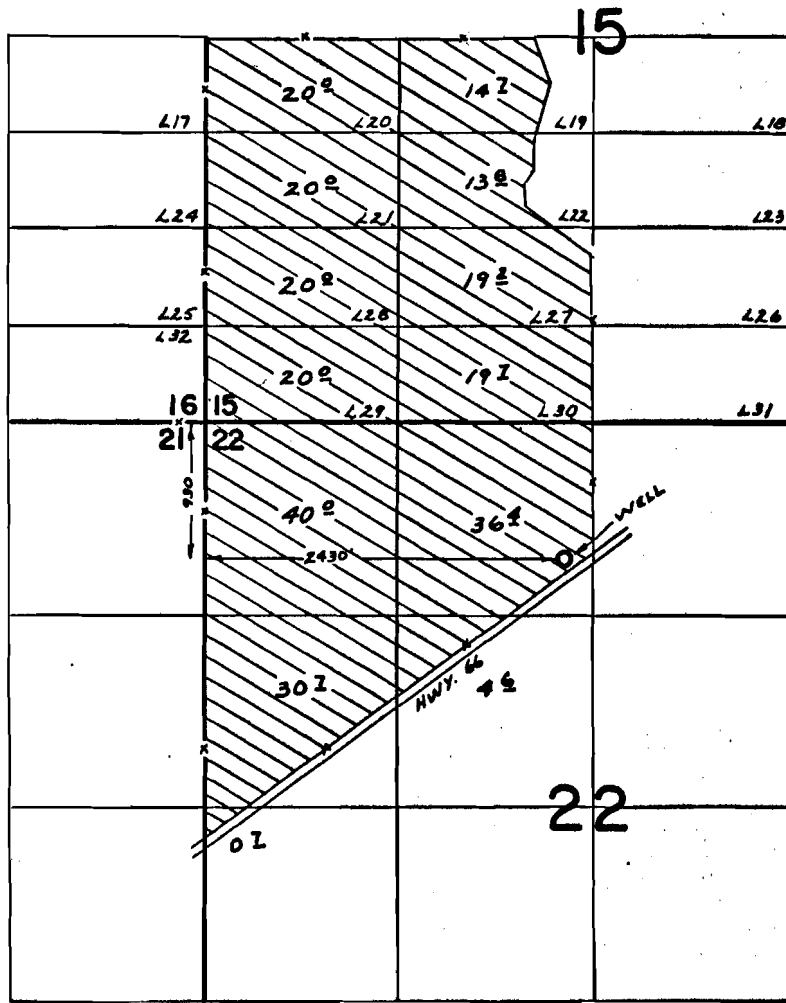

Sprague River Wells

## FINAL PROOF SURVEY UNDER

Application No. G-3758... Permit No. G-3547.  
IN NAME OF

**HOMER & INEZ DeLAMATER**

Surveyed MAY 18, 1970, by R. MUCKEN

# WATER RIGHT TRANSFER

FOR LARRY AND JOAN SEES

IN  
T36S, R12E, WM, SECTIONS 15, 16, 21, & 22  
KLAMATH COUNTY, OREGON  
CERTIFICATES 76361 & 38086

### NOTES

1. THIS MAP WAS PREPARED FROM FIELD MEASUREMENTS, NAD 2011 AERIAL PHOTOGRAPH, KLAMATH COUNTY TAX MAPS 36 12, 36 12 150, 36 12 22, AND OREGON GLO MAPS.
2. THE PURPOSE OF THIS MAP IS TO IDENTIFY THE LOCATION OF THE WATER RIGHT ONLY, AND IS NOT INTENDED TO PROVIDE DIMENSIONS OR LOCATION OF PROPERTY LINES.
3. DATE OF PRIORITY FOR CERTIFICATE 76361 IS APRIL 22, 1983, AND CERTIFICATE 38086 IS DECEMBER 19, 1966.
4. THE TOTAL RATE OF USE FOR CERTIFICATE 76361 IS 2.27 CFS, AND CERTIFICATE 38086 IS 2.33 CFS.

### WELL TIES

- POA - KLAM 485, KLAM 486  
100' SOUTH AND 30' WEST FROM NE CORNER OF SECTION 21. ✓
- APOA - KLAM 2081  
930' SOUTH AND 2430' EAST FROM THE NW CORNER OF SECTION 22. ✓

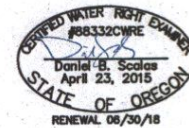

### LEGEND

	SECTION LINE	TL0000	TAX LOT NUMBER
	1/4 1/4 LINE	LOT 1	GOVERNMENT LOT NUMBER
	GOVERNMENT LOT LINE	W	WELL (POA/APOA)
	TAX LOT LINE		ACREAGE UNDER CERTIFICATE 76361 TO REMAIN UNCHANGED
	ROADS & DRIVEWAYS		ACREAGE UNDER CERTIFICATE 38086 TO REMAIN UNCHANGED
	STATE TRAIL		ACREAGE TO BE TRANSFERRED TO APOA
	BELOWGROUND PIPE		ACREAGE UNDER CERTIFICATE 38086 "FROM" LANDS
	ABOVEGROUND PIPE		ACREAGE UNDER CERTIFICATE 76361 "TO" LANDS
	SECTION CORNER		ACREAGE UNDER CERTIFICATE 76361 "FROM" LANDS
	PIVOT CENTER		ACREAGE UNDER CERTIFICATE 38086 "TO" LANDS
	WHEEL LINE		
	ACRES TO REMAIN UNCHANGED		
	GOVERNMENT LOT NUMBER OR 1/4 1/4		
	ACRES TO BE TRANSFERRED		
	1/4 1/4 SECTION		

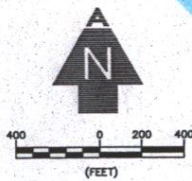

**ADKINS**

CONSULTING ENGINEERING, LLP  
Engineers ▲ Planners ▲ Surveyors  
1435 Esplanade Ave. Klamath Falls, Oregon 97601 • (541) 884-4686 • FAX (541) 884-5335  
Oregon • California

2/14/2018

APOA

3088-02

Revised 3/22/19 JS