

T. 26 S., R. 28 E., W.M.

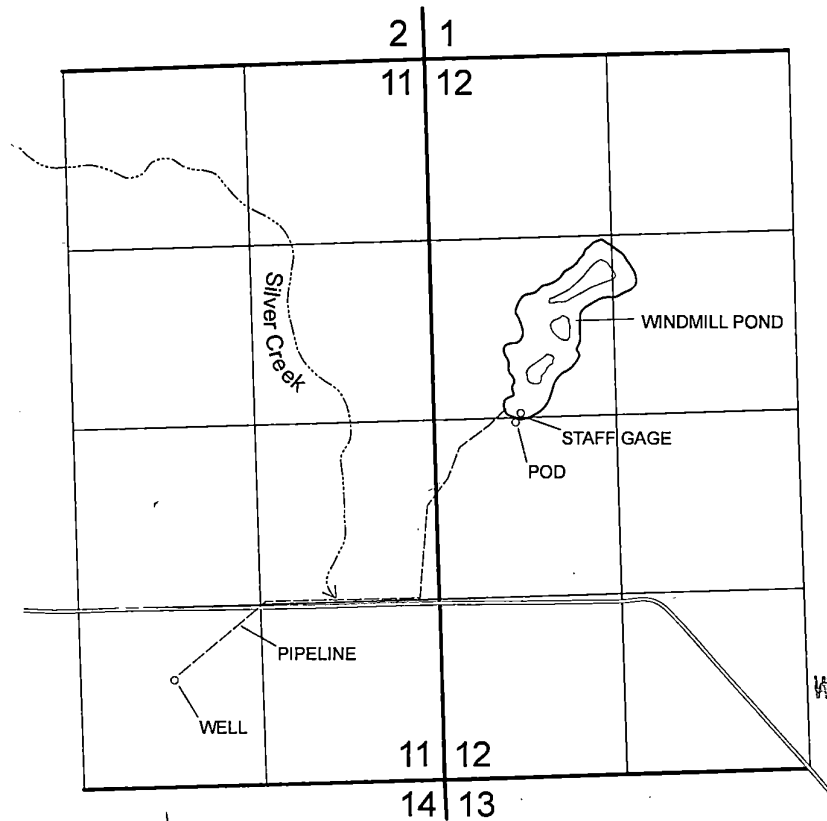

RECEIVED

DEC 05 2008

WATER RESOURCES DEPT
SALEM, OREGON

OREGON STATE PLANE GRID NORTH
(SOUTH ZONE, $\theta = + 0^{\circ} 51' 3.7''$)

1 INCH = 1320 FEET

WELL IS LOCATED 715 FT NORTH AND
1975 FT WEST FROM THE SE CORNER
OF SECTION 11, BEING WITHIN THE
SW $\frac{1}{4}$ SE $\frac{1}{4}$ OF SECTION 11.

POD IS LOCATED 2615 FT NORTH AND
520 FT EAST FROM THE SW CORNER
OF SECTION 12, BEING WITHIN THE
NW $\frac{1}{4}$ SW $\frac{1}{4}$ OF SECTION 12.

FINAL PROOF SURVEY

UNDER

Application No. R-85283 Permit No. R-13693

Application No. G-15833 Permit No. G-15490

IN THE NAME OF

U.S. FISH & WILDLIFE SERVICE
(MALHEUR NWR - WINDMILL POND)



RENEWS: 12/31/2009

This map is not intended to provide
legal dimensions or locations of
property ownership lines.