

T. 14 S., R. 9 E., W. M.

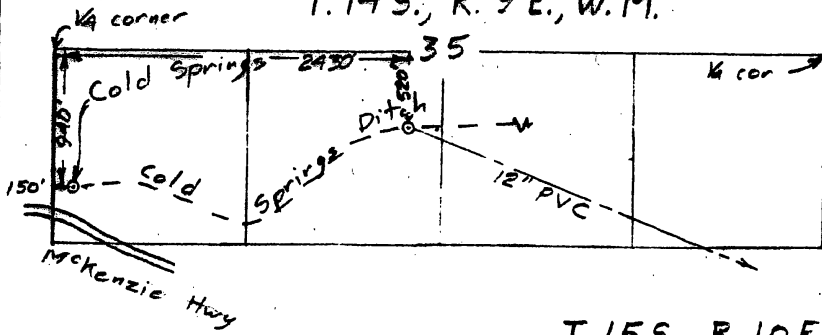

RECEIVED

JUL 02 2004

**WATER RESOURCES DEPT
SALEM, OREGON**

T. 15 S., R. 10 E., W. M.

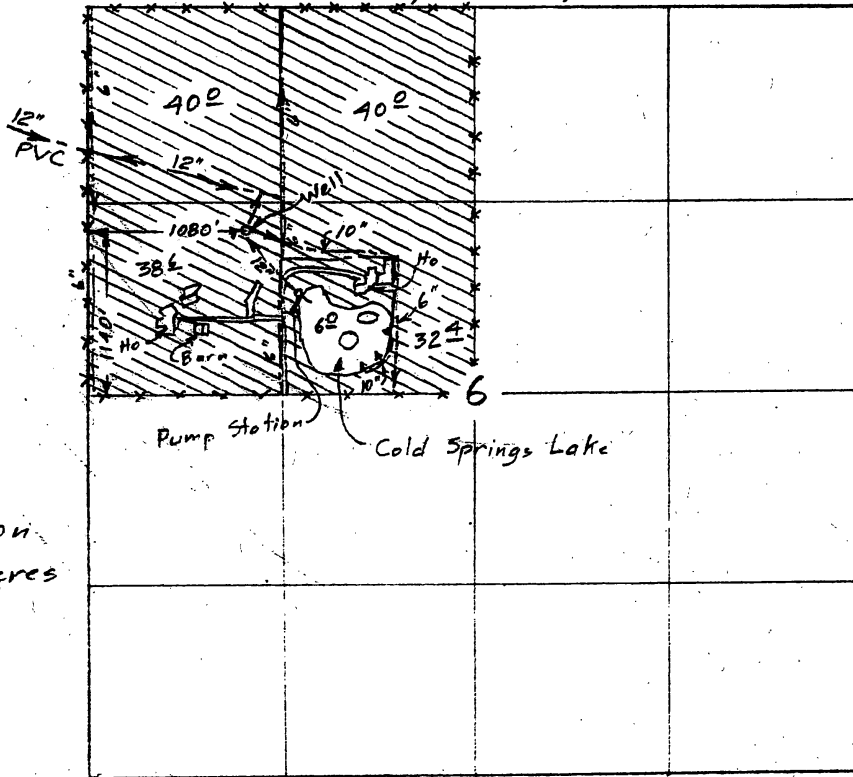

Scale 1" = 1320'

⊗ irrigation
151[±] acres

Surveyed Sep 29, 2002 and June 23, 2004

Claim of Beneficial Use Map
for
Janet Reed William Reed & Myron Reed

Applications	Permits
65516	47945
R-71775	R-11448
71776	51431
G-12621	G-11456

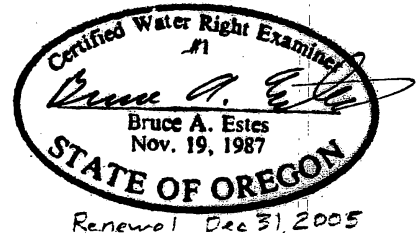

This map is for the purpose of
locating a water right only
and has no intent to provide
legal dimensions or the location
of property lines.

ESTES SURVEYS
 PO Box 17519 60382 Arnold Rd
 Salem, OR 97305-7519 Bend, OR 97702
 (503) 585-7593 (541) 382-7381