

TOWNSHIP 29 SOUTH RANGE 32 EAST WM

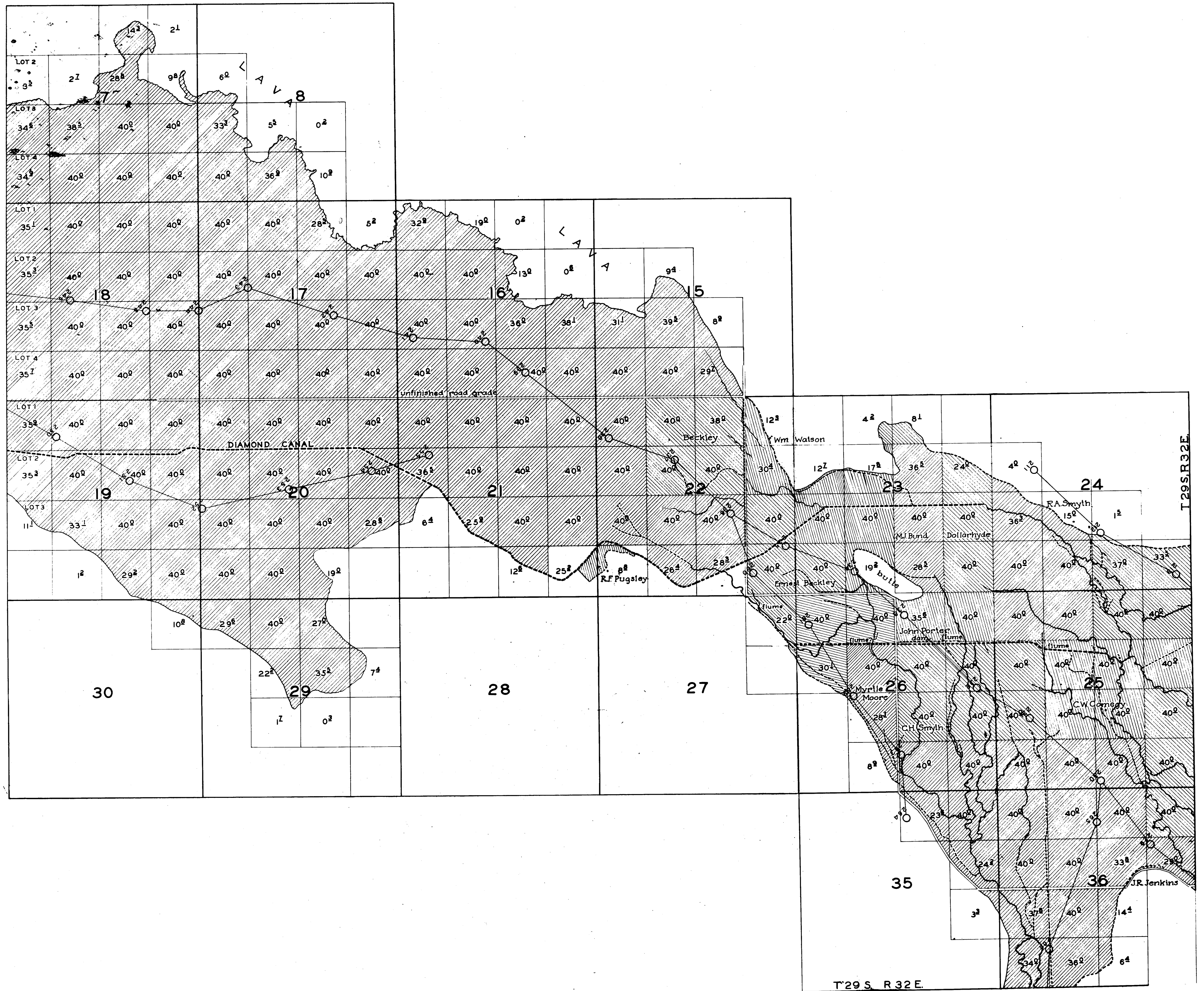



T-8309

RECEIVED  
JUL 28 1999  
WATER RESOURCES DEPT.  
SALEM, OREGON

T. 28 S., R. 32 E.

T. 29 S., R. 32 E.

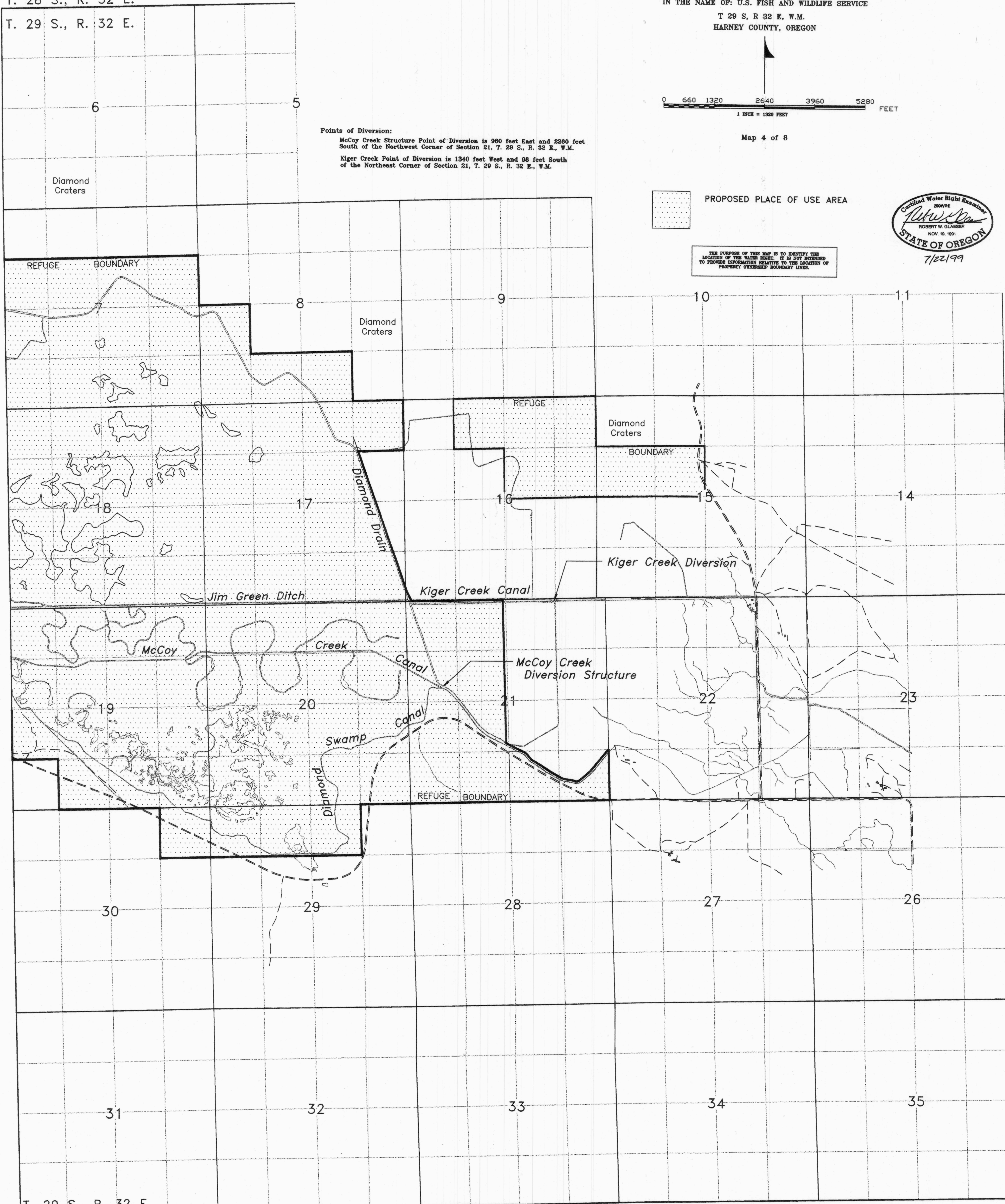

**Points of Diversion:**  
 McCoy Creek Structure Point of Diversion is 960 feet East and 2260 feet South of the Northwest Corner of Section 21, T. 29 S., R. 32 E., W.M.  
 Kiger Creek Point of Diversion is 1340 feet West and 98 feet South of the Northeast Corner of Section 21, T. 29 S., R. 32 E., W.M.

**TRANSFER APPLICATION MAP**  
 PROPOSED PLACE OF USE FOR CERTIFICATE 14367 AND THE PORTIONS OF CERTIFICATES 15197, 15198, AND 28524 WITHIN MALHEUR NATIONAL WILDLIFE REFUGE.  
 IN THE NAME OF: U.S. FISH AND WILDLIFE SERVICE  
 T 29 S, R 32 E, W.M.  
 HARNEY COUNTY, OREGON

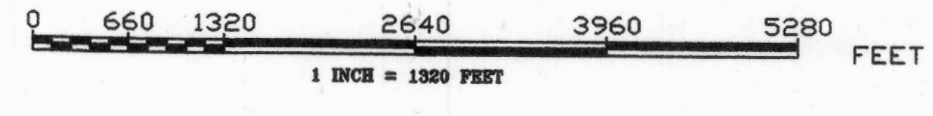

Map 4 of 8

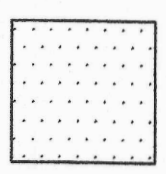
 PROPOSED PLACE OF USE AREA

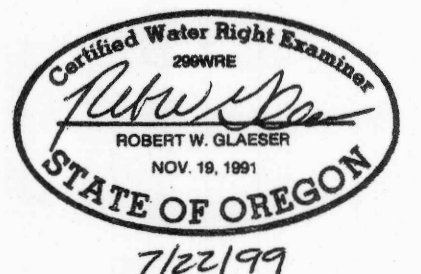

THE PURPOSE OF THIS MAP IS TO IDENTIFY THE LOCATION OF THE WATER RIGHT. IT IS NOT INTENDED TO PROVIDE INFORMATION RELATIVE TO THE LOCATION OF PROPERTY OWNERSHIP BOUNDARY LINES.

7/22/99

T. 29 S., R. 32 E.

T. 30 S., R. 32 E.



RECEIVED

JUL 28 1999

WATER RESOURCES DEPT.  
SALEM, OREGON

T-8309

### TRANSFER APPLICATION MAP

AUTHORIZED PLACE OF USE FOR THE PORTION OF CERTIFICATE  
26524 WITHIN MALHEUR NATIONAL WILDLIFE REFUGE  
IN THE NAME OF: U.S. FISH AND WILDLIFE SERVICE

T 29 S, R 32 E, W.M.  
HARNEY COUNTY, OREGON

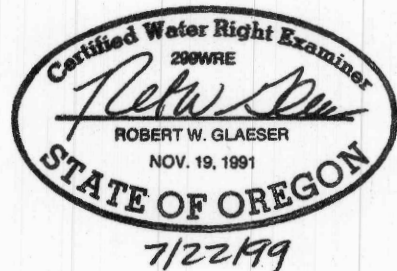

Points of Diversion:  
McCoy Creek Structure Point of Diversion is 960 feet East and 2260 feet South of the Northwest Corner of Section 21, T. 29 S., R. 32 E., W.M.  
Kiger Creek Point of Diversion is 1340 feet West and 98 feet South of the Northeast Corner of Section 21, T. 29 S., R. 32 E., W.M.

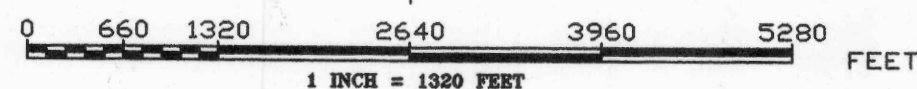

Map 4 of 8

40.0 Actual Irrigated Acres  
(40.0) Certificated Water Right Acres

Acres Proposed for Transfer  
(Lesser of the Actual Irrigated Acres and Certificated Water Right Acres)

THE PURPOSE OF THIS MAP IS TO IDENTIFY THE LOCATION OF THE WATER RIGHT. IT IS NOT INTENDED TO PROVIDE INFORMATION RELATIVE TO THE LOCATION OF PROPERTY OWNERSHIP BOUNDARY LINES.

T. 28 S., R. 32 E.  
T. 29 S., R. 32 E.

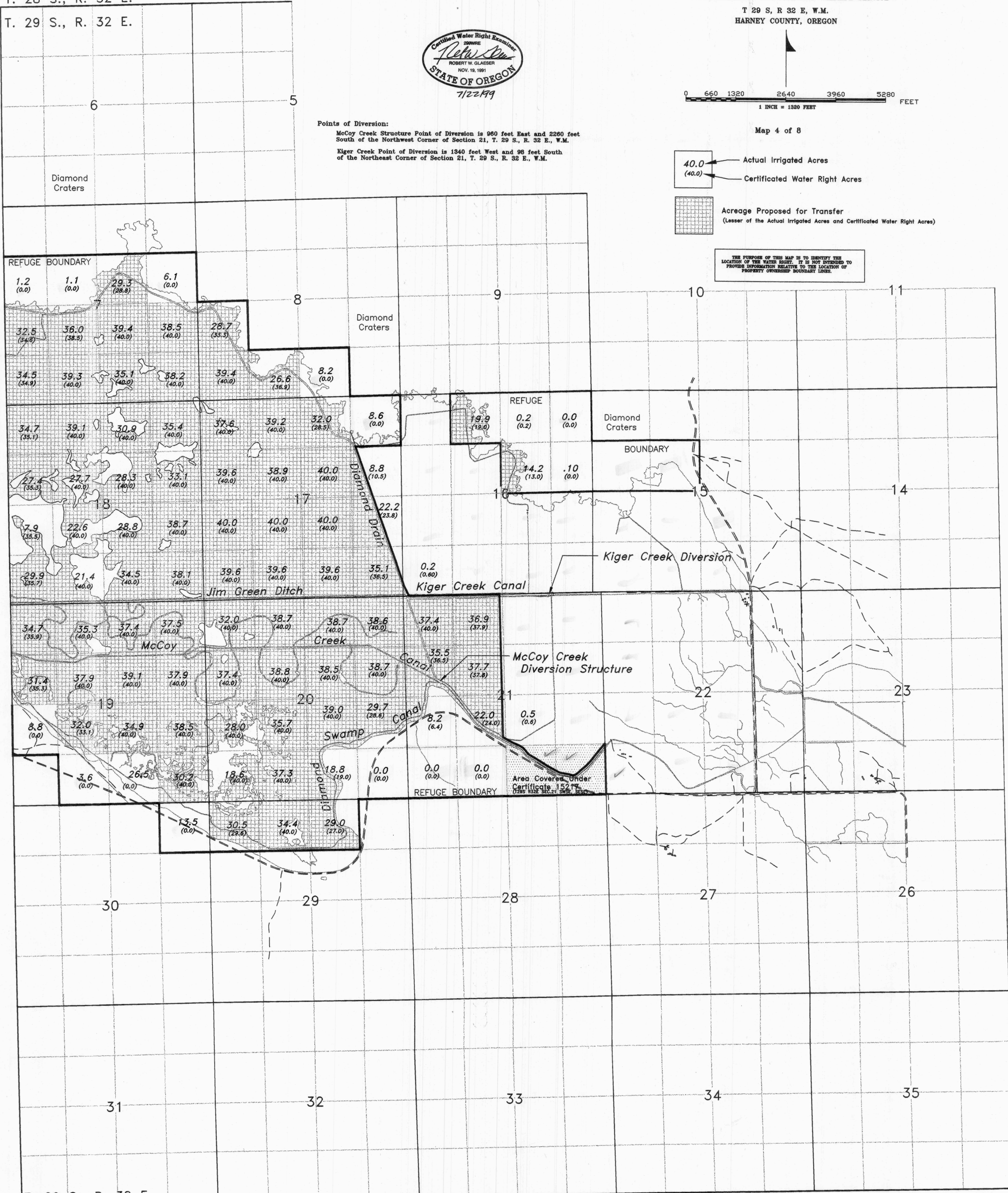

T. 29 S., R. 32 E.  
T. 30 S., R. 32 E.