

T.30S., R.5 W., W.M.

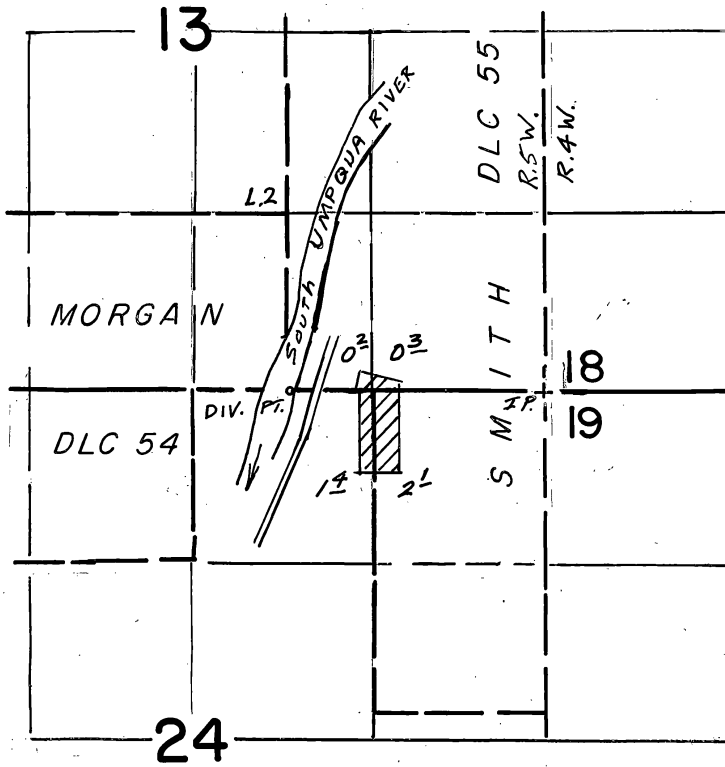

DIV. PT.: 2'S & 1880' W from NE ~~1/4~~ COR. 24 ^{AC/WRD} 6/1/2018

Scale 1"=1320'

FINAL PROOF SURVEY UNDER

Application No. 68752. Permit No. 49826....
IN NAME OF

DAVID M. CHRISTIE

Surveyed JULY 25, 1995, by S. DeHAAS.....