

# T.15S., R.10E., W.M.

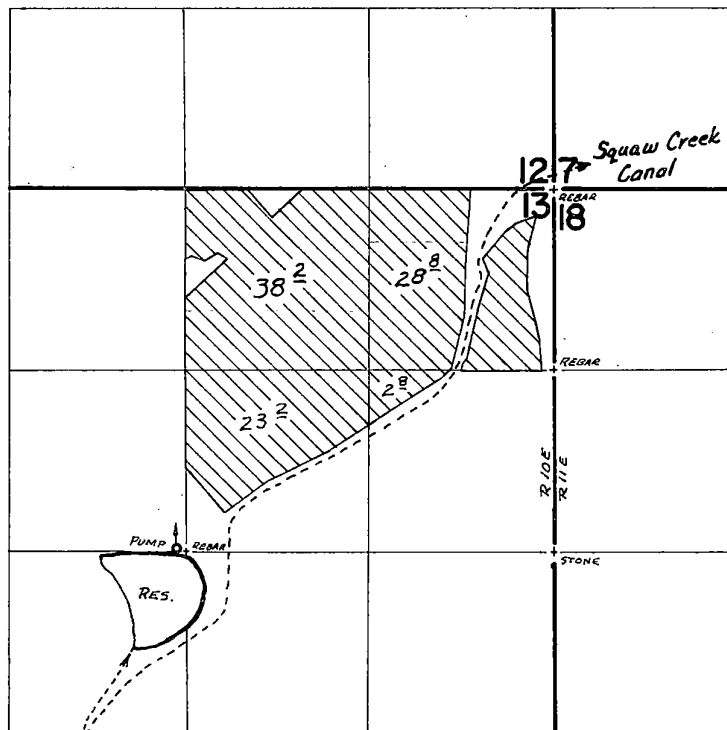

DIV. PTS. LOC: CR - 1000' N & 1320' E FROM SW COR., SEC. 21  
RES. - 20' N & 70' W FROM CENTER SEC 13

## FINAL PROOF SURVEY UNDER

R-43129                      R-4807  
Application No. 43130      Permit No. 31702

IN NAME OF

KEITH CYRUS

Surveyed Oct. 29 1975, by D. Norby