

# T.15S., R.11E., W.M.

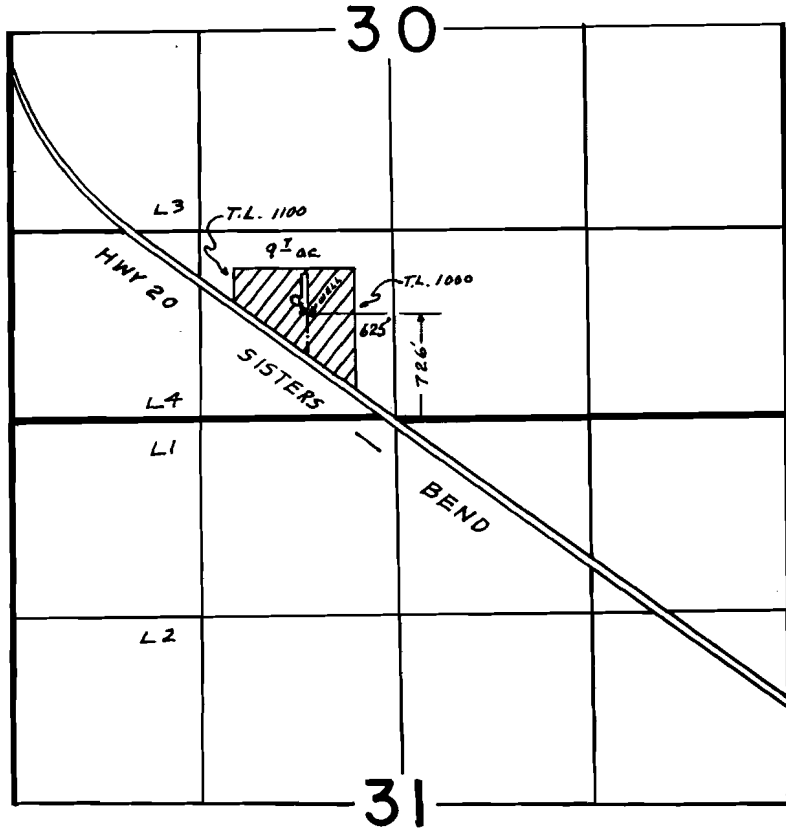

SCALE: 1" = 1320'

## FINAL PROOF SURVEY UNDER

Application No. G-11283. Permit No. G10463  
IN NAME OF

**MORRIS B. McGINNIS**

Surveyed NOV. 9. 1987, by M. J. MATTICK.

Cert. #65972

G-10463

Rec'd 7-12-91 WD# 11

# Application Map

## Additional Point of Appropriation Certificate 65972

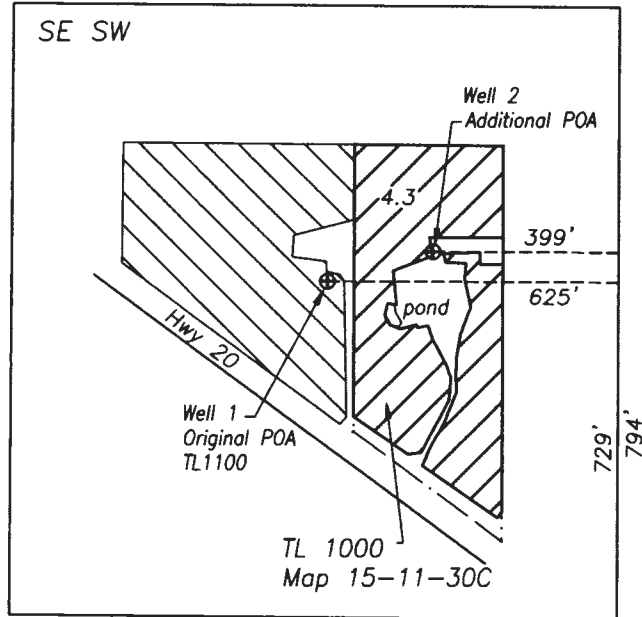

Section 30  
T15S R11E W.M.  
Deschutes Co. OR

S 1/4 Corner  
Sec. 30

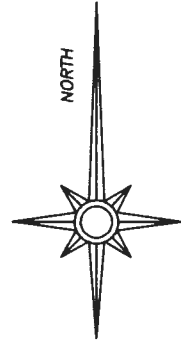

2/28/2017

Michele W. Sims  
 July 14, 2004  
 STATE OF OREGON  
 Renewal date: 6/30/2018

- Legend**
- Portion of Cert. 65972 (priority date 6/21/1984) to transfer on to APOA Well 2
  - Portion of Cert. 65972 (priority date 6/21/1984) to remain
  - Property line

**Points of Appropriation**

Approved: 726 ft North and 625 ft West from the South 1/4 Corner Section 30

Proposed: 794 ft North and 399 ft West from the South 1/4 Corner Section 30

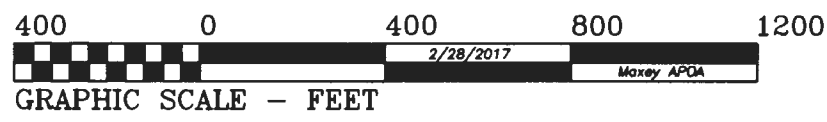

*This map is for the purpose of identifying the location of the water right. It is not intended to provide legal dimensions or locations of property ownership lines.*

**RECEIVED**

MAR 21 2017

OWPRD 1 12615