







APPLICATION NO. R-80595
PERMIT NO. R12303

T1S, R3W, W.M.

- LEGEND:**
-  N 1/4 COR. SEC. 8
 -  SECTION LINES
 -  RESERVOIR OUTLETS, MEASURING DEVICES AND FISH NOTCHES
 -  RESERVOIRS
 -  RESERVOIRS/ENHANCED WETLANDS
 -  TAXLOTS



EXPIRATION DATE: 12/31/15

NOTES:

- APPROXIMATE LOCATION OF RESERVOIR OUTLETS:
- RESERVOIR OUTLET 1: 123°45'7"W, 45°30'24"N
482' N & 358' E OF N 1/4 COR. SEC. 8
 - RESERVOIR OUTLET 2: 123°45'5"W, 45°30'22"N
277' N & 503' E OF N 1/4 COR. SEC. 8
 - RESERVOIR OUTLET 3: 123°45'8"W, 45°30'17"N
282' S & 291' E OF N 1/4 COR. SEC. 8

COPY

DISCLAIMER:

THIS MAP WAS PREPARED FOR THE PURPOSE OF IDENTIFYING THE LOCATION OF A WATER RIGHT ONLY AND IS NOT INTENDED TO PROVIDE LEGAL DIMENSIONS OR LOCATION OF PROPERTY OWNERSHIP LINES.

RESERVOIR OUTLET DETAIL:

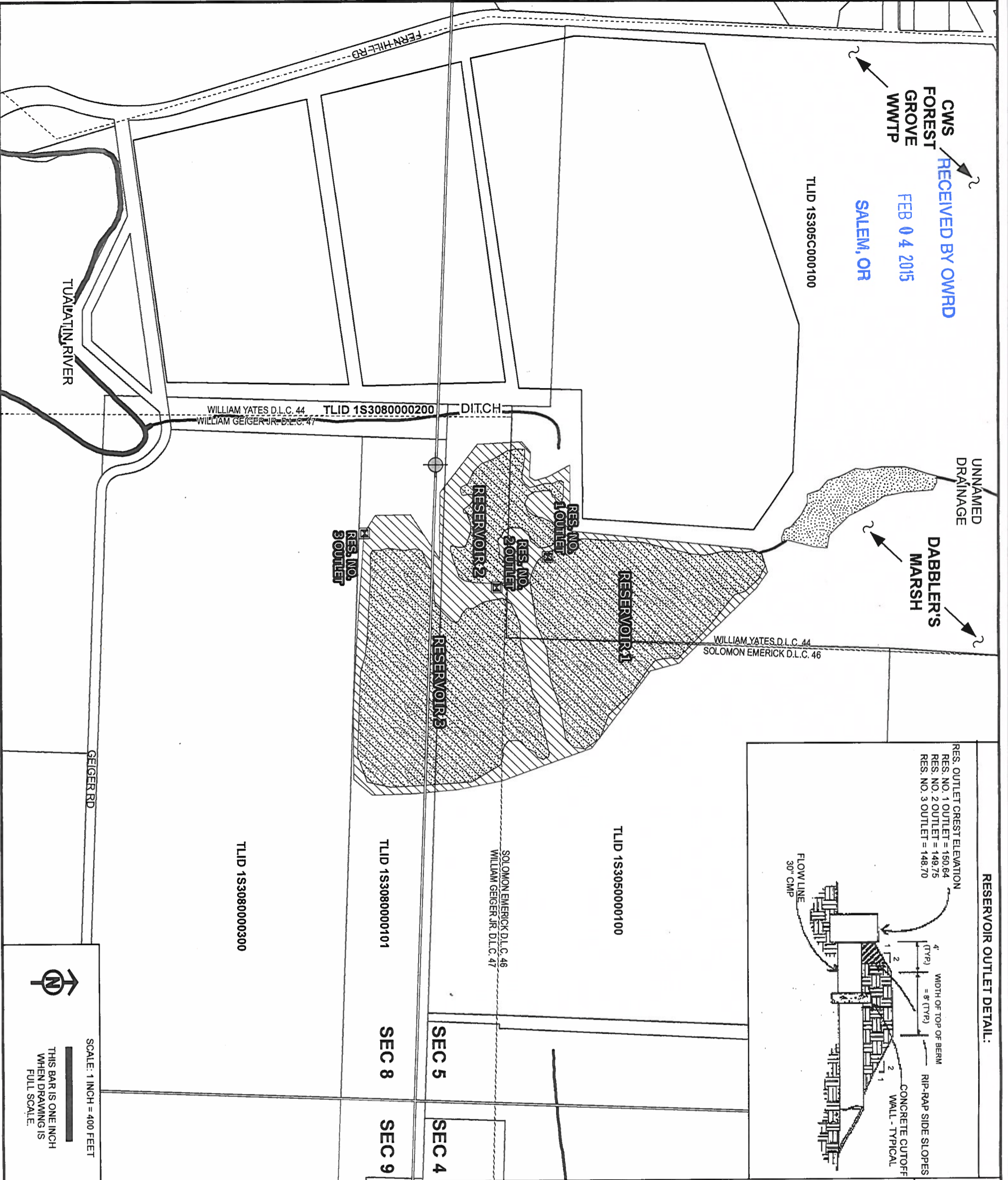
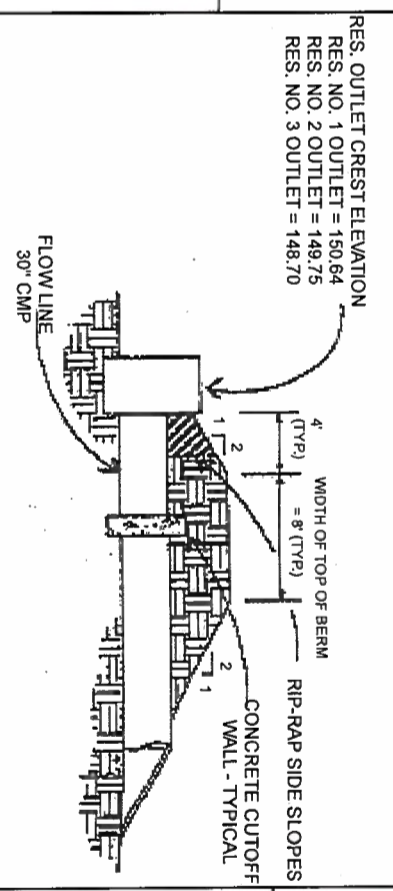

SCALE: 1 INCH = 400 FEET

THIS BAR IS ONE INCH WHEN DRAWING IS FULL SCALE.

