

RECEIVED
 OCT 01 1998
 WATER RESOURCES DEPT.
 SALEM, OREGON

- Legend**
- WELL
 - RESERVOIR
 - △ PUMP STATION

Well No.	Priority Date	Application	Permit	Certificate
1	Nov. 8, 1974	G-6717	G-6352	60020
2-A	June 16, 1989	G-11935	G-10987	
3	June 22, 1988	G-11825	G-10908	
4	April 24, 1989	G-11913	G-10986	
5-	Dec. 28, 1994	G-13929		



AREA OF BENEFICIAL USE INDICATED BY 1/4, 1/4 SECTION

SEE 8 1/2" x 11" MAP FOR WELL LOCATIONS SURVEY

National Bank for Cooperatives

Perrydale Domestic Water Association
 11475 WEST PERRYDALE ROAD AMITY, OREGON 97101

FINAL PROOF SURVEY

WELL No. 3 & WELL No. 4

Scale: 1" = 3000'

Date: SEPTEMBER 15, 1998 Revised

Design

Boatwright Engineering Inc.

Job No.

Drawn JMPB

2613 12th ST. SE. SALEM, OREGON 97302

Sheet

Checked CFB

(503) 363-9225 FAX (503) 363-1051

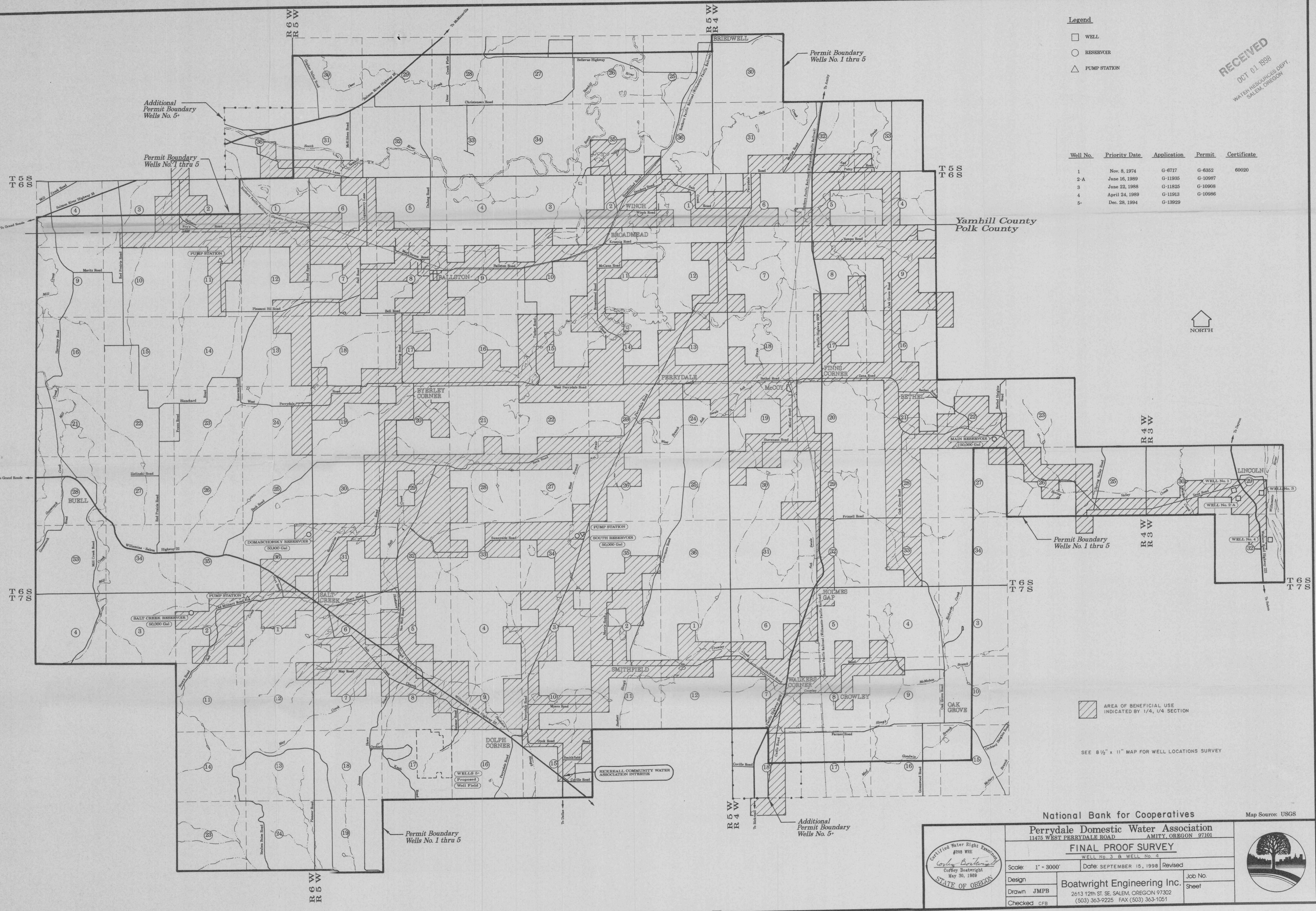
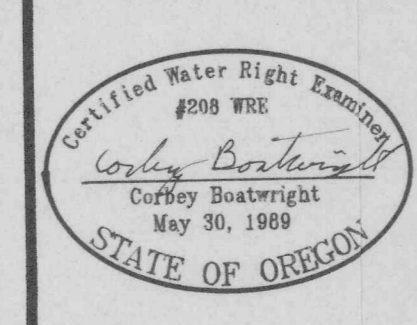

Additional Permit Boundary Wells No. 5-

Permit Boundary Wells No. 1 thru 5

Permit Boundary Wells No. 1 thru 5

Permit Boundary Wells No. 1 thru 5

Permit Boundary Wells No. 1 thru 5

Additional Permit Boundary Wells No. 5-

WELLS 5-
 (Proposed Well Field)

RECREALL COMMUNITY WATER ASSOCIATION INTEREST