

T24S, R29E,  
SECTION 2, WM

HARNEY COUNTY, OREGON

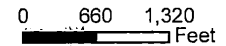

1 inch = 1,320 feet



- Meter
- Well
- POU IR
- Section
- Quarter Quarter

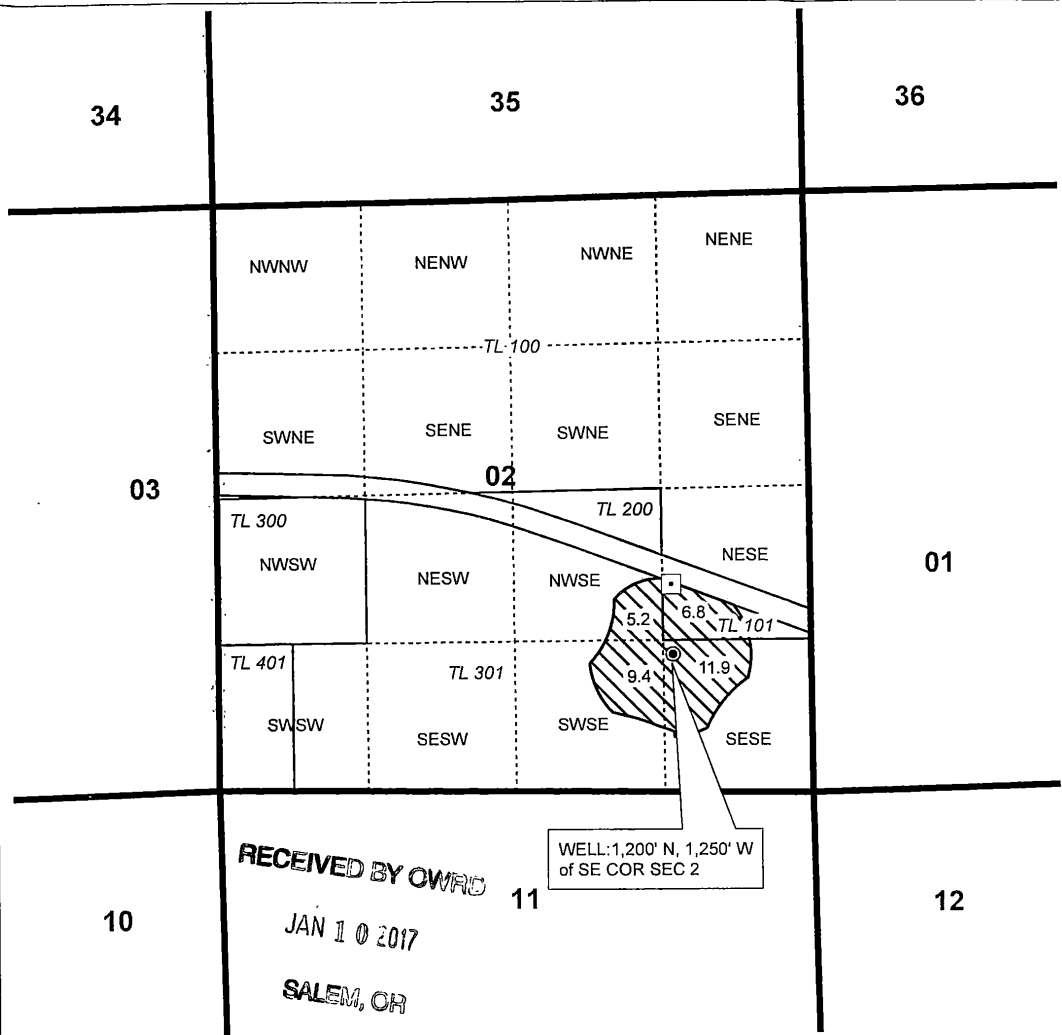

WELL: 1,200' N, 1,250' W  
of SE COR SEC 2

RECEIVED BY OWRD  
JAN 10 2017  
SALEM, OR

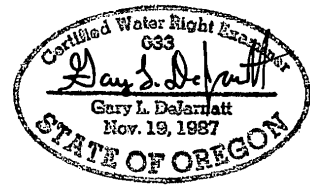

RENEWAL DATE 12/31/2017



**Claim of Beneficial Use Map**  
John and Carolyn Bauer  
Application Number: G-16861  
Permit G-16432

Date: 1/3/17

NOTE: THIS MAP IS NOT INTENDED TO  
PROVIDE LEGAL DIMENSIONS OR LOCATIONS  
OF PROPERTY OWNERSHIP LINES.

Job # 16067

**WATER RIGHT SERVICES, LLC**  
PO BOX 1830, BEND, OR 97709  
CCB# 197121 www.oregonwater.us  
541-389-2837 JOHNSHORT@USA.COM