

T. 17S., R. 19E.,
W.M.

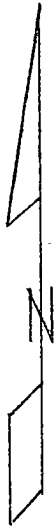

Scale 1" = 1320'
(4" = 1 mile)

T-11209

Claim of
Beneficial Use
Map for
Shotgun Ranch, LLC

Surveyed Sep 11, 2014

This map identifies the new POU
WRD/mfb 10-9-18

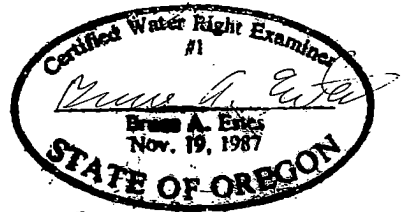

Renewal Dec 31, 2015

- ⊗ C-524 1890
9³ primary
- ⊗ C-524 1890
20² primary
- ⊗ C-31943 1949
31⁶ primary
- ⊗ C-31943 1949
20² supplemental
- C-87114 1949
4² primary

This map is for the purpose of
locating a water right only
and has no intent to provide
legal dimensions or the location
of property lines.

ESTES SURVEYS, LLC
 PO Box 17546 60382 Arnold Rd
 Salem, OR 97306-7519 Bend, OR 97702
 (503) 566-7599 (541) 382-7391

POD #1 1290' S E 260' E
from N 1/4 cor

POD 1A N 2500' S E 540' E
from N 1/4 cor

Pine Creek Reservoir

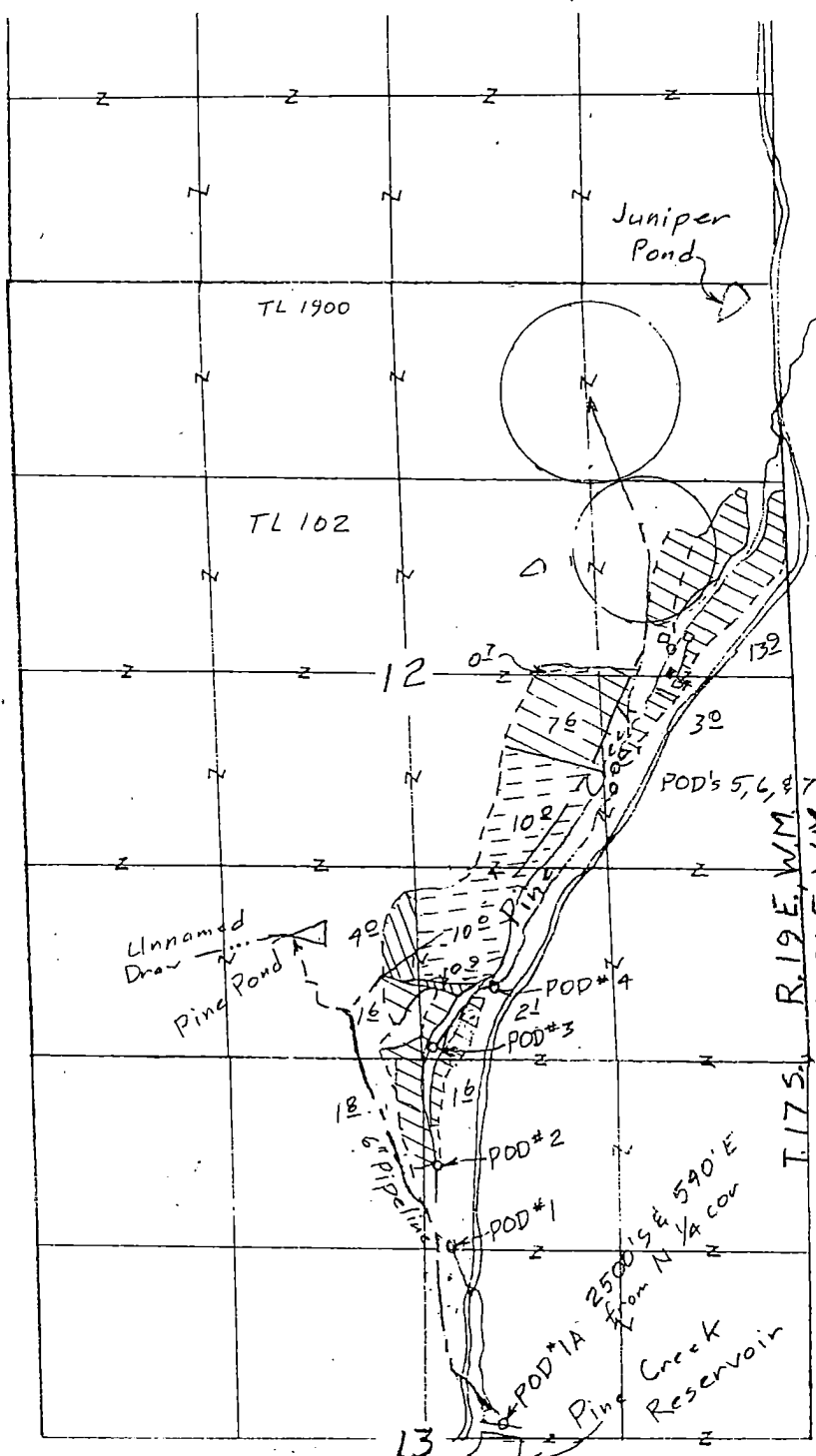

Scale 1" = 1320'
(4" = 1 mile)

- From C-31943 (1949)
- ⊗ Primary 316
 - ⊕ Supplemental 202
 - Remain
 - ⊗ Primary 42

RECEIVED

MAR 11 2011

WATER RESOURCES DEPT
SALEM, OREGON

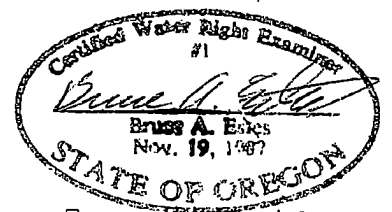

Renewal Dec 31, 2011
Sheet 2 of 3

T 11209

Transfer App. Map
for
Rance Kastor

This map is for the purpose of locating a water right only and has no intent to provide legal dimensions or the location of property lines.

This map identifies the PODs WRD/mfb 10-9-18

ESTES SURVEYS, LLC
 PO Box 17519 60352 Arnold Rd
 Salem, OR 97305-7519 Bend, OR 97702
 (503) 566-7593 (541) 382-7391