

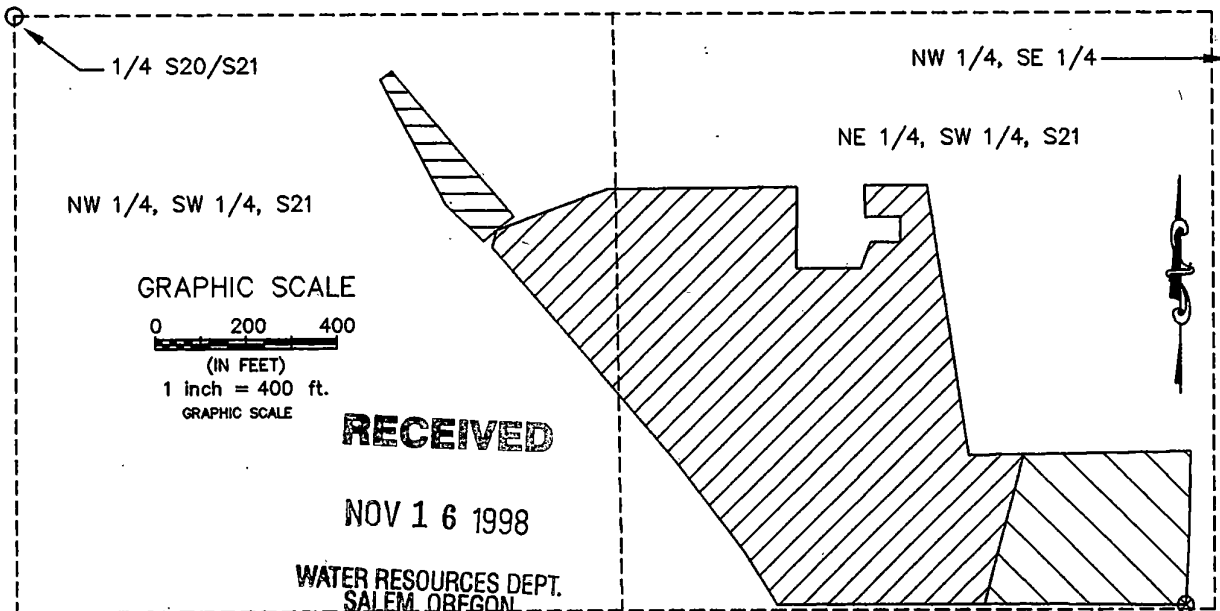



# FINAL PROOF SURVEY AND CLAIM OF BENEFICIAL USE

LOCATED IN  
NW 1/4, SW 1/4, & NE 1/4, SW 1/4, SECTION 21, T.2N., R.32E., W.M.  
UMATILLA COUNTY, OREGON  
ALTON OLSON

TRANSFER APPLICATION T-7168 MODIFYING A PORTION OF CERTIFICATE 72441, DECREE VOLUME 3, PAGE 127, AND ALSO MODIFYING A PORTION OF CERTIFICATE 53298, PERMIT 14294, THROUGH SPECIAL ORDER VOLUME 52, PAGE 294, APPROVING CHANGE IN PLACE OF USE AND POINT OF DIVERSION.

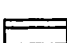

### LEGEND

-  AREA UNDER IRRIGATION - ALFALFA  
NE 1/4, SW 1/4 = 13.69 ACRES  
NW 1/4, SW 1/4 = 1.44 ACRES
-  AREA UNDER IRRIGATION - PASTURE  
AND STOCKWATER  
NE 1/4, SW 1/4 = 3.13 ACRES
-  AREA NOT IRRIGATED THIS SEASON  
LAST IRRIGATED IN 1995  
NW 1/4, SW 1/4 = 0.69 ACRES
-  NEW POINT OF DIVERSION
-  1/16th SECTION LINE

LOCATION OF NEW  
POINT OF DIVERSION  
WITHIN NE 1/4, SW 1/4,  
SECTION 21, T.2N., R.32E.,  
1,310' SOUTH AND 2,577'  
EAST OF 1/4 S20/S21.

This map is prepared for the express purpose to show water appropriation and use. It is not intended to show or locate property ownership lines.

©

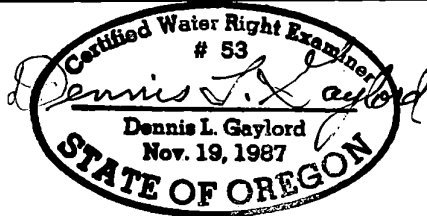

*Renews 6/30/99*

DENNIS L. GAYLORD, CWRE  
71614 S.W. LAKE DRIVE  
PENDLETON, OR 97801  
(541) 276-6260  
August 22, 1998

DRAWN BY: H B WILLIAMS DRAFTING