

FINAL PROOF SURVEY AND CLAIM OF BENEFICIAL USE

LOCATED IN
NW 1/4, SW 1/4, & NE 1/4, SW 1/4, SECTION 21, T.2N., R.32E., W.M.
UMATILLA COUNTY, OREGON
ALTON OLSON

TRANSFER APPLICATION T-7168 MODIFYING A PORTION OF CERTIFICATE 72441, DECREE VOLUME 3, PAGE 127, AND ALSO MODIFYING A PORTION OF CERTIFICATE 53298, PERMIT 14294, THROUGH SPECIAL ORDER VOLUME 52, PAGE 294, APPROVING CHANGE IN PLACE OF USE AND POINT OF DIVERSION.

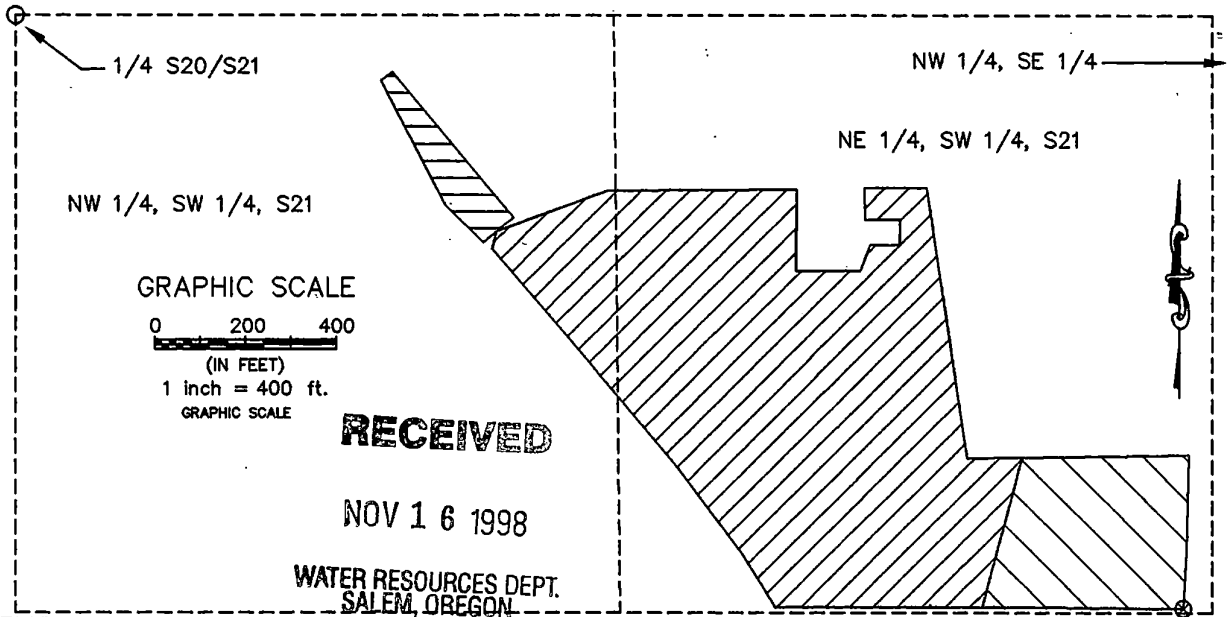

LEGEND

- AREA UNDER IRRIGATION - ALFALFA
NE 1/4, SW 1/4 = 13.69 ACRES
NW 1/4, SW 1/4 = 1.44 ACRES
- AREA UNDER IRRIGATION - PASTURE
AND STOCKWATER
NE 1/4, SW 1/4 = 3.13 ACRES
- AREA NOT IRRIGATED THIS SEASON
LAST IRRIGATED IN 1995
NW 1/4, SW 1/4 = 0.69 ACRES
- NEW POINT OF DIVERSION
- 1/16th SECTION LINE

NEW POINT OF DIVERSION
(P.O.D. 3)

LOCATION OF NEW
POINT OF DIVERSION
WITHIN NE 1/4, SW 1/4,
SECTION 21, T.2N., R.32E.,
1,310' SOUTH AND 2,577'
EAST OF 1/4 S20/S21.

This map is prepared for the express purpose to show water appropriation and use. It is not intended to show or locate property ownership lines.

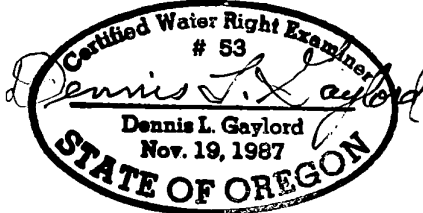

DENNIS L. GAYLORD, CWRE
71614 S.W. LAKE DRIVE
PENDLETON, OR 97801
(541) 276-6260
August 22, 1998

Renews 6/30/99

DRAWN BY: H B WILLIAMS DRAFTING