

RECEIVED

JUL 30 2018

OWRD

FINAL PROOF MAP  
 PERMIT S-54847 - APPLICATION S-87876  
 SE1/4SW1/4 SECTION 5, T.37S., R.6W., W.M.  
 JOSEPHINE COUNTY, OREGON  
 FOR  
 KENNETH CASTLE  
 1543 SLEEPY HOLLOW LOOP  
 GRANTS PASS, OREGON 97527

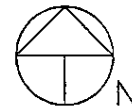

T.37S., R.6W

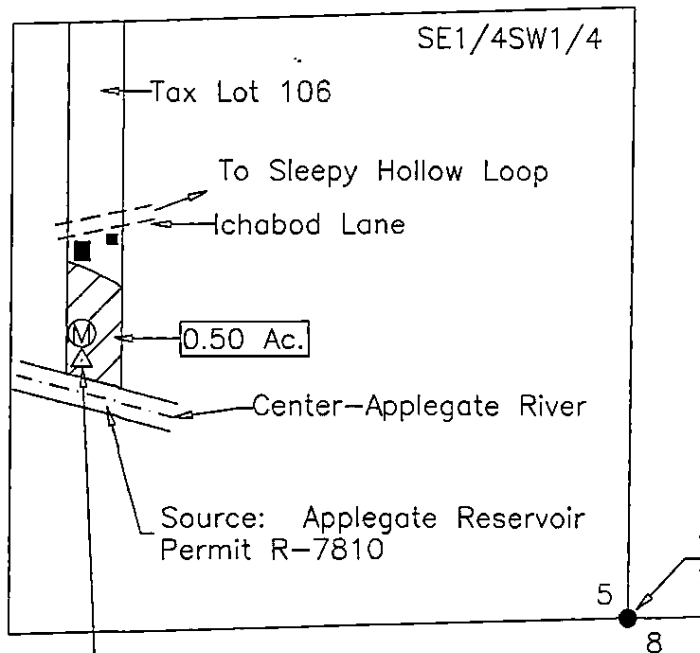

Scale: 1"=400'  
 Date: April 30, 2015  
 REVISED: July 27, 2018

LEGEND

- Found Survey Monument
- Denotes Building
- ▨ Denotes Area Under Permit S-54847, 3/6/2013 Priority Date
- Ⓜ Denotes Flow Meter
- △ Denotes Point of Diversion

Point of Diversion No. 1  
 595' North and 1182' West  
 From South 1/4 Corner  
 Section 5. Fish Screen  
 at Point of Diversion.



Renews: 12/31/19

This map was prepared for the purpose of identifying the location of a water right only and is not intended to provide legal dimensions or location of property ownership.

HAROLD L. CENTER  
 2604 David Lane  
 Medford, OR. 97504  
 Phone 541-535-6108  
 Oregon Certificate No. 152