

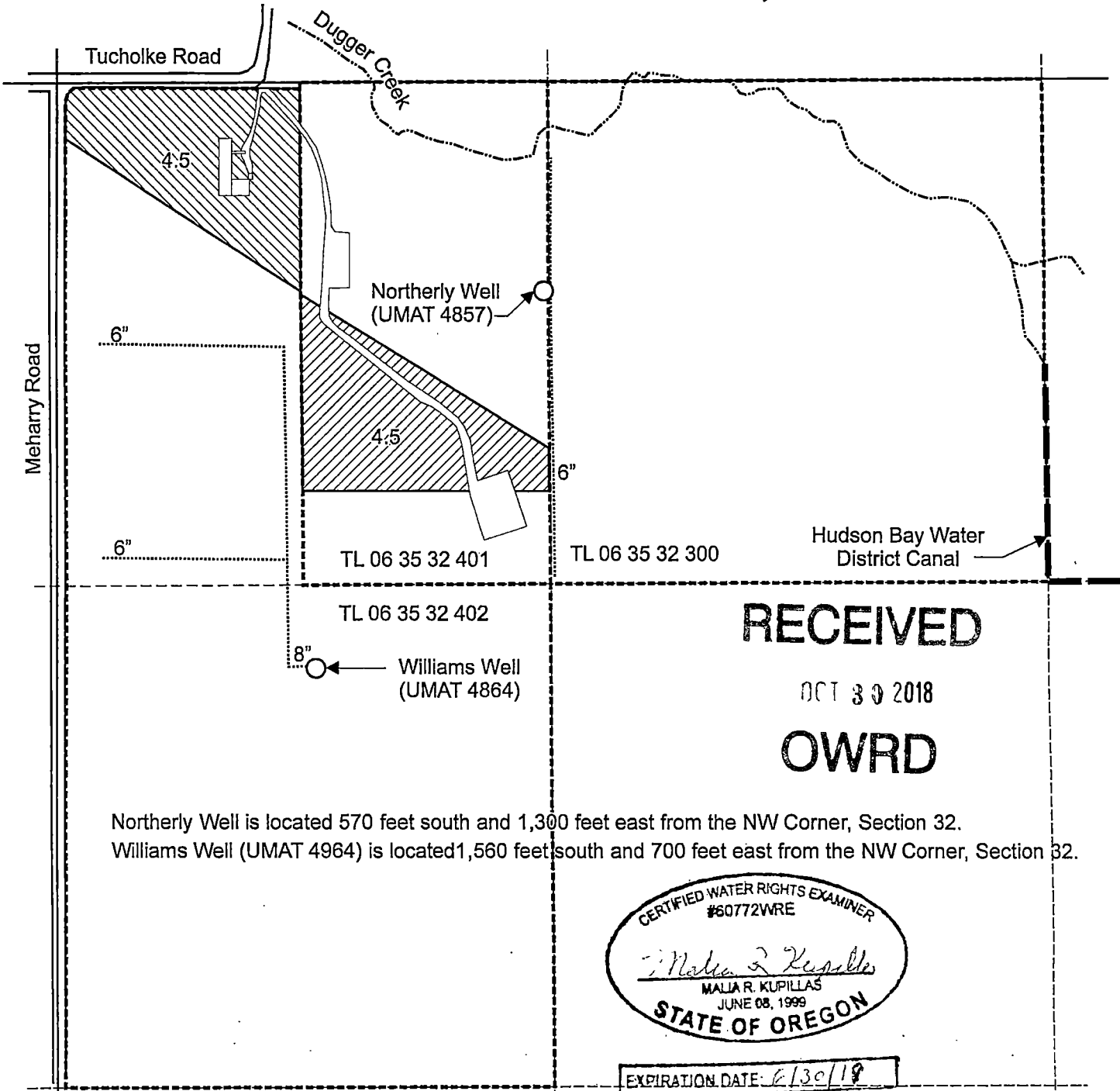

T.6N. R.35E. Section 32, W.M.

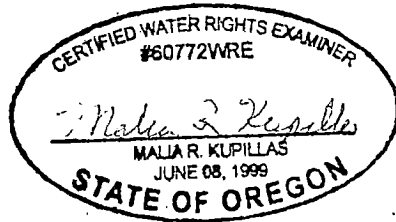

Northerly Well is located 570 feet south and 1,300 feet east from the NW Corner, Section 32.
 Williams Well (UMAT 4964) is located 1,560 feet south and 700 feet east from the NW Corner, Section 32.



EXPIRATION DATE: 6/30/19

 Area (4.5 acres primary) using Williams Well (UMAT 4964), Supplemental Permit 43973.

 Area (4.5 acres supplemental) irrigated under primary Dugger Creek Decree, Certificate 2-1705 and Supplemental G-397, and Permit 43973 using Northerly Well (UMAT 4857)

Scale: 1" = 400'

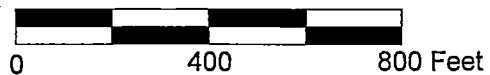

This map was prepared for the purpose of identifying the location of a water right only and is not intended to provide legal dimensions or location of property ownership lines.

- Mainline
- Tax lot boundary

Pacific Hydro-Geology Inc.

10/2018-mrk

Claim of Beneficial Use Map 3 of 4
 Transfer T-8303 (Certificate 65773)

Brown and Crouthamel
 T.6N. R.35E. Section 32, W.M.