

# T.6S. R.1W. Sec. 31 & 32, W.M.

RECEIVED

MAR 23 2018

OWRD

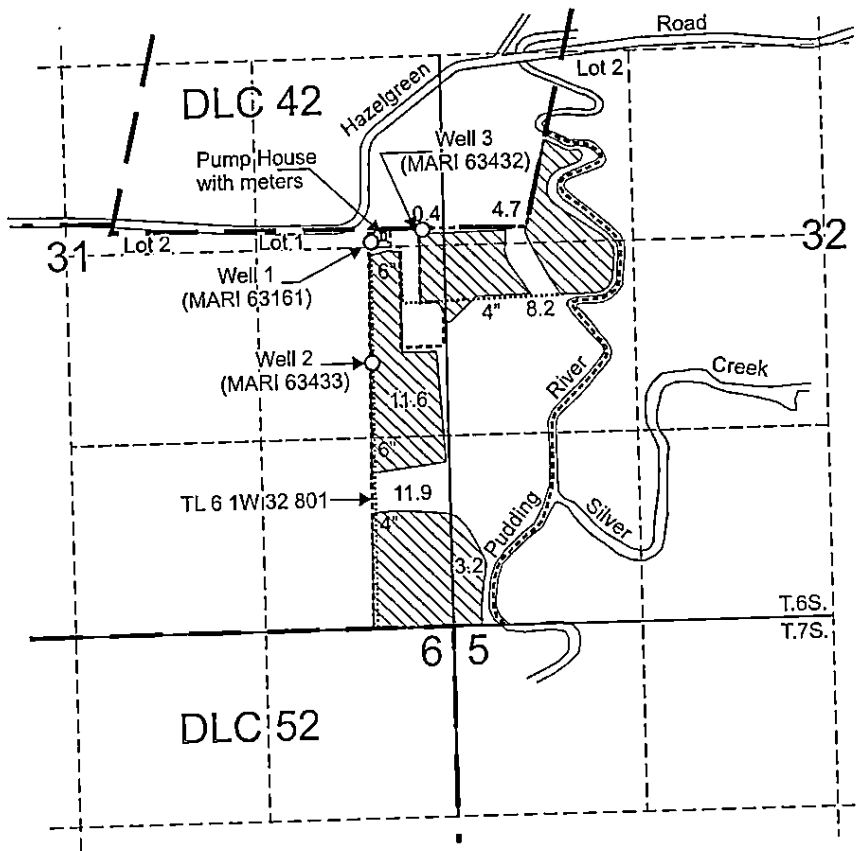

Well 1 (MARI 63161) is located 40 feet north and 510 feet west from the E 1/4 corner, Section 31.  
 Well 2 (MARI 63433) is located 800 feet south and 520 feet west from the E 1/4 corner, Section 31.  
 Well 3 (MARI 63432) is located 110 feet north and 150 feet west from the E 1/4 corner, Section 31.

Area (40.0 Acres) irrigated under T-10999.

Tax lot boundary

Donation Land Claim boundary

Water main line

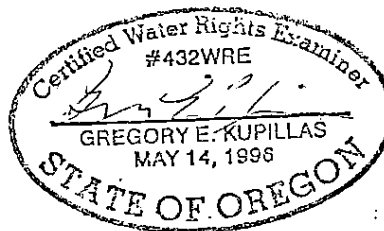

EXPIRATION DATE: 6/30/2019

Scale: 1" = 1,320'

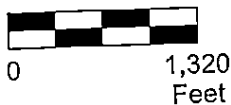

This map was prepared for the purpose of identifying the location of a water right only and is not intended to provide legal dimensions or location of property ownership lines.



Pacific Hydro-Geology Inc.

01/2018

Claim of Beneficial use Map  
T-10999

Steven V. and Constance A. Johnson  
T.6S. R.1W. Sec. 31 & 32, W.M.

Johnson-T-10999COBUMap.cdr