

FINAL PROOF MAP

TO ADD A POINT OF APPROPRIATION
AND PLACE OF USE FOR APPLICATION G-16819
WILLIAM AND JANE JONES

TOWNSHIP 23 SOUTH, RANGE 32 EAST, SECTION 15, W.M.
TAX LOT: 600

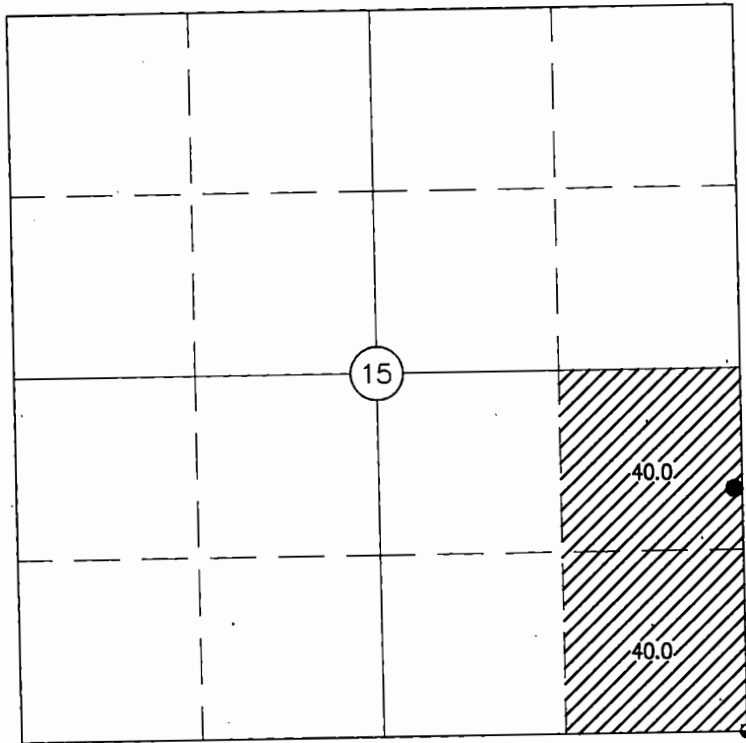

RECEIVED BY OWRD

AUG 14 2014

SALEM, OR



RENEWAL DATE: 12/31/2014

WELL (HARN 51542)

- LOCATED IN THE NE 1/4 SE 1/4 SECTION 15, T23S R32E, W.M. AND 1765 FEET NORTH AND 95 FEET WEST FROM THE SE CORNER OF SAID SECTION.
FLOW METER IS LOCATED 6.75' WEST FROM WELL.



80.0 ACRES PRIMARY RIGHTS FROM WELL
(G-16330), AS SHOWN.

THIS MAP IS FOR THE PURPOSE OF LOCATING A WATER RIGHT ONLY AND HAS NO INTENT TO PROVIDE LEGAL DIMENSIONS OR THE LOCATION OF PROPERTY LINES.

PREPARED FOR:

WILLIAM & JANE JONES
38420 PALOMINA LANE
BURNS, OR 97720

PREPARED BY:



ALL POINTS ENGINEERING AND SURVEYING, INC.
P.O. BOX 767 (CRR) TERREBONNE, OR 97760
(541) 548-5833
www.APEandS.com