

T23S, R26E, SECTIONS 11 & 12, WM

HARNEY COUNTY, OREGON



0 1,320 Feet

1" = 1,320'

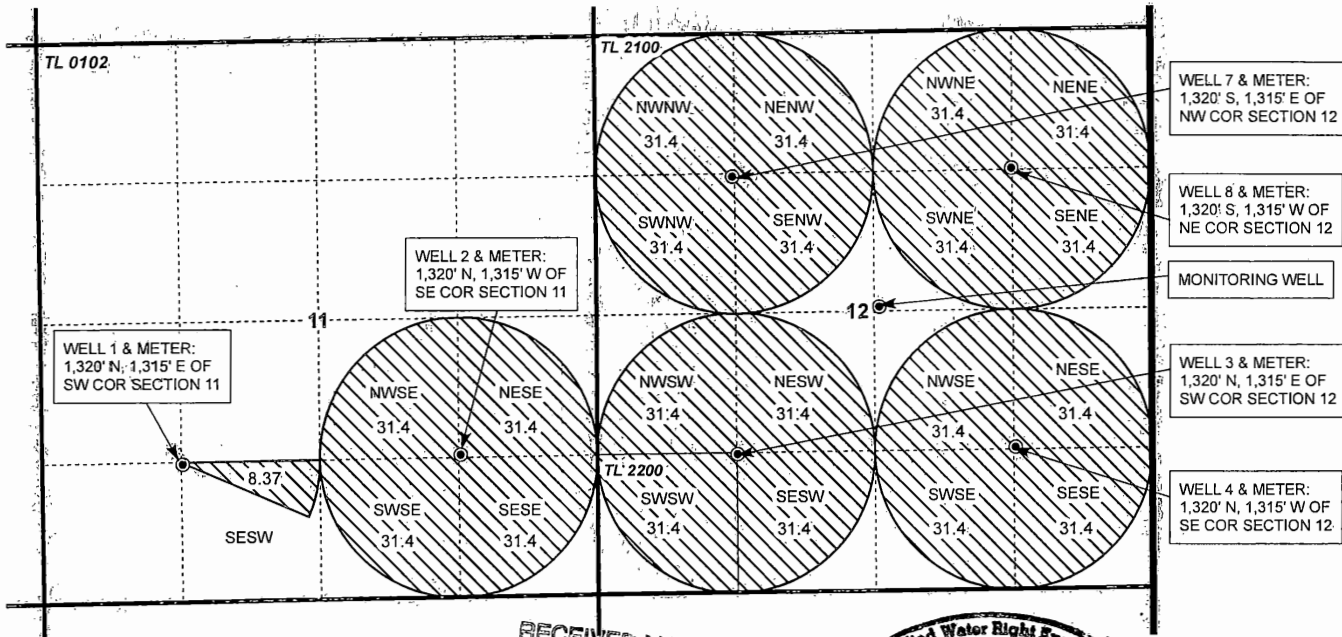

WELL 7 & METER:
1,320' S, 1,315' E OF
NW COR SECTION 12

WELL 8 & METER:
1,320' S, 1,315' W OF
NE COR SECTION 12

MONITORING WELL

WELL 3 & METER:
1,320' N, 1,315' E OF
SW COR SECTION 12

WELL 4 & METER:
1,320' N, 1,315' W OF
SE COR SECTION 12

WELL 2 & METER:
1,320' N, 1,315' W OF
SE COR SECTION 11

WELL 1 & METER:
1,320' N, 1,315' E OF
SW COR SECTION 11

- POU IR
- Taxlot
- Section
- Well
- Quarter Quarter

RECEIVED BY OWRD

JAN 10 2017

SALEM, OR

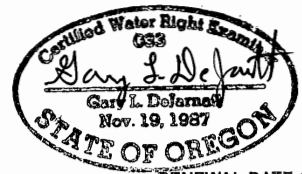

RENEWAL DATE 12/31/2017



CLAIM OF BENEFICIAL USE MAP
Singhose Land & Cattle Co., LLC

NOTE: THIS MAP IS NOT INTENDED TO
PROVIDE LEGAL DIMENSIONS OR LOCATIONS
OF PROPERTY OWNERSHIP LINES.

WATER RIGHT SERVICES, LLC
PO BOX 1830, BEND, OR 97709
CCB# 197121 www.oregonwater.us

AP G-17581 T-12136 PERMIT G-17576

JOB # 15102. DECEMBER 8, 2016

541-389-2837 JOHNSHORT@USA.COM