

CLAIM OF BENEFICIAL USE MAP

FOR: BERT BRUNDIGE

BY: NATHAN R. REED, CWRE
 T26S, R3W, W.M. SECTION 10
 APPLICATION NO. S-87113
 PERMIT NO. S-54485



RECEIVED BY OWRD

APR 20 2015

SALEM, OR

DATE SURVEYED: APRIL 15, 2015

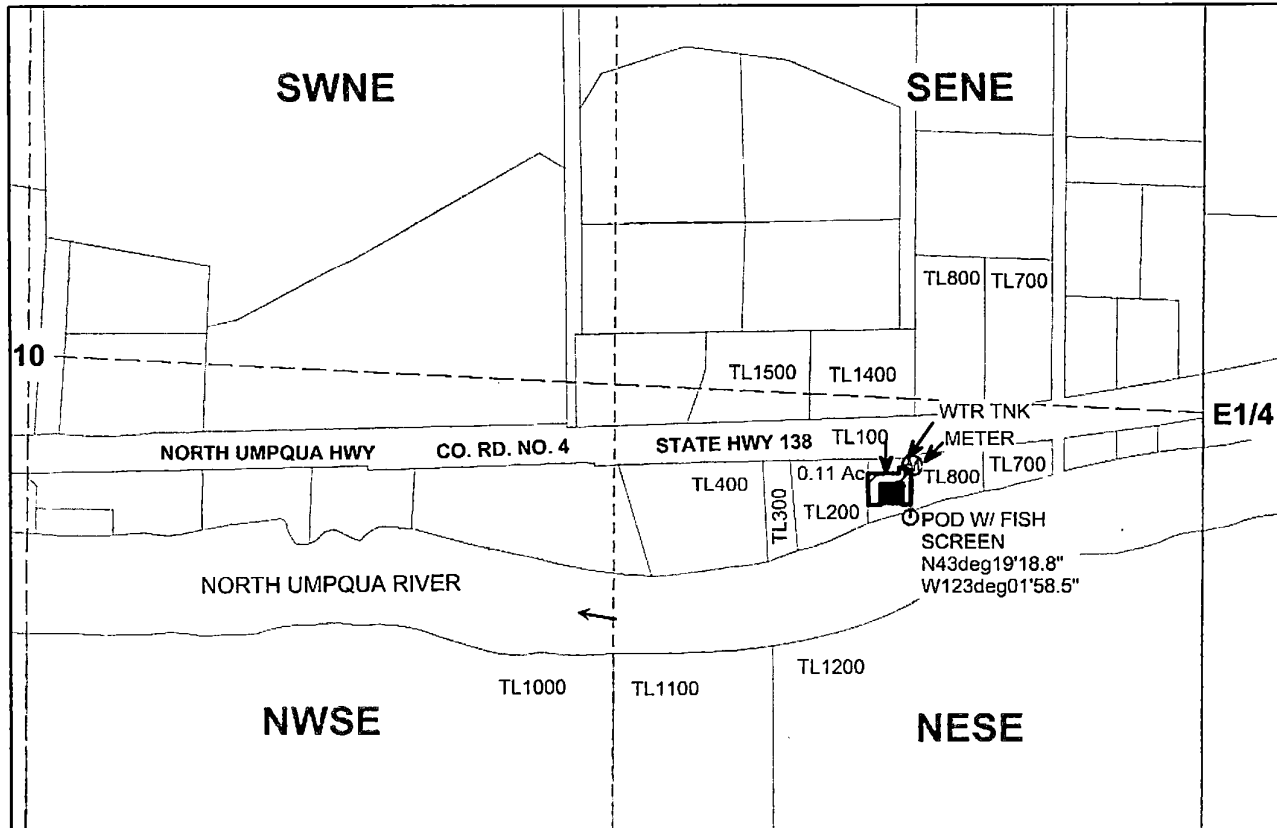

POD IS LOCATED 226 FEET SOUTH AND 640 FEET WEST FROM THE EAST 1/4 CORNER OF SECTION 10.

Legend

- | | | | |
|-------|-----------------|-------|------------|
| ○ | POD | → | Flow Arrow |
| ----- | Pipeline | □ | Section |
| Ⓜ | Meter | ----- | Quarter |
| □ | Water_Tank | ----- | Sixteenth |
| ▨ | Irrigation Area | □ | Parcels |
| ■ | Structure | | |

MAP PREPARED FOR:
 BERT BRUNDIGE
 1086 DAIRY LOOP RD
 ROSEBURG, OR 97471

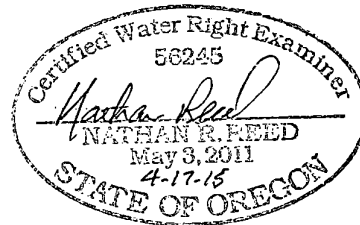

Expires Dec. 31, 2016

THE PURPOSE OF THIS MAP IS TO IDENTIFY THE LOCATION OF THE WATER RIGHT. IT IS NOT INTENDED TO PROVIDE INFORMATION RELATIVE TO THE LOCATION OF PROPERTY OWNERSHIP BOUNDARY LINES.

MAP PREPARED BY:
 NATHAN R. REED, P.E., CWRE
 1113 SE CASS AV
 ROSEBURG, OR 97470