

Sections 2 to 4, 8 to 16, 21 to 24, 27, 28 and 30
 T4N, R28E, W.M.
 &
 Section 10, T5N, R28E, W.M.
 Umatilla County, Oregon
 Application R-58245, Permit S-49497
 CLAIM OF BENEFICIAL USE MAP
 Port of Umatilla

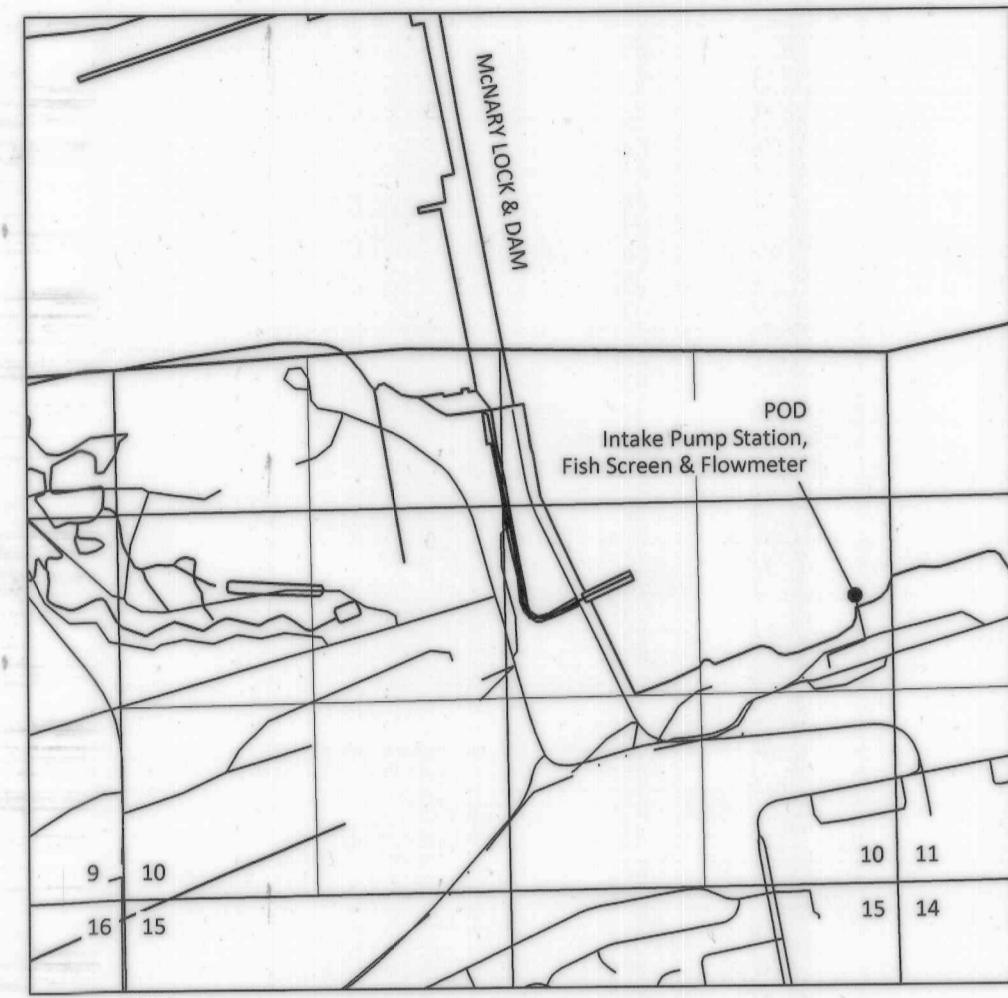

EXPLANATION

September 2018 JPB 11/9/18
 PLACE OF USE FOR PART 2018 PARTIAL PERFECTION
 PRIORITY DATE: JANUARY 19, 1979

• POD (Intake Pump Station, Fish Screen & Flowmeter)
 ■ RESERVOIR

POD LOCATED: 1970 FT N and 280 FT W
 From SE Corner of Section 10, T 5 N, R 28 E, W.M.

NOTES:
 1. Site inspection conducted August 29, 2018 JPB 11/9/18
 2. 11.5 acre in-line raw-water reservoir, wet wells, and non-potable pump stations #1 and #2 details are shown on Figure 2 prepared by MWH.

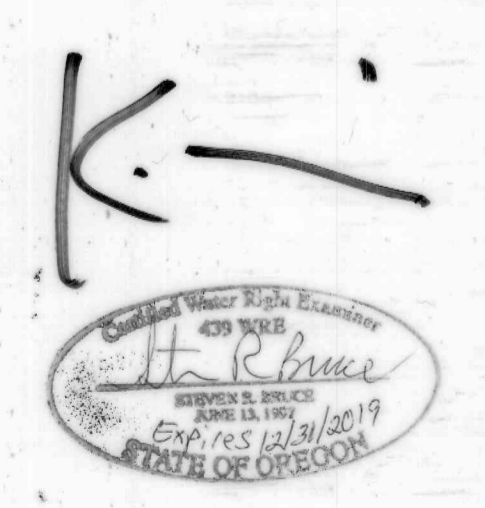
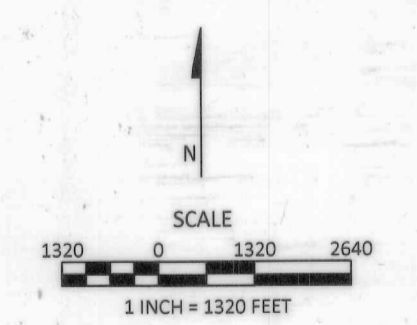

September 24, 2018
 This map is not intended to provide legal dimensions or locations of property ownership lines
 RECEIVED
 Figure 1 OCT 13 2018
 OWRD

SKOOKUM
 WATER ASSOCIATION, INC.
 1626 VICTORIAN WAY
 EUGENE, OR 97401
 (503) 319-8926

COBU MAP# 1121