

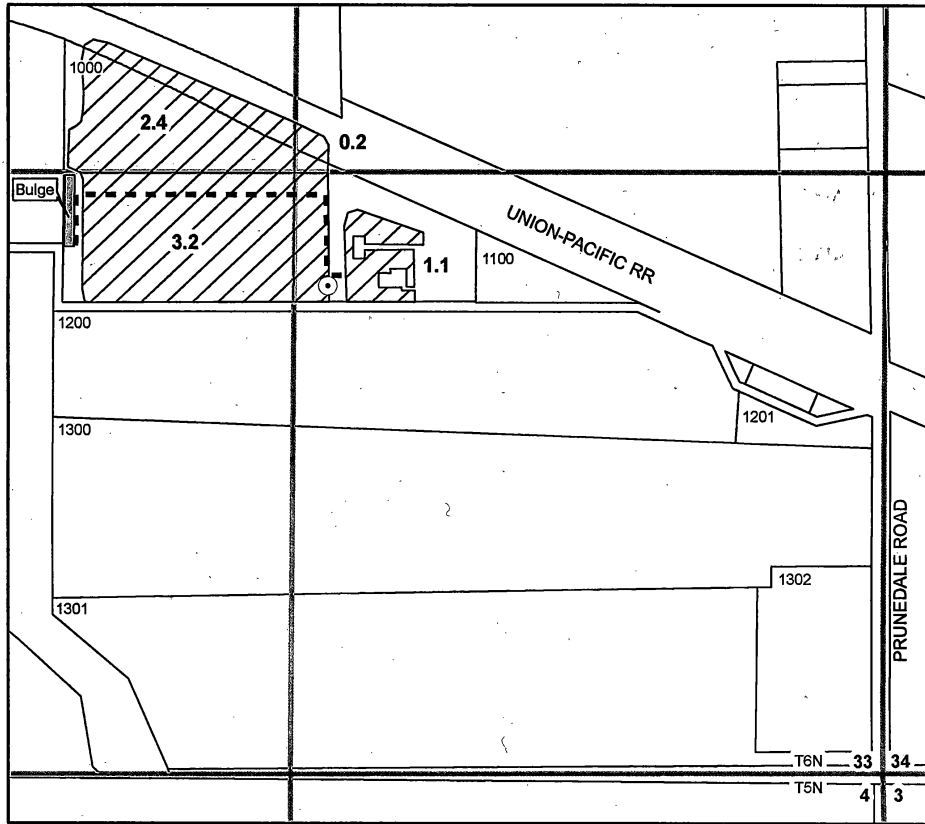

SE 1/4 of SECTION 33  
T6N, R35E, WM  
Umatilla County

1 inch = 400 ft



⊙ **Authorized POA**

Well is located in the SE/4 of SE/4, Section 33, T6N, R35E, WM, at a distance 1050 feet N and 1250 feet W from SE Corner of Section 33. Well Log UMAT 54895. Flowmeter at same location.

----- **Conveyance**

Water conveyed from well throughout place of use with buried PVC mainline. Water applied with solid-set sprinklers (Nelson R10) installed above and below tree canopy.

 **Authorized POU**

Water beneficially used for irrigation and temperature control of 6.9 acres, including:

- 0.2 ac in NE/4 of SE/4, Section 33, T6N, R35E, WM
- 2.4 ac in NW/4 of SE/4, Section 33, T6N, R35E, WM
- 3.2 ac in SW/4 of SE/4, Section 33, T6N, R35E, WM
- 1.1 ac in SE/4 of SE/4, Section 33, T6N, R35E, WM

RECEIVED

JUN 30 2010

WATER RESOURCES DIV  
SALEM, OREGON

The purpose of this map is to identify the location of a water right. It is not intended to provide information regarding the location of property ownership boundary lines.

FOUNTAINHEAD  
1204 Alvarado Terrace  
Walla Walla, WA 99362  
509.529.2646 phone

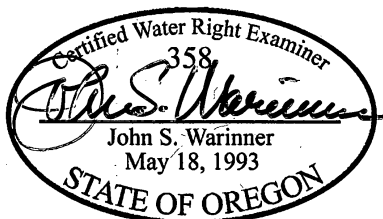

**CLAIM OF BENEFICIAL USE**  
**Application G-16102**  
**Permit G-15660**  
in the name of  
**ERNEST WILMOT**  
Revised 10 MAY 2010