

T.9 S. R.1W. W.M.

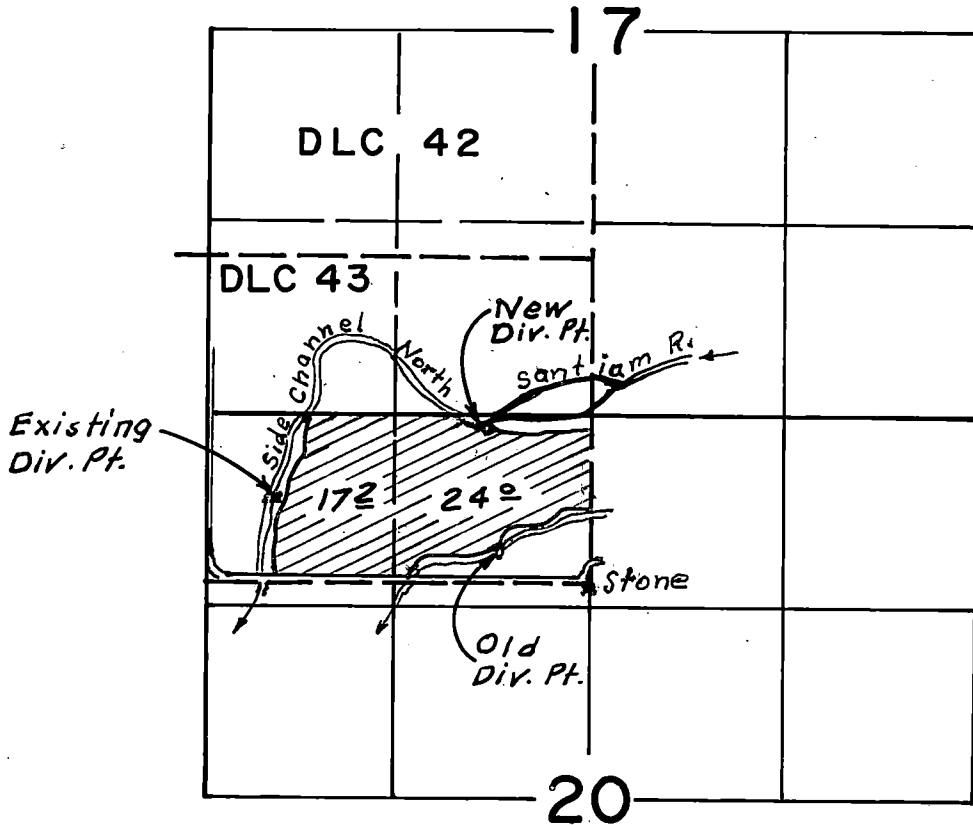

Old Div. Pt.: 200' N & 650' W from SE Cor. DLC 43
 New Div. Pt.: 1080' N & 740' W " " " " "
 Exist. Div. Pt.: 570' N & 2180' W " " " " "

RECORDED

MAY 15 1997

FINAL PROOF SURVEY UNDER

Transfer No. 6853

Application No. Permit No.

IN NAME OF

WARREN S. & JANICE L. GRAY

Surveyed SEP. 16 1992, by

Inspected MAY 5, 1997

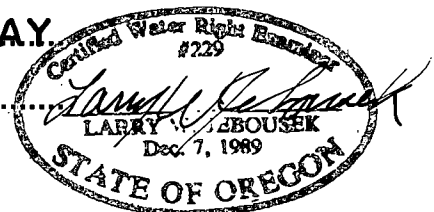

WAC Aerial Photo

THIS MAP WAS PREPARED FOR THE PURPOSE OF IDENTIFYING THE LOCATION OF A WATER RIGHT ONLY AND IS NOT INTENDED TO PROVIDE LEGAL DIMENSIONS OR LOCATION OF PROPERTY OWNERSHIP LINES.