

T24S R29E, WM, HARNEY COUNTY, OR

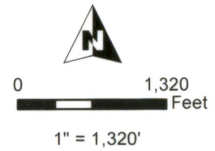

- Well & Meter
- POU IR
- Township
- Section
- Quarter Quarter
- Tax Lot

Well Locations:

- Well #3: N 62', 507' E of NW Cor Sec 12
- Well #4: S 2667', 1271' E of NW Cor Sec 12



RENEWAL DATE 12/31/2018

RECEIVED

DEC 17 2018

OWRD



WATER RIGHT SERVICES, LLC
 PO BOX 1830, BEND, OR 97709
 WWW.OREGONWATER.US CCB # 197121
 johnshort@usa.com 541-389-2837

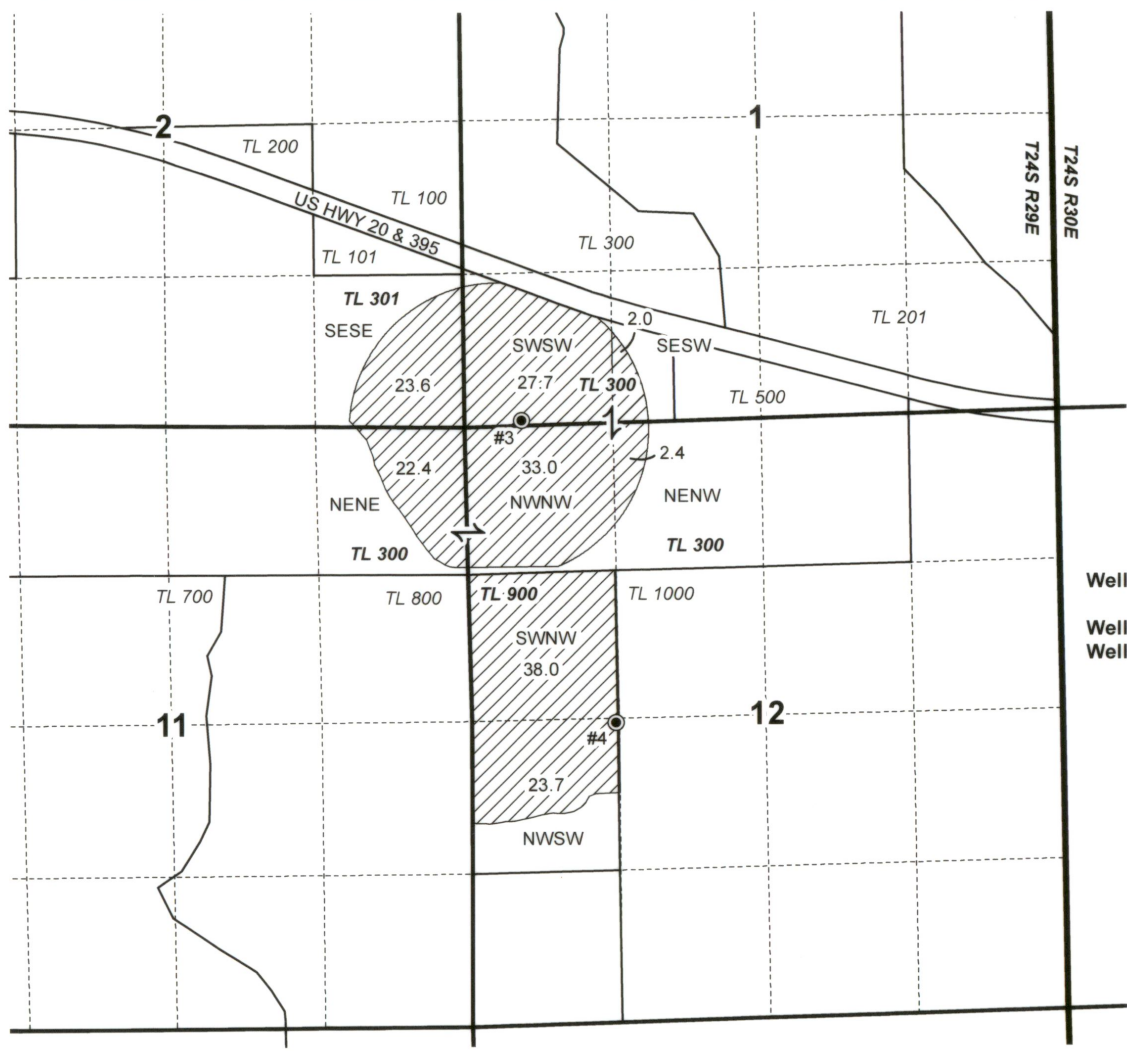

CLAIM OF BENEFICIAL USE MAP
Bauer Family Farm, LLC

This map is not intended
 to provide legal dimensions
 or locations of property
 ownership lines.