

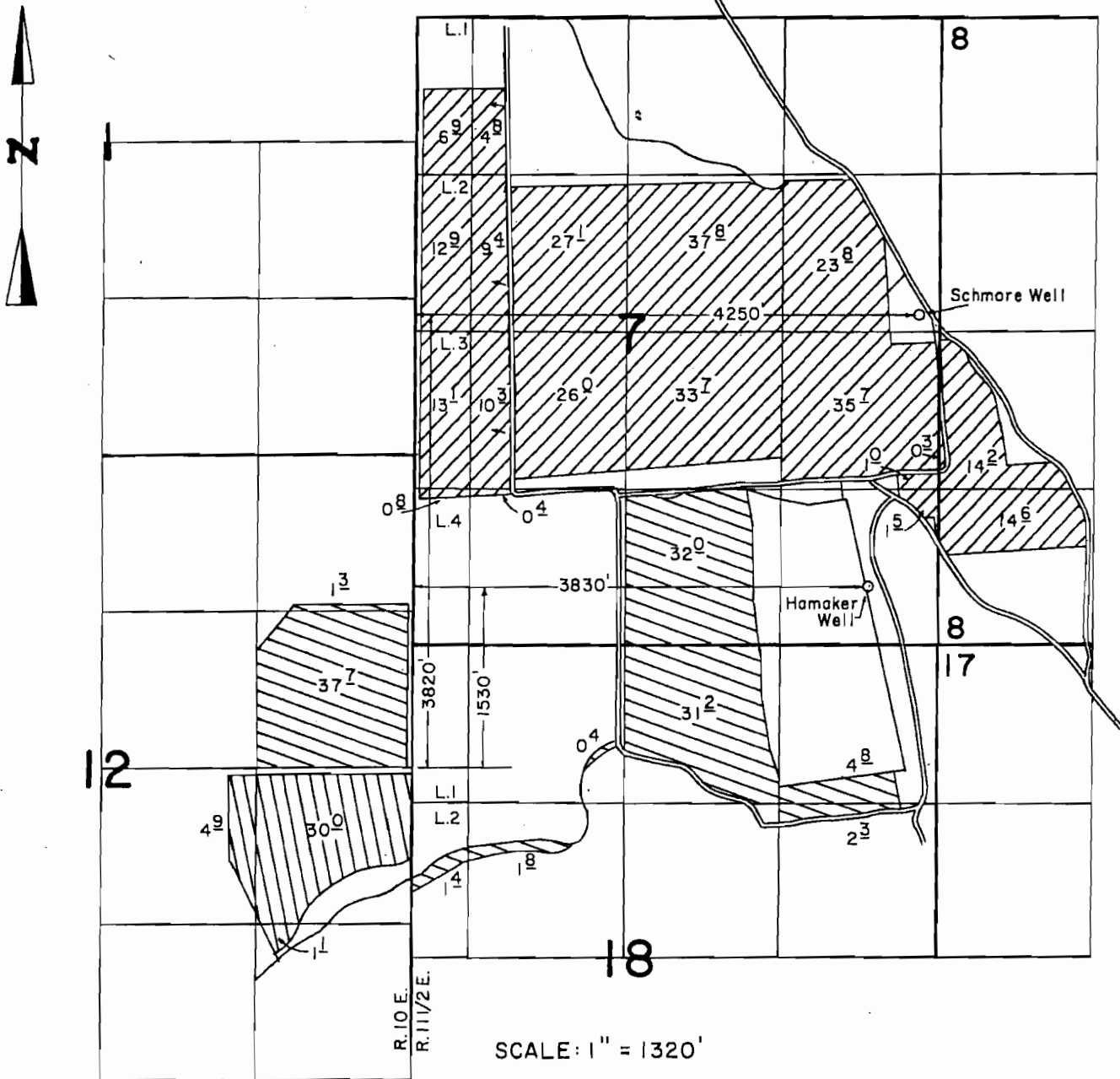



T. 38 S., R. 10 & 11 1/2 E., W.M.



SCALE: 1" = 1320'

FINAL PROOF SURVEY

UNDER
TRANSFER NO. 3486

-  Primary (HAMAKER WELL)
-  Supplemental " "
-  Primary (SCHMORE WELL)

Application No. G-7396, Permit No. G-6835
IN NAME OF

C.W. BIAGGI & T.M. VENABLE

Surveyed SEPT. 20 1989, by B.W. BISHOP