

FINAL PROOF MAP  
T.1S.,R.1E.,W.M. SECTION 10

POINT OF DIVERSION LOCATED IN: TAX LOT 600 OF MULTNOMAH CO. ASSESSORS MAP  
1S 1E 10AA  
WATER USE IN: TAX LOT 600 OF MULTNOMAH CO. ASSESSORS MAP  
1S 1E 10AA

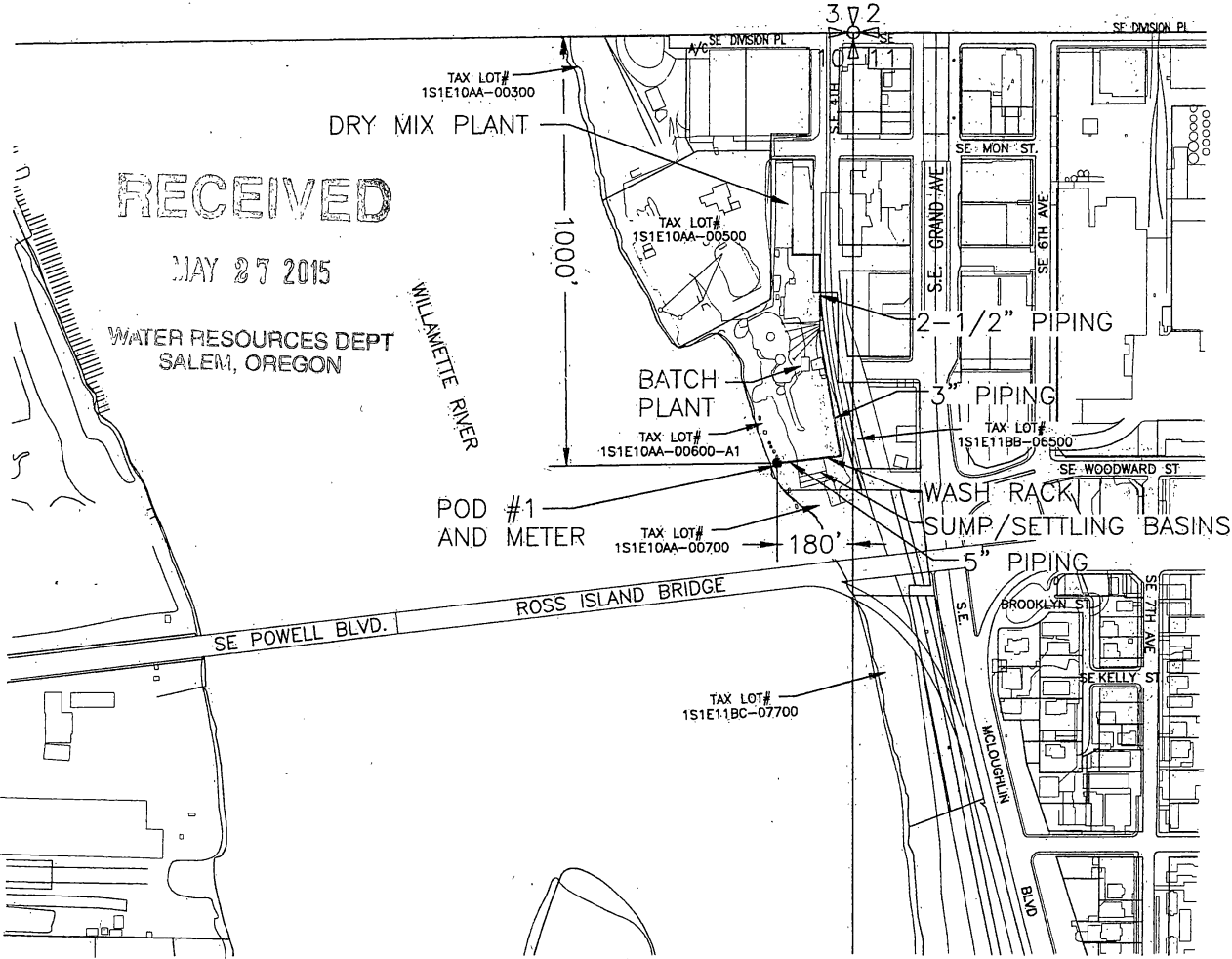

FINAL PROOF SURVEY FOR  
APPLICATION NO. S-81614, PERMIT NO. 53241  
IN THE NAME OF  
ROSS ISLAND SAND & GRAVEL CO.  
(TAIT PLANT)  
APRIL 2015

NOTE: THE PURPOSE OF THIS MAP IS TO IDENTIFY THE LOCATION OF THE WATER RIGHT. IT IS NOT INTENDED TO PROVIDE INFORMATION RELATIVE TO THE LOCATION OF PROPERTY OWNERSHIP BOUNDARY LINES.

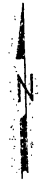

SCALE:  
1" = 400'

RENGWS  
6.30.15

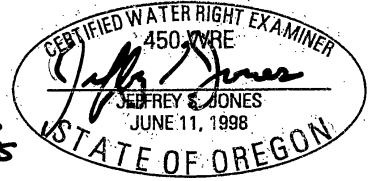

Murray, Smith & Associates, Inc.  
Engineers/Planners

121 S.W. Salmon, Suite 1020 PHONE 225-9010  
Portland, Oregon 97204 FAX 225-9922

G:\PDX\_Proj\14\1622\_Ross\_Island\_Sand & Gravel\_WR\CAD\Figures\14-1622-401-OR-MAP2.dwg:Layout1 4/29/15 11:21 (DKT)