

FINAL PROOF MAP
T.1N.,R.1E.,W.M. SECTION 27

POINT OF DIVERSION LOCATED IN: TAX LOT 3000 OF MULTNOMAH CO. ASSESSORS MAP
1N 1E 27CB
WATER USE IN: TAX LOT 3000 OF MULTNOMAH CO. ASSESSORS MAP
1N 1E 27CB

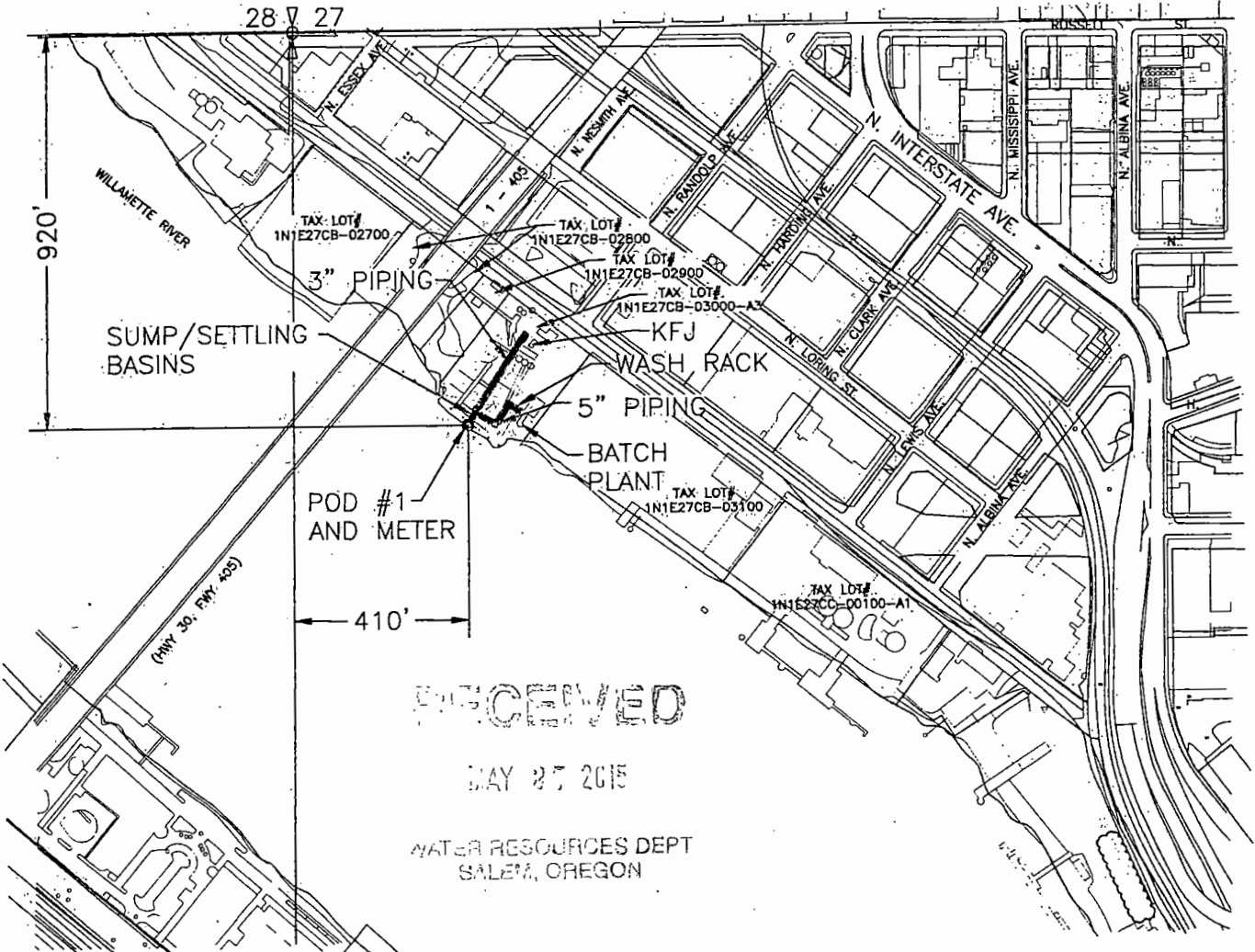

FINAL PROOF SURVEY FOR
APPLICATION NO. S-81615, PERMIT NO. 53242
IN THE NAME OF
ROSS ISLAND SAND & GRAVEL CO.
(ALBINA PLANT)
APRIL 2015

NOTE: THE PURPOSE OF THIS MAP IS TO IDENTIFY THE LOCATION OF THE WATER RIGHT. IT IS NOT INTENDED TO PROVIDE INFORMATION RELATIVE TO THE LOCATION OF PROPERTY OWNERSHIP BOUNDARY LINES.

SCALE:
1" = 400'

RENGWS
G.30.15



Murray, Smith & Associates, Inc.
Engineers/Planners

121 S.W. Salmon, Suite 1020 PHONE 225-9010
Portland, Oregon 97204 FAX 225-9922

G:\PDX-Projects\14\1622-Ross-Island-Sand-Gravel-WR\CAD\Figures\14-1622-401-OR-MAP3.dwg Layout 1:5/6/15 1:4:47 (DKT)