

RECEIVED

APR 10 2018

OWRD

T4S, R3W, Sec 31 &
T4S, R4W, Sec 36, WM
TRANSFER APPLICATION MAP
YAMHILL COUNTY

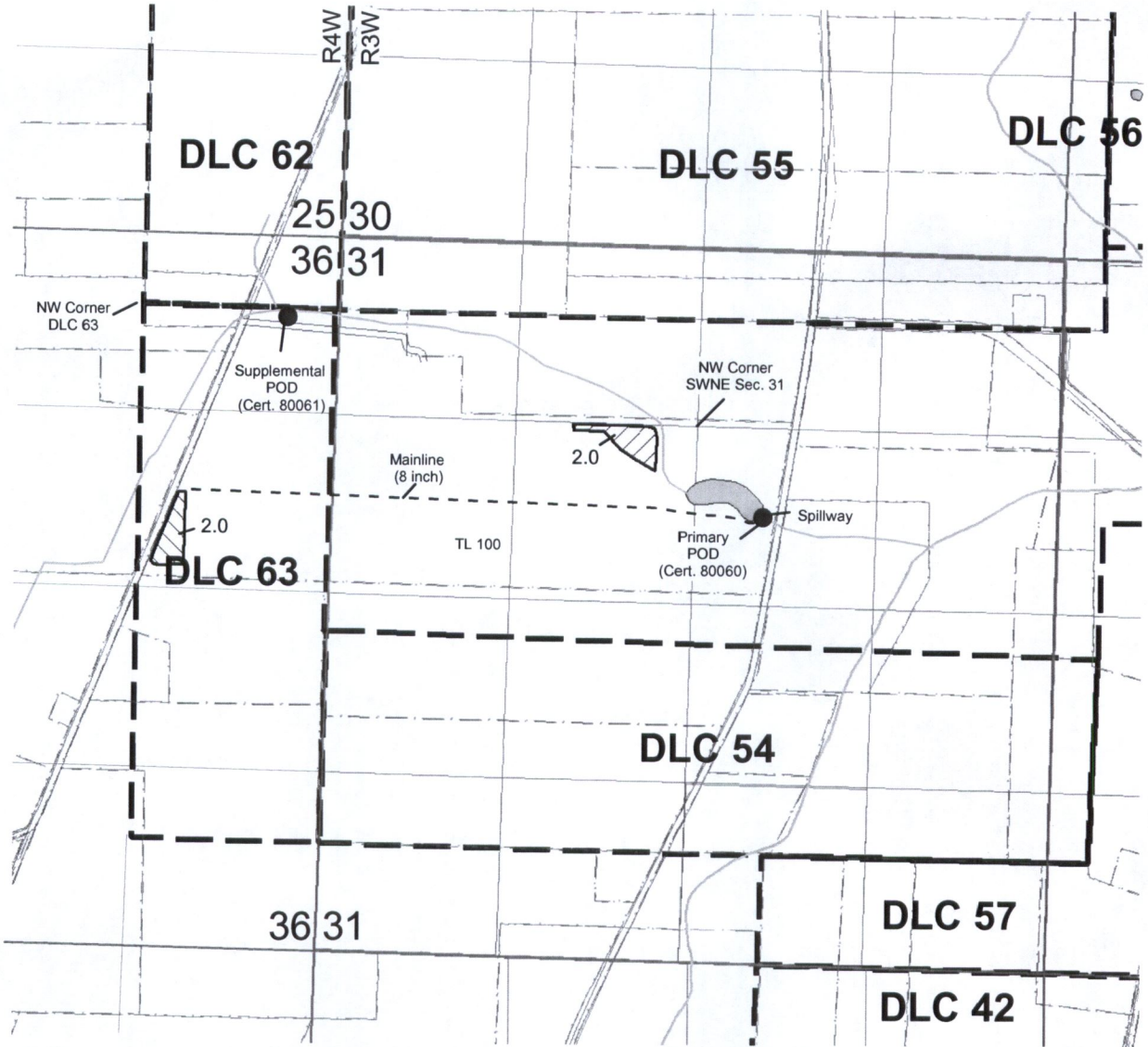

Primary Cert. 80060 POD is located 660'S and 500' E from the NW corner of SWNE Section 31
 Supplemental Cert. 80061 POD is located 100'S and 990' E from the NW corner of DLC 63

1 inch = 1,320 feet

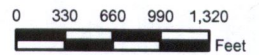

Explanation

- Place of Diversion (POD)
- Roads
- Water Feature
- - Mainline
- Tax Lots
- ▨ From Lands (Cert. 80060 and 80061)
- ▩ To Lands (Cert. 80060 and 80061)

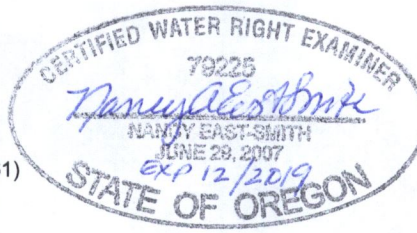

World Geodetic System (WGS)
 Datum of 1984
 Prepared March 29, 2018

Sources: BLM CadNSDI PLSS (GeoCommunicator LSIS, 2014); The Oregon Map (ORMAP tax lots, 2016); available County roads, lakes, and rivers GIS shapefiles (EnviroLogic Resources, ArcGIS Backup Files, 2016). Google Earth aerial

This map was prepared for the purpose of identifying the location of a water right only and is not intended to provide legal dimensions or locations