

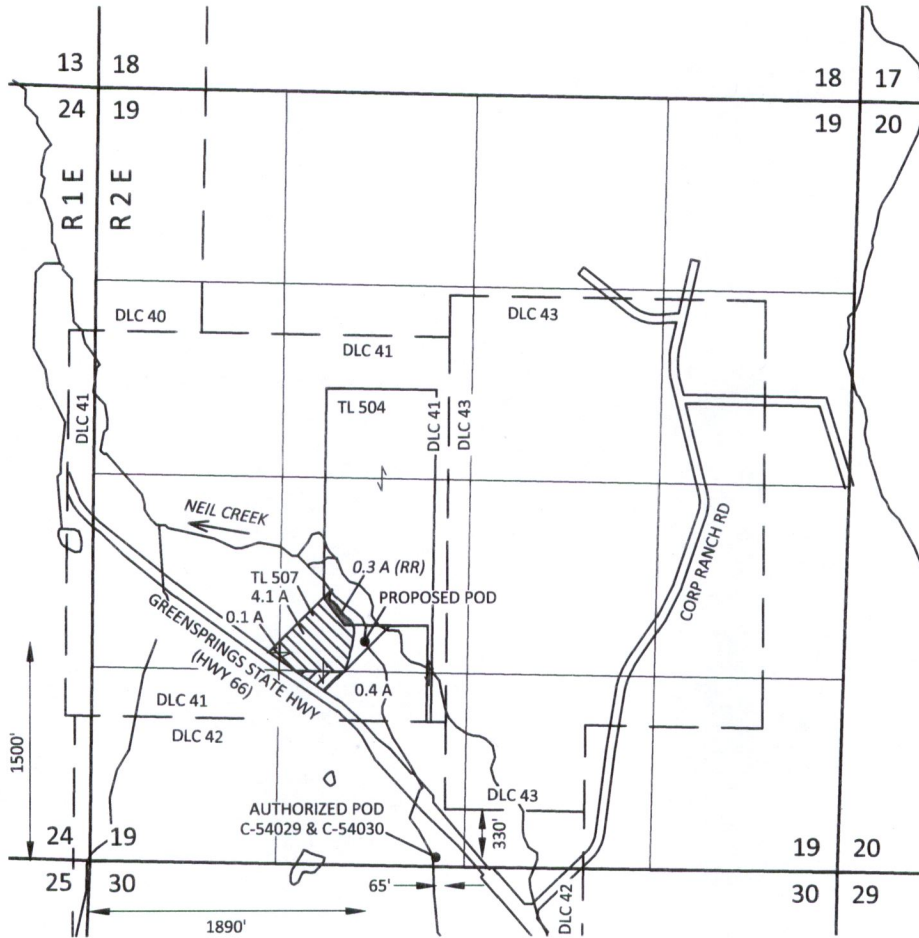



Section 19, T39S, R2E, W.M.,
Jackson County, Oregon

TRANSFER APPLICATION MAP
Certificates 54029 & 54030
Tabula Rasa LLC



RECEIVED
JUN 11 2018
OWRD

EXPLANATION

REMAINING RIGHT (RR)		ADDITIONAL POD	
	CERTIFICATE 54029 PRIORITY: 1854 0.3 ACRES		CERTIFICATE 54029 PRIORITY: 1854 4.2 ACRES
			CERTIFICATE 54030 PRIORITY: 1854 0.4 ACRES
			POINT OF DIVERSION (POD)

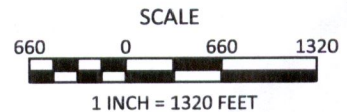

June 1, 2018

This map is not intended to provide legal dimensions or locations of property ownership lines

Figure 1

SKOOKUM
WATER ASSOCIATES INC

1626 VICTORIAN WAY
EUGENE, OR 97401
(503) 319-8926

