

T.17S.R.21E.W.M.

FINAL PROOF SURVEY

R-24576 R-1422
 R-24577 R-1423
 Application No. 24572 Permit No. 21721

IN NAME OF

F. Miles Mayfield

Surveyed Aug. 5, 1957, by C.O. Butch

21721 #182

24000
 52520

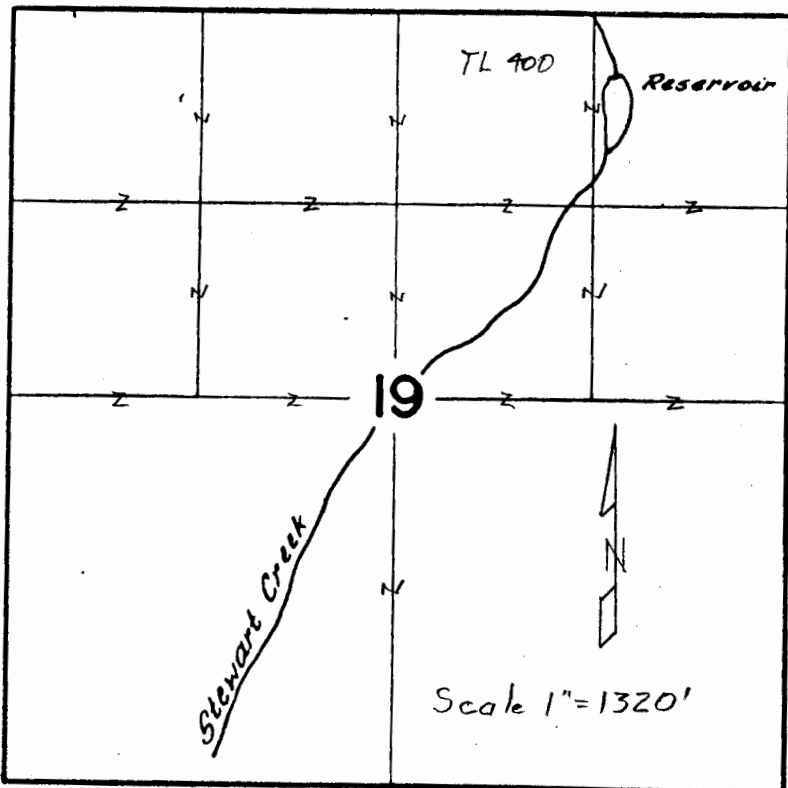
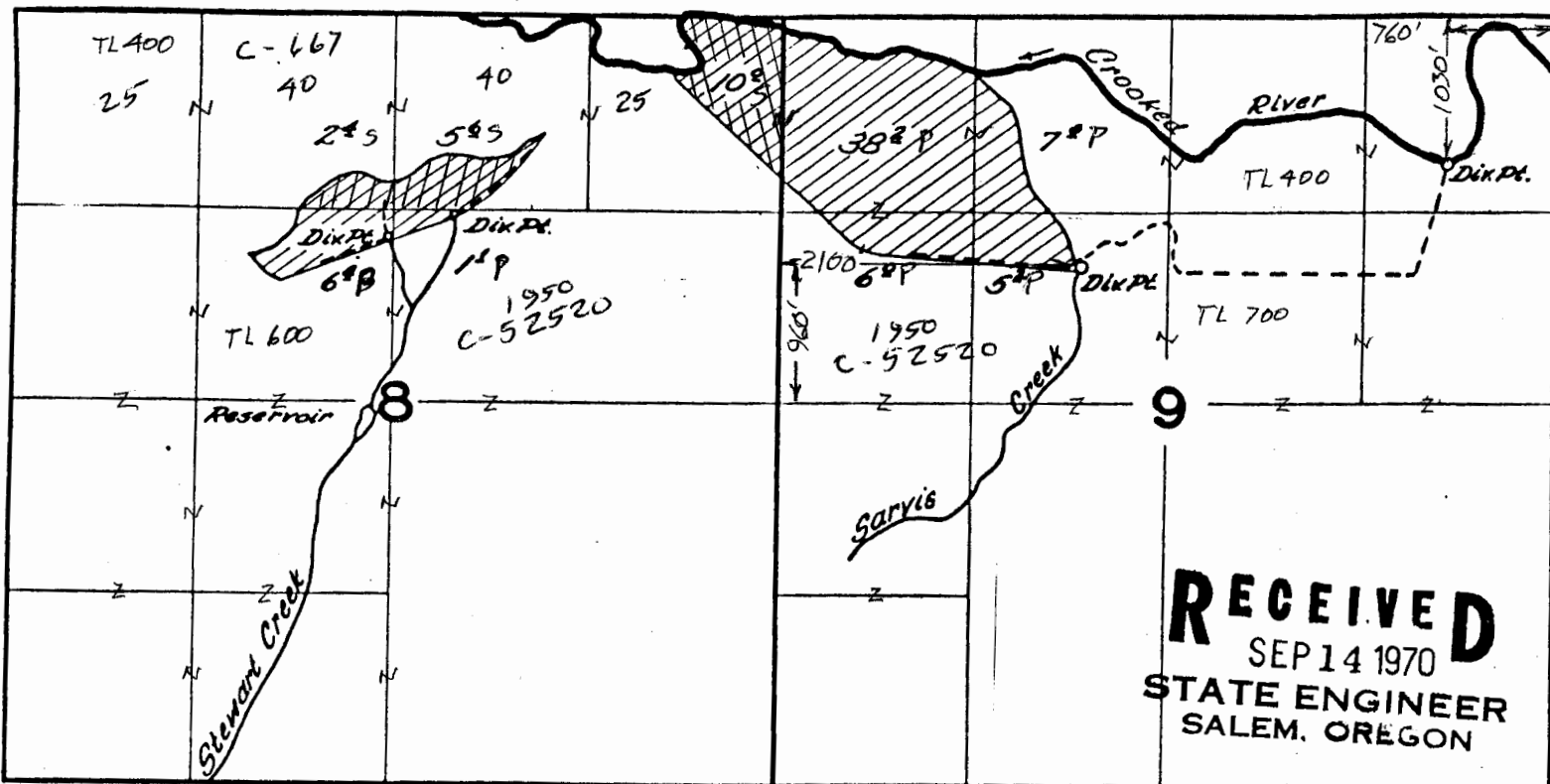

T.17S.R.21E.W.M.

Transfer Application Map
for
Waibel Ranches, LLC

From: C-52520

- ⊗ Sarvis Cr & Crooked R. 56⁴ acres
- ⊗ Sarvis Cr & Crooked R 10² Supp
- ⊗ Stewart Cr & Reservoirs 7⁵ acres
leave in place
- ⊗ Cancel 8² acres Supp

RECEIVED BY OWRD

JUN 06 2016

T 12404

SALEM, OR

Sheet 8 of 20

This map is for the purpose of locating a water right only and has no intent to provide legal dimensions or the location of property lines.

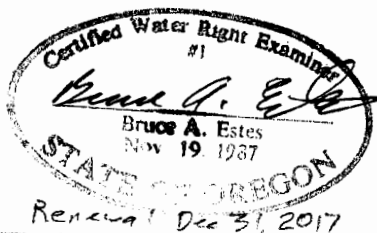

ESTES SURVEYS, LLC

PO Box 17519 80382 Arnold Rd
Salem, OR 97305-7519 Bend, OR 97702
(503) 585-7503 (541) 382-7301

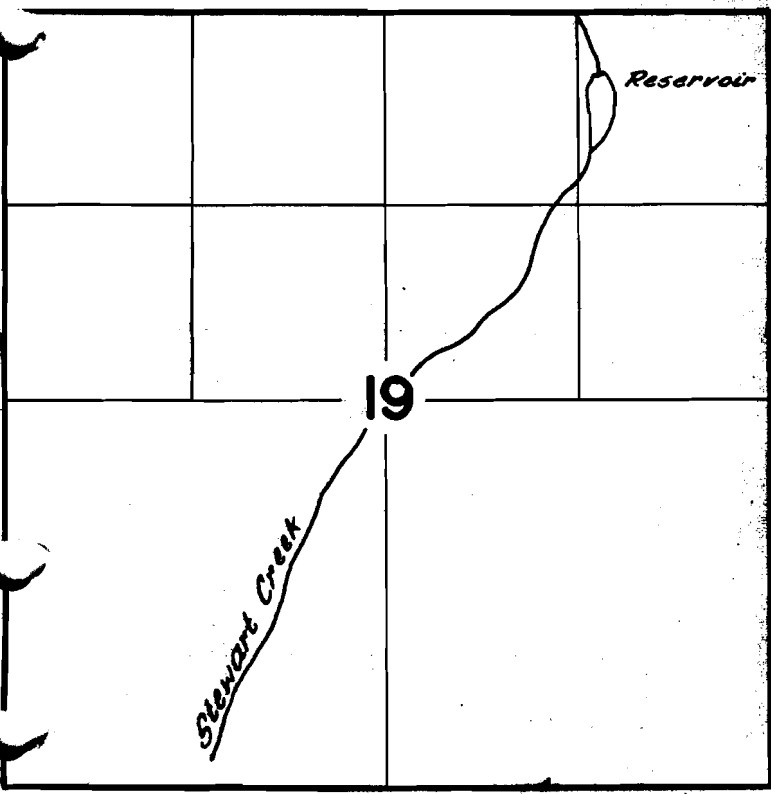
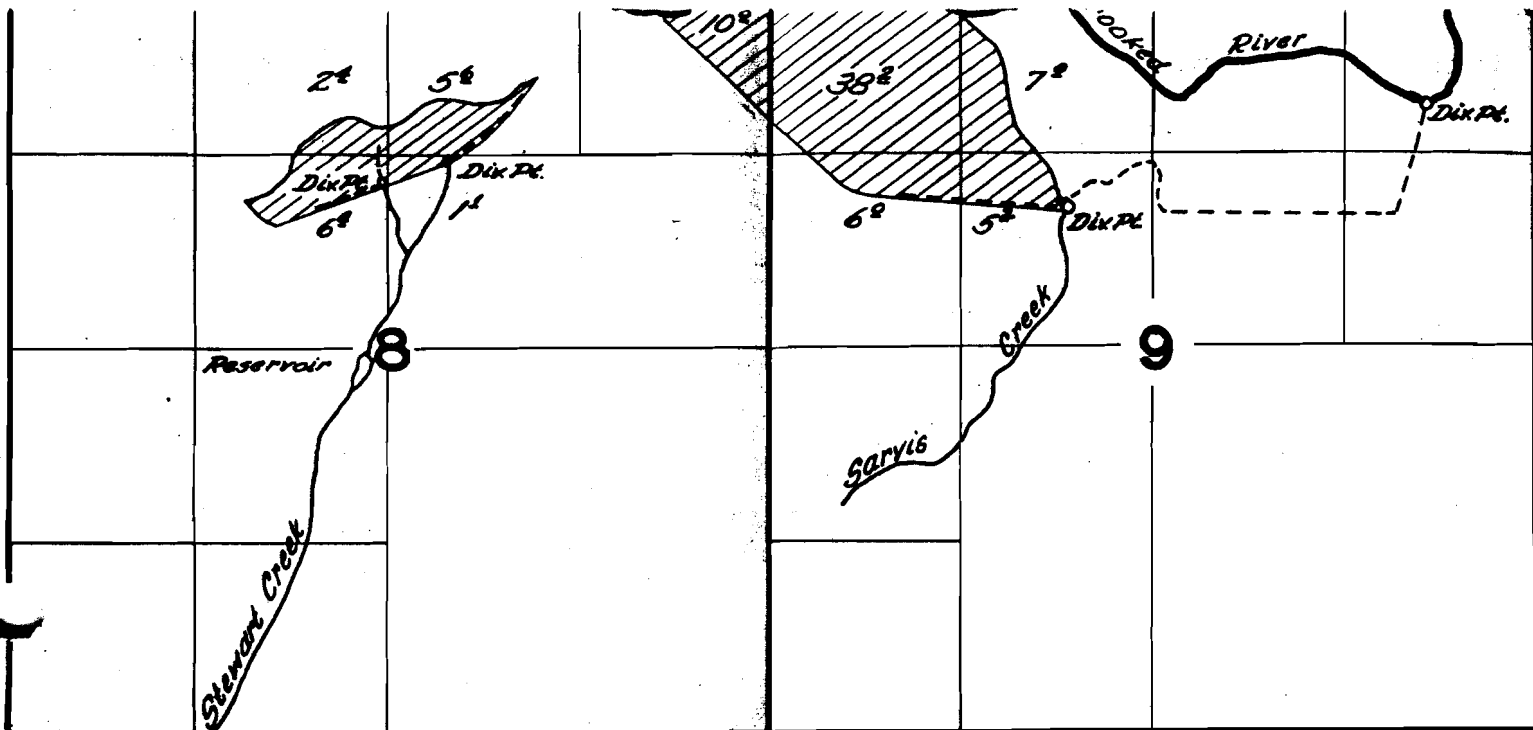

T.17S.R.21E.W.M.

FINAL PROOF SURVEY

R-24576 R-1422
 R-24577 R-1423
 Application No. 24572 Permit No. 21721

IN NAME OF

E. Miles Mayfield

Surveyed Aug. 5, 1957, by C.O. Burtch

C-24090

DCV-13N-25

pt. of Dix in 2359
 30 P 193

#1002
 21721