

# TOWNSHIP 14 SOUTH, RANGE 21 EAST, W.M.

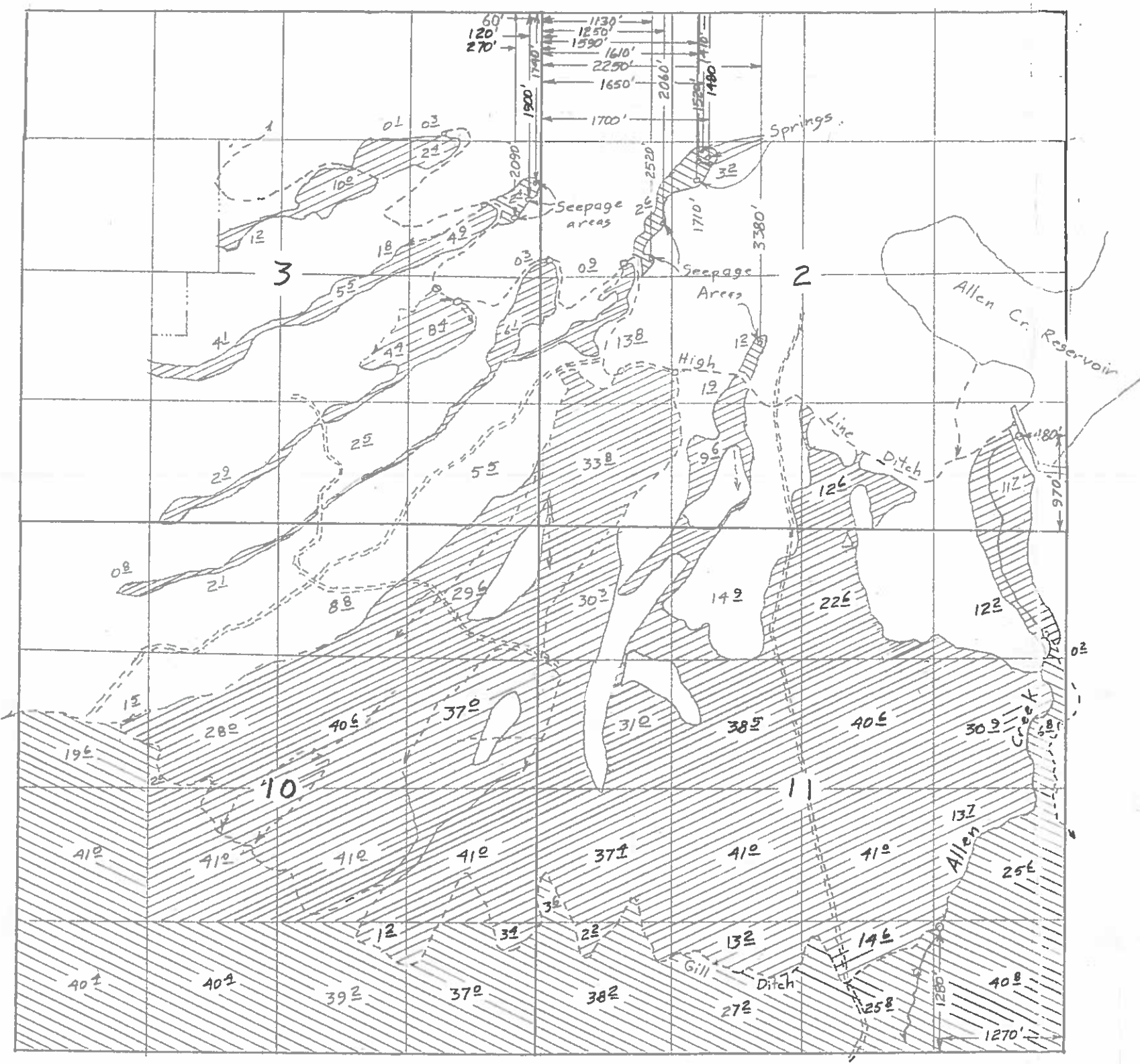

Claim of Beneficial Use Map  
for  
Les Schwab Tire Centers of Oregon  
(LS Ranch portion of Allen Creek  
and Springs/Seepage Areas under  
application 30100, permit 24774)

- ⊗ Allen Creek (1193<sup>6</sup> acres)
- ⊗ Springs/Seepage Areas (94 acres)

Scale 1"=1320'

**RECEIVED**  
JUN 01 2005  
WATER RESOURCES DEPT  
SALEM, OREGON

Certified Water Right Examiner  
#1  
*Bruce A. Estes*  
Bruce A. Estes  
Nov. 19, 1987  
STATE OF OREGON  
Renewal Dec 31, 2003

Surveyed August 14 & September 9&10, 2003

This map is for the purpose of  
locating a water right only  
and has no intent to provide  
legal dimensions or the location  
of property lines.

**ESTES SURVEYS, LLC**  
PO Box 17519      60382 Arnold Rd  
Salem, OR 97305-7519      Bend, OR 97702  
(503) 585-7593      (541) 382-7391

Amended 28 May 05

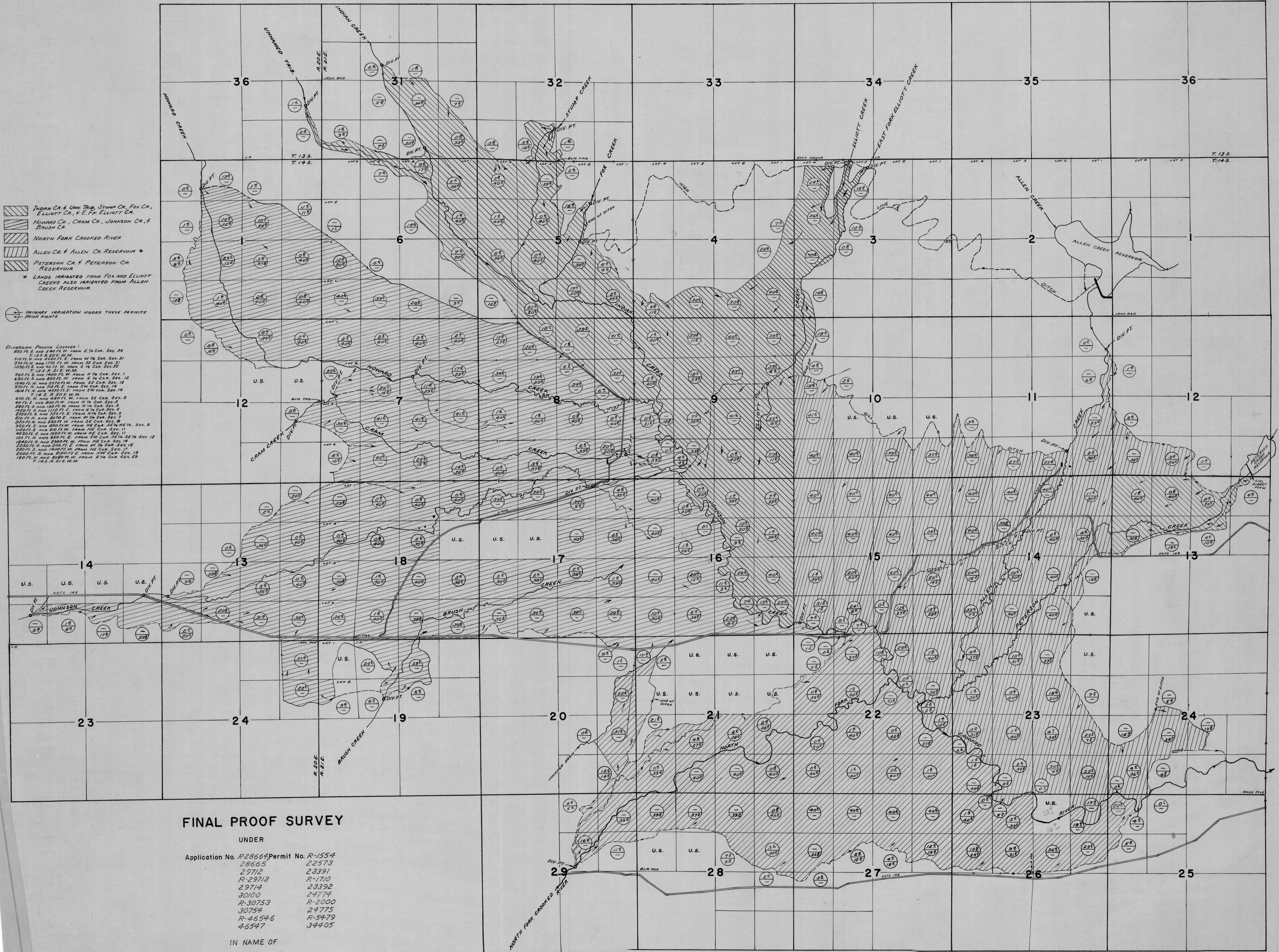

- INDIAN CR. & UNN. TRIG, STUMP CR., FOX CR., ELLIOTT CR. & E. F. ELLIOTT CR.
  - HOWARD CR., CRAM CR., JOHNSON CR. & BRUSH CR.
  - NORTH FORK CROOKED RIVER
  - ALLEN CR. & ALLEN CR. RESERVOIR \*
  - PETERSON CR. & PETERSON CR. RESERVOIR
- \* LANDS IRRIGATED FROM FOX AND ELLIOTT CREEKS ALSO IRRIGATED FROM ALLEN CREEK RESERVOIR.

PRIMARY IRRIGATION UNDER THESE PERMITS PRIOR RIGHTS

**DIVERSION POINTS LOCATED:**  
 800 FT. S. AND 280 FT. W. FROM W 1/4 COR. SEC. 36 T. 13 S. R. 20 E. W. M.  
 310 FT. N. AND 320 FT. E. FROM W 1/4 COR. SEC. 31 T. 13 S. R. 20 E. W. M.  
 1030 FT. S. AND 90 FT. W. FROM S 1/4 COR. SEC. 36 T. 13 S. R. 20 E. W. M.  
 360 FT. S. AND 180 FT. W. FROM N 1/4 COR. SEC. 12 T. 14 S. R. 21 E. W. M.  
 630 FT. S. AND 850 FT. W. FROM E 1/4 COR. SEC. 12 T. 14 S. R. 21 E. W. M.  
 500 FT. N. AND 520 FT. W. FROM SE COR. SEC. 13 T. 14 S. R. 21 E. W. M.  
 310 FT. N. AND 710 FT. E. FROM SW COR. SEC. 14 T. 14 S. R. 21 E. W. M.  
 184 FT. N. AND 980 FT. E. FROM SW COR. SEC. 14 T. 14 S. R. 21 E. W. M.  
 970 FT. N. AND 480 FT. W. FROM SE COR. SEC. 2 T. 14 S. R. 20 E. W. M.  
 90 FT. S. AND 800 FT. W. FROM N 1/4 COR. SEC. 3 T. 14 S. R. 20 E. W. M.  
 800 FT. S. AND 180 FT. W. FROM N 1/4 COR. SEC. 3 T. 14 S. R. 20 E. W. M.  
 1820 FT. S. AND 110 FT. E. FROM W 1/4 COR. SEC. 3 T. 14 S. R. 20 E. W. M.  
 870 FT. S. AND 220 FT. E. FROM W 1/4 COR. SEC. 3 T. 14 S. R. 20 E. W. M.  
 810 FT. N. AND 3070 E. FROM W 1/4 COR. SEC. 7 T. 14 S. R. 20 E. W. M.  
 320 FT. S. AND 890 FT. W. FROM NE COR. SEC. 9 T. 14 S. R. 20 E. W. M.  
 1020 FT. S. AND 290 FT. W. FROM NE COR. SEC. 11 T. 14 S. R. 20 E. W. M.  
 450 FT. S. AND 180 FT. W. FROM NE COR. SEC. 11 T. 14 S. R. 20 E. W. M.  
 101 FT. N. AND 650 FT. E. FROM NE COR. SEC. 14 T. 14 S. R. 20 E. W. M.  
 1840 FT. S. AND 280 FT. W. FROM NE COR. SEC. 16 T. 14 S. R. 20 E. W. M.  
 2250 FT. S. AND 500 FT. E. FROM N 1/4 COR. SEC. 12 T. 14 S. R. 21 E. W. M.  
 830 FT. S. AND 1400 FT. W. FROM NE COR. SEC. 17 T. 14 S. R. 21 E. W. M.  
 5000 FT. S. AND 800 FT. E. FROM NW COR. SEC. 19 T. 14 S. R. 21 E. W. M.  
 160 FT. N. AND 280 FT. W. FROM E 1/4 COR. SEC. 29 T. 14 S. R. 21 E. W. M.