

T.4S. R.1W. Sec. 12, W.M.

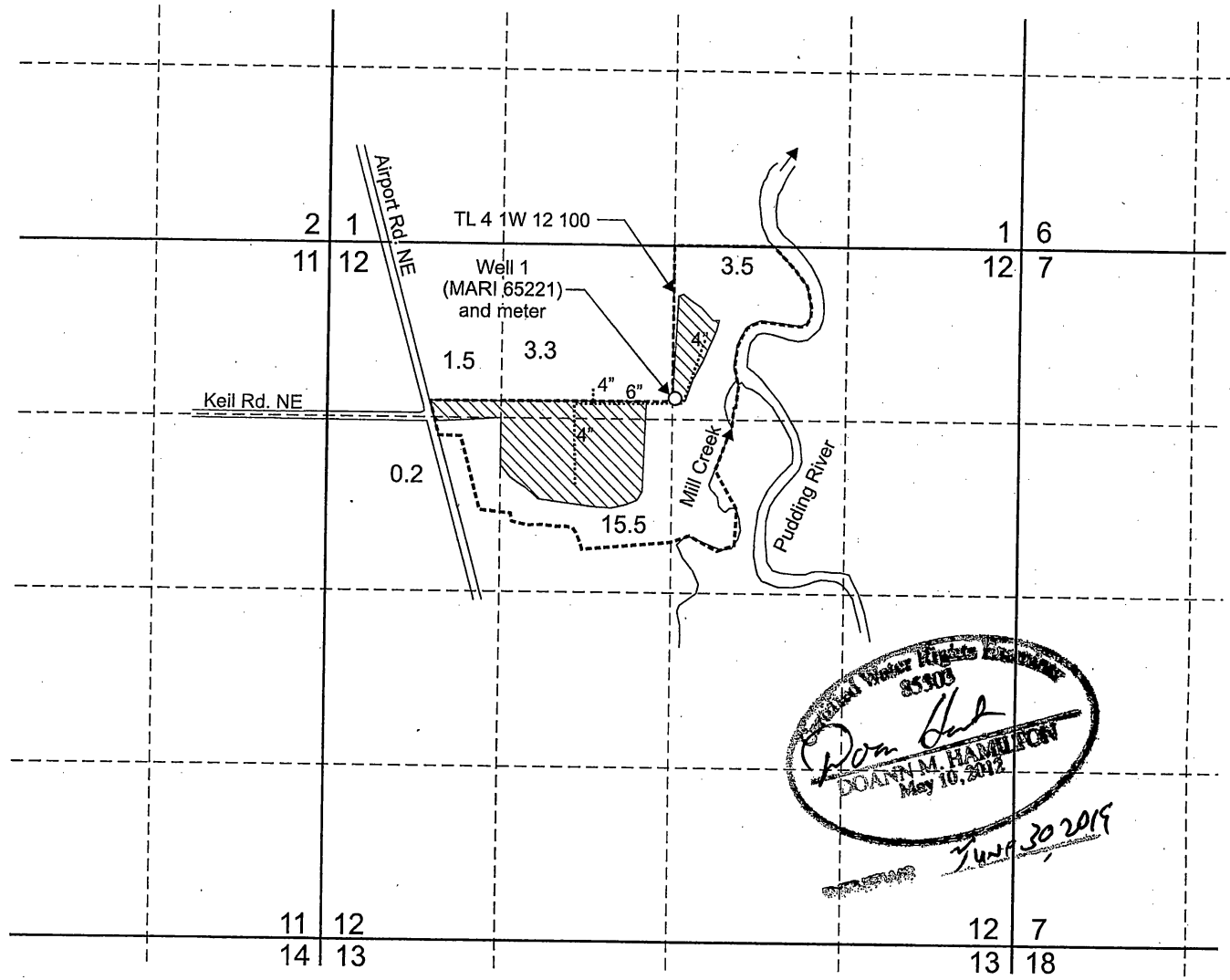

Well 1 (MARI 65221) is located 1,160 feet south and 2,620 feet west from the NE corner, Section 12.

 Area (24.0 Acres) irrigated under Application G-17953, Permit G-17701

----- Tax lot boundary

..... Irrigation mainlines

Scale: 1" = 1,320'

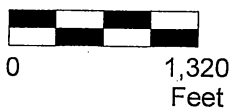

RECEIVED

MAR 12 2019

OWRD

This map was prepared for the purpose of identifying the location of a water right only and is not intended to provide legal dimensions or location of property ownership lines.

Claim of Beneficial Use Map
Application G-17953, Permit G-17701

Salem Nursery, LLC
T.4S. R.1W. Sec. 12, W.M.

Pacific Hydro-Geology Inc.

03/2019