

*Map of Pipe Line from Skelton Spring
To City of Newberg.*

*I, Oliver Weesner, of Newberg, Oregon,
do hereby certify that this map
was made from deeds, plat of Newberg,
plat of a survey made by Sylvander
Simms August 26, 1911, and records
of Yamhill Co. Oregon.*

Aug. 1, 1923.

Oliver Weesner.

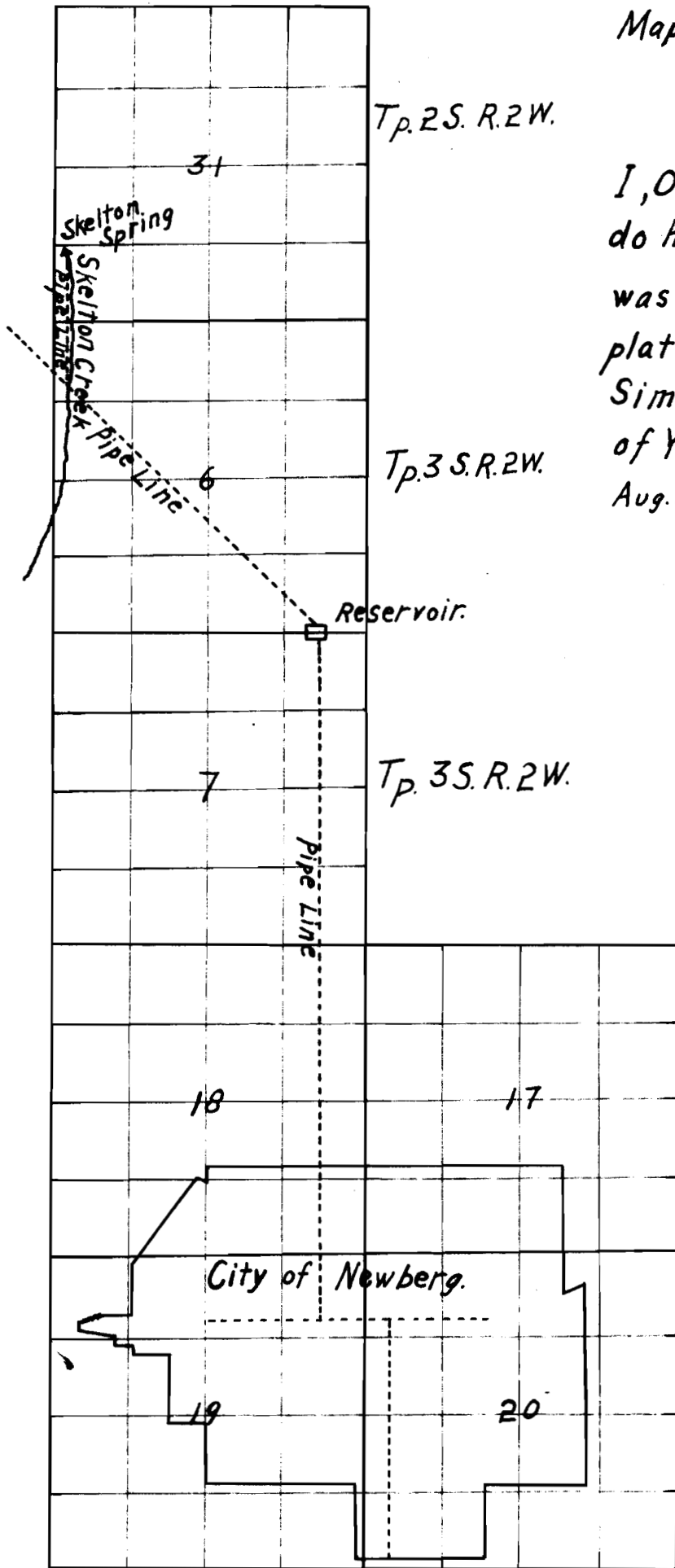

Application No. 6604
Permit No. 5977

Tp. 3 S. R. 2 W.

STATE ENGINEER
RECEIVED

AUG 2 1923

SALEM, OREGON

Tp. 3 S. R. 2 W.

Application for a Water Right Transfer in the Name of the Chehalem Springs Water Association Place of Use Map

RECEIVED

JAN 25 2018

Certificate 5456 (Application S-6604, Permit S-5977) for the use of Skelton Springs
Township 2/3 South, Range 2/3 West (W.M.)

OWRD

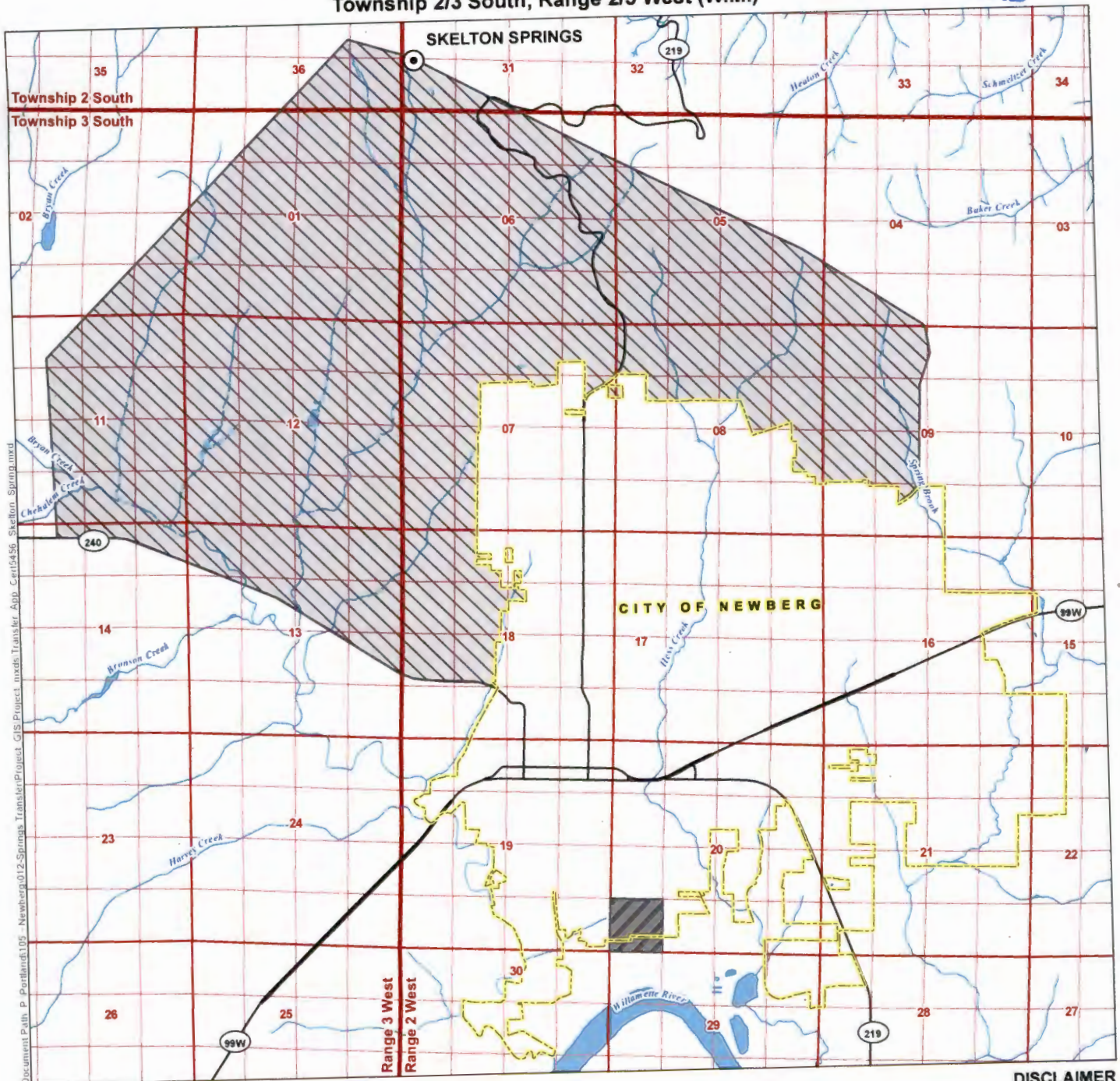

Document Path: P:\Portland\05 - Newberg\012 - Springs Transfer\Project_GIS\Project.mxd; Transfer App_Cert5456_Skelton_Spring.mxd

LEGEND

- Authorized Point of Diversion (POD)
- Authorized Place of Use
- Proposed Place of Use - Quasi-Municipal Use (Chehalem Springs Water Association Water Service Area)
- Newberg City Limits
- Major Road
- Watercourse
- Waterbody

Certified Water Rights Examiner Stamp

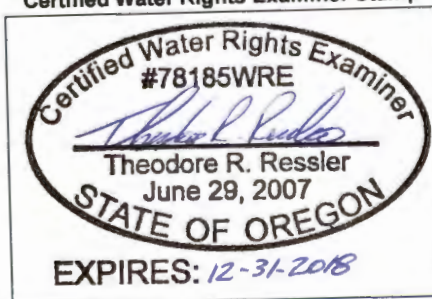

DISCLAIMER
This map was prepared for the purpose of identifying the location of a water right only and it is not intended to provide legal dimensions or location of property ownership lines.

MAP NOTES

Date: May 8, 2017
Data Sources: City of Newberg, ESRI, BLM, OWRD, USGS

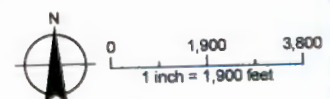

T 12831