

T. 1 S. R. 3 W. W.M.

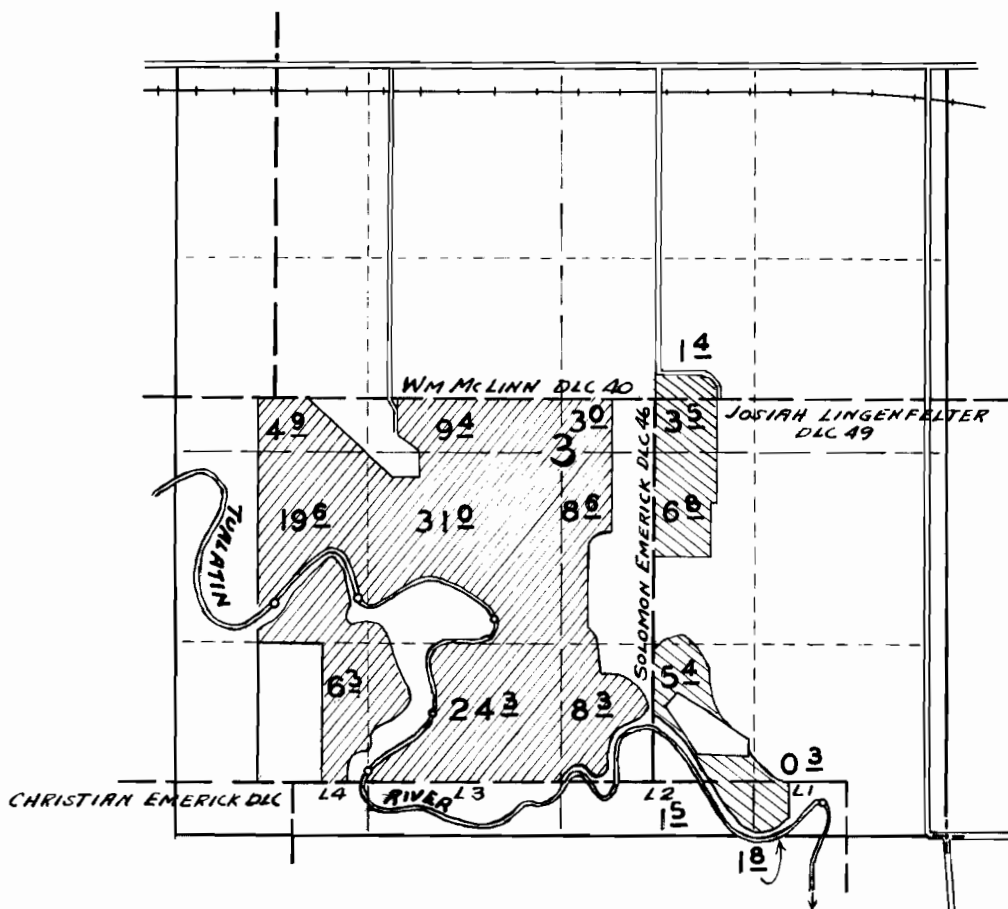

FINAL PROOF SURVEY

UNDER

26976

21189

Application No. 26203

Permit No. 20595



IN NAME OF

C. B. BUCHANAN, JR.

Surveyed 4-26 1956, by R. H. WHITBY.

7-2/3

MAP FOR Water Right Transfer - FROM Map Section 3, T1S, R3W, Washington County Cert. 23065

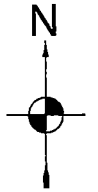

1 IN = 1320 FT
0 660 1320

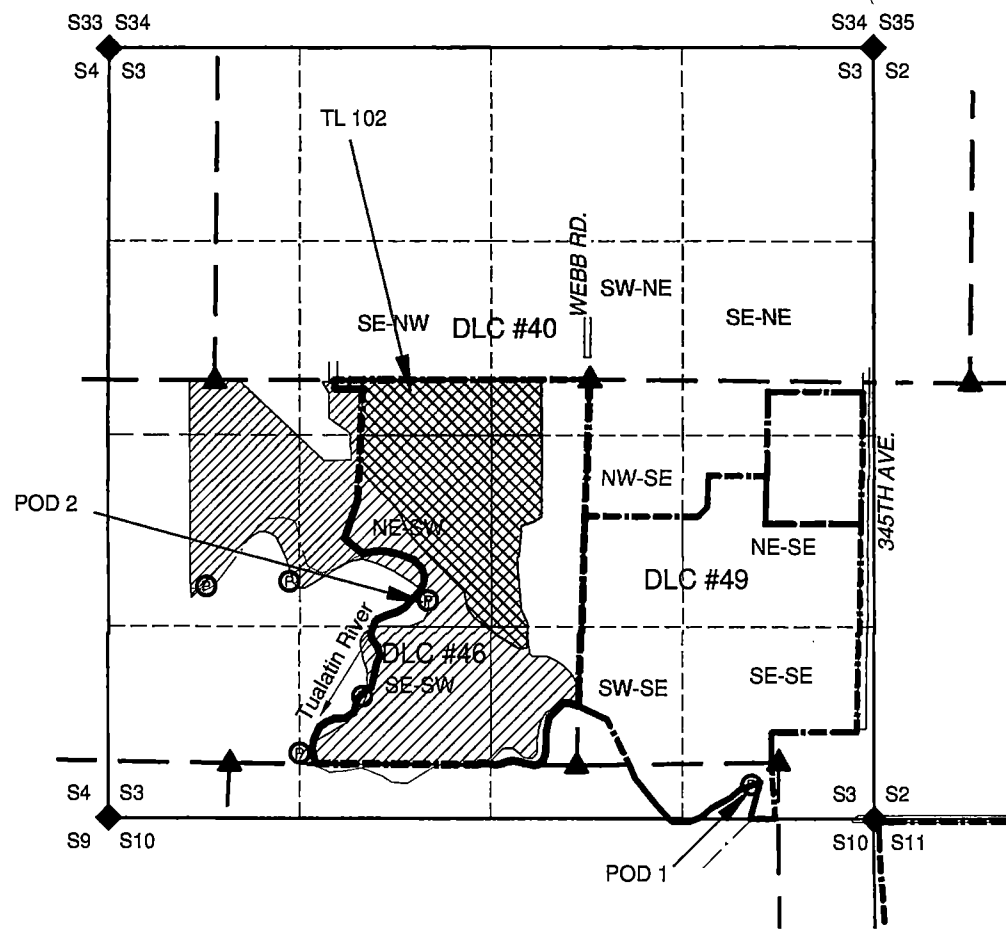

CERT 23065	
Acres Moving	
SW-NE	3.0
SE-NW	8.5
NE-SW	16.3
NW-SE	8.6
SW-SE	0.3
TOTAL	36.7

RECEIVED BY OWRD
DEC 06 2017
SALEM, OR

POD 2 IS 1500 FEET NORTH AND 3080 FEET WEST FROM THE SE CORNER SECTION 3.

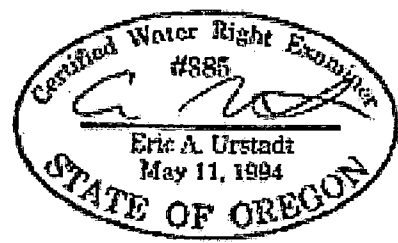

- LEGEND**
- ▲ DONATION LAND CLAIM (DLC) CORNER
 - STREAM OR SURFACE DRAINAGE
 - ◆ SECTION CORNER
 - Ⓟ POINT OF DIVERSION
 - TAX LOT LINE
 - SECTION LINE
 - QUARTER-QUARTER LINE
 - DLC LINES
 - QUARTER-QUARTER OF A SECTION

NOTES:
THIS MAP IS NOT INTENDED TO PROVIDE LEGAL DIMENSIONS OR LOCATIONS OF PROPERTY OWNERSHIP LINES.
-PROPERTY LINES AND Q-Q LINES ARE BASED ON TAX ASSESSOR MAP FOR SECTION 3 (CD), T1S, R3W.
-WATER CONVEYANCE LINES ARE ALL WITHIN THE PROPERTY AND THEREFORE ARE NOT SHOWN.

MAP BY:
ASPEN RURAL LAND CONSULTING
ERIC URSTADT, PE, PLS
971-250-1520
Sep 2017
Speer3H