

RECEIVED
 NOV 23 7:44
 WATER RESOURCE DEPT.
 EASTERN REGION

WATER RIGHT TRANSFER APPLICATION MAP
 MAP 2 of 2 -- Revised 11/19/03

Applicant: Ray Belnap
 4137 Kochemeier Road
 Vale, OR 97918
 541 473-2932

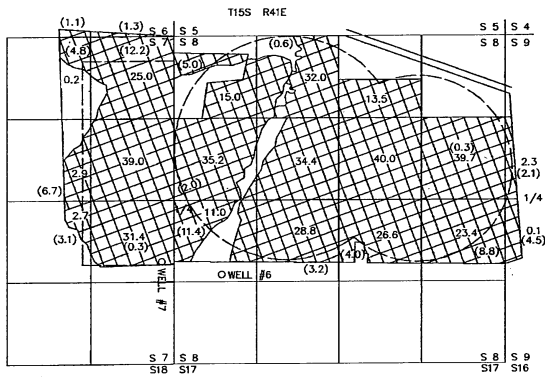

TRANSFER FROM MAP
 (Transfer From Acres in Parenthesis)

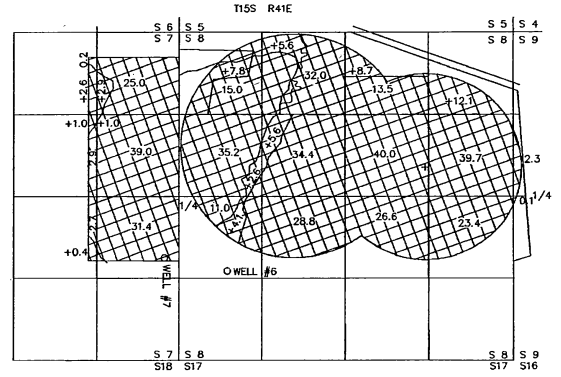

TRANSFER TO MAP
 Transfer To Acres with Plus Sign

Scale 1" = 1320'

Permit No. U-391 - 5/10/51
 474.6 acres from Wells #6 & 7
 Well #6
 1200S, 760E from W1/4 S8
 and Well #7
 995S, 200W from E1/4 S7
 Certificate No. 23632



This map is for the purpose of identifying the location of the water right only, and has no intent to provide dimensions or location of property ownership lines.



All in TAX LOT No. 15 41 300