

APOD Transfer Application Map for McElligott Morrow County, Oregon

MAY 26 2015

Decree Certificate 195

SALEM, OR

Township 1 South, Range 24 East (W.M.)

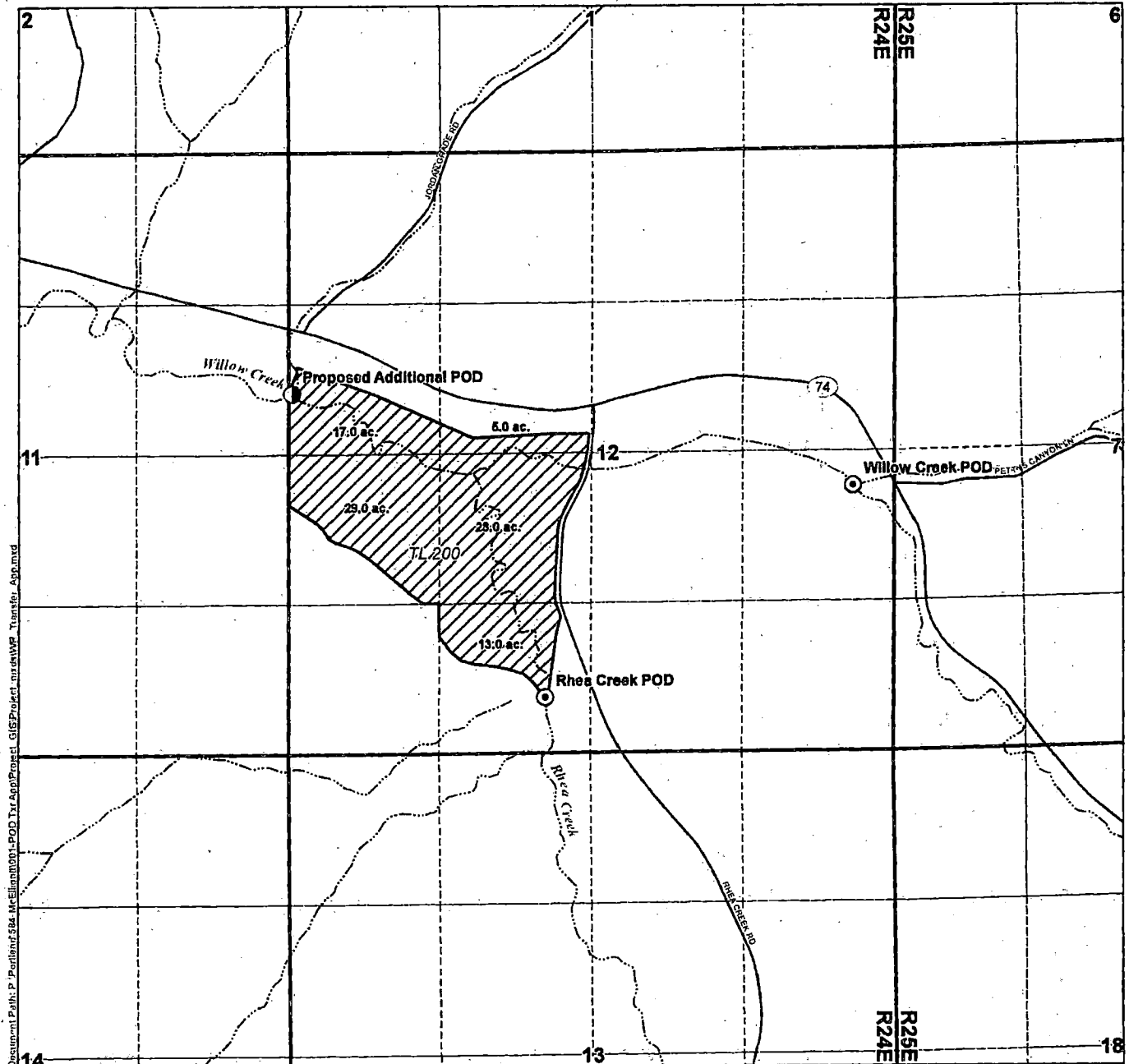

Document Path: P:\Projects\984_McElligott\POD Tr. Appl\Project_GIS\Project_mxd\WF_Transfer_App.mxd

LEGEND

- Authorized Place of Use (POU)
- Authorized Point of Diversion (POD)
- Proposed Additional POD
- Roads
- Watercourses

POD LOCATION DESCRIPTIONS

Willow Creek POD
Located 2,320 feet North and 355 feet West from the SE corner of Section 12, Township 1 South, Range 24 East (W.M.)

Rhea Creek POD
Located 485 feet North and 2,235 feet East from the SW corner of Section 12, Township 1 South, Range 24 East (W.M.)

Proposed Additional POD
Located 2,100 feet South and 30 feet East from the NW corner of Section 12, Township 1 South, Range 24 East (W.M.)

Certified Water Rights Examiner Stamp

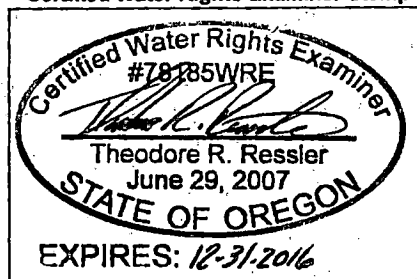

Disclaimer

This map was prepared for the purpose of identifying the location of a water right only and it is not intended to provide legal dimensions or location of property ownership lines.

Map Notes

Date: May 5, 2015
Data Sources: OWRD, US BLM, USGS, ESRI
Prepared By: GSI Water Solutions, Inc.

T 12068



0 660 1,320
1 inch = 1,320 feet



CLAIM OF BENEFICIAL USE MAP
 FOR TRANSFER 12068, CERT 195
 IN THE NAME OF
 MARK AND CYDNEY McELIGOTT
 SEC 12, T1S, R24E W.M., MORROW COUNTY

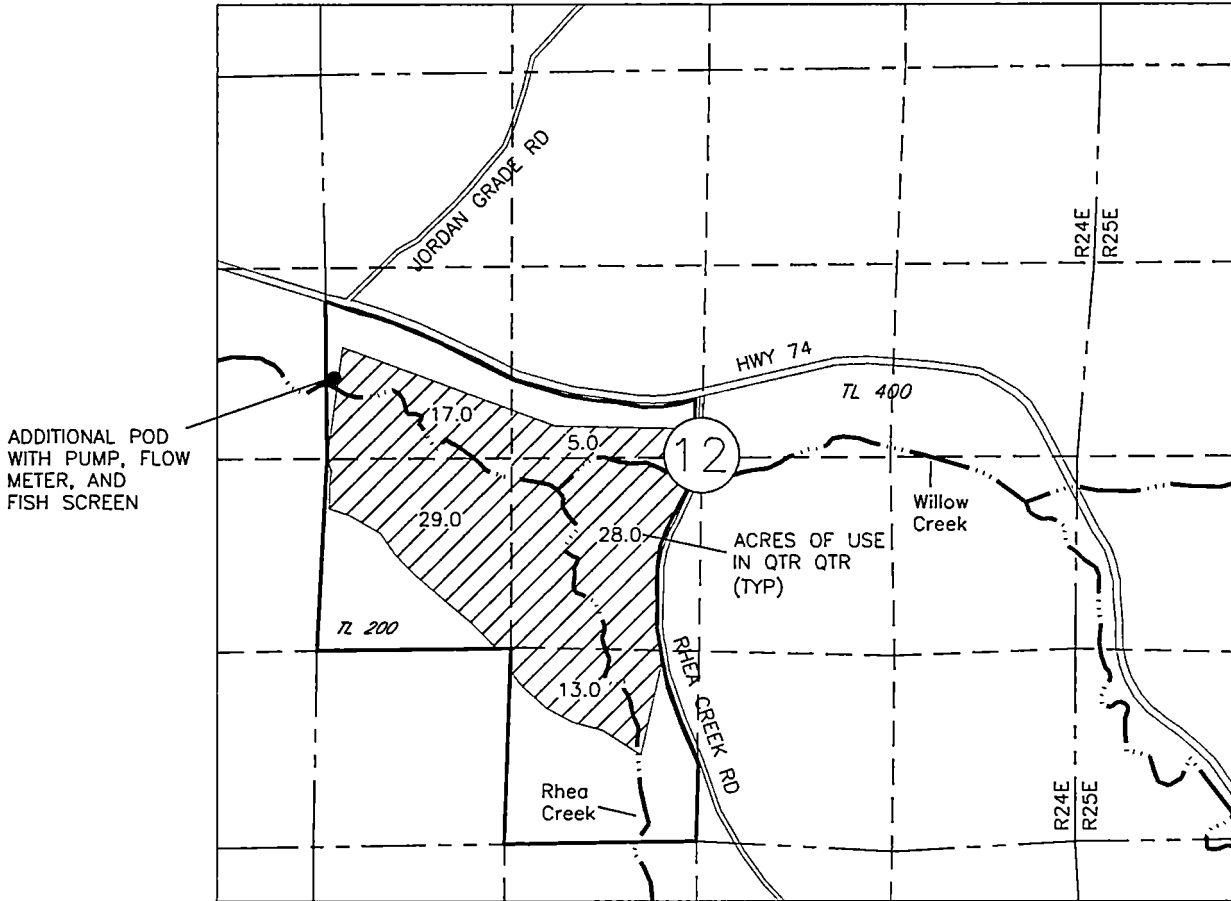

RECEIVED

FEB 25 2019

DWR

LEGEND



AREA OF USE



ADDITIONAL POD
 LOCATED 2100' SOUTH AND 30' EAST
 FROM THE NW CORNER OF SEC 12



TAX LOT
 BOUNDARY

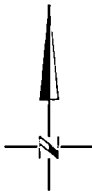

SCALE IN FEET

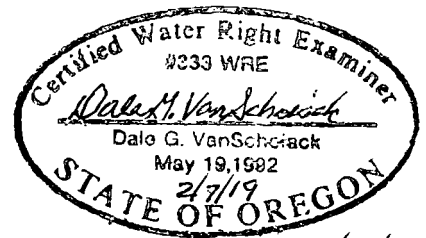

Renews 6/30/20

NOTE:
 THE PURPOSE OF THIS MAP IS TO IDENTIFY THE APPROXIMATE LOCATION
 OF THE WATER RIGHT. IT IS NOT INTENDED TO PROVIDE INFORMATION
 RELATIVE TO THE LOCATION OF PROPERTY OWNERSHIP BOUNDARY LINES.

DGV Consulting, PLLC
 PHONE (509) 627-8717
 dalevconsulting@gmail.com
 Date: Jan 24, 2019