

**T20S R36E WM
HARNEY COUNTY, OR**

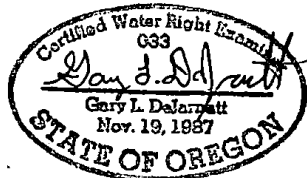

0 1,320
Feet
1" = 1,320'

- POD
- - Canal
- POU IR
- Township
- Section
- - - Quarter Quarter
- Tax Lot
- - - - - Creeks



RENEWAL DATE 12/31/2019

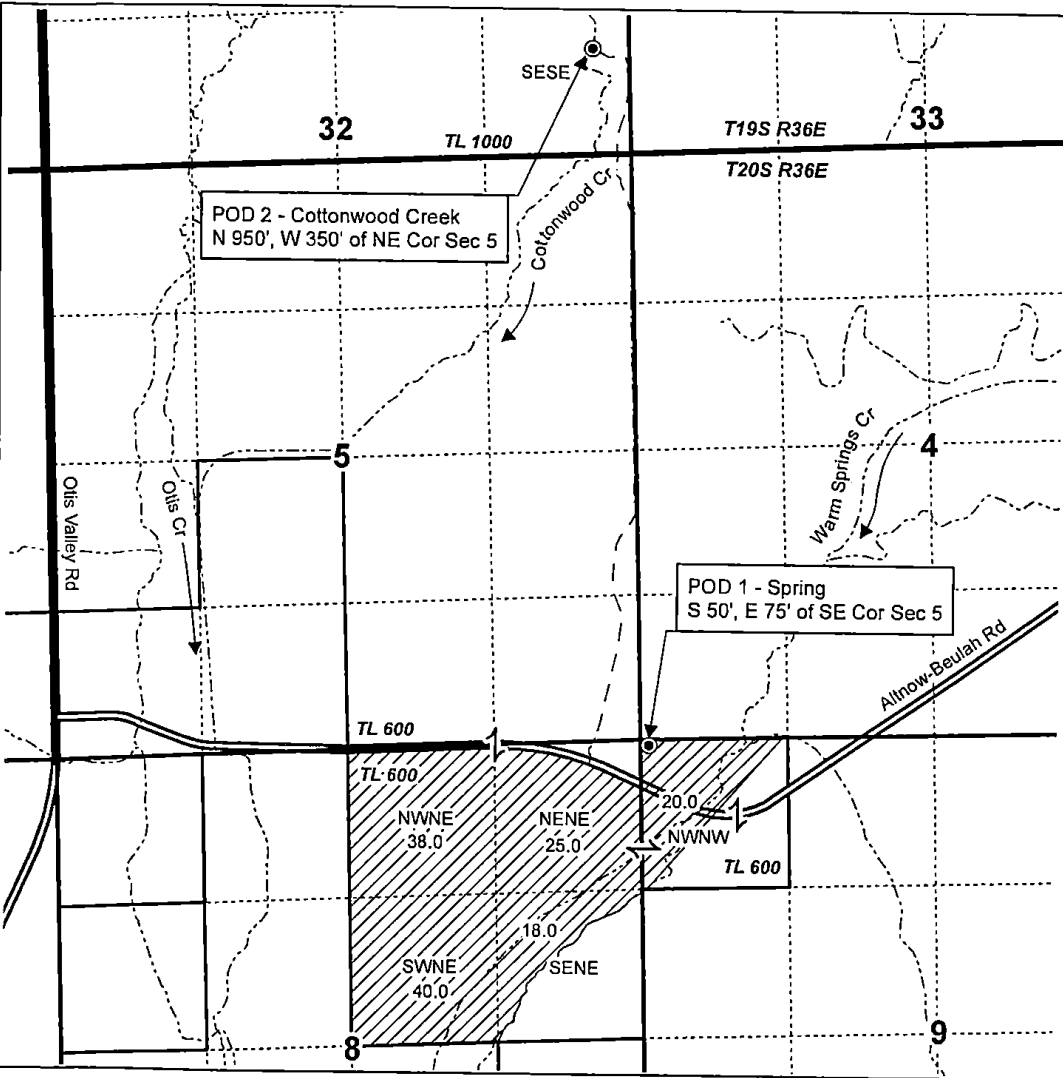

**CLAIM OF BENEFICIAL USE MAP
OTIS CREEK RANCH, LLC**

Date: 3/29/2019 Ap S-61933 Permit S-46274

Project #18065

This map is not intended to provide legal dimensions or locations of property ownership lines.

WATER RIGHT SERVICES, LLC
PO BOX 1830, BEND, OR 97709
WWW.OREGONWATER.US CCB # 197121
johnshort@usa.com 541-389-2837