

**Partial Perfection Claim  
of Beneficial Use  
Place of Use Map  
Permit G-17583,  
Application G-12515**

**A Water Right in the  
Name of City of Newberg  
Marion and Yamhill Counties**

**Township 3 South,  
Range 2 West (W.M.)**

- LEGEND**
- ⊙ Point of Appropriation (POA)
  - ▨ Place of Use (POU)
  - - - Donation Land Claim (DLC)
- All Other Features**
- ⊕ Tax Lot
  - City Service Area Boundary
  - County Boundary
  - ≡ Major Road
  - ~ Watercourse
  - Waterbody

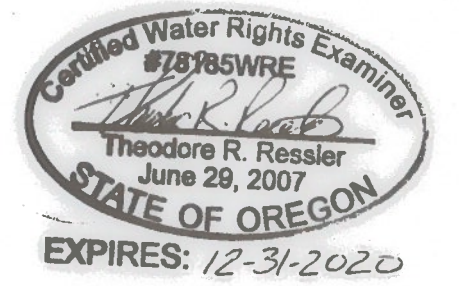

**DISCLAIMER**  
This map was prepared for the purpose of identifying the location of a water right only and it is not intended to provide legal dimensions or location of property ownership lines.

**MAP NOTES**  
Date: March 18, 2019  
Data Sources: OGIC, OWRD, USGS, Yamhill and Marion Co., ESRI

N

RECEIVED  
APR 05 2019  
OWRD



**Partial Perfection Claim of Beneficial Use  
Point of Appropriation Map  
Permit G-17583, Application G-12515  
A Water Right in the Name of City of Newberg  
Marion and Yamhill Counties  
Township 3 South, Range 2 West (W.M.)**

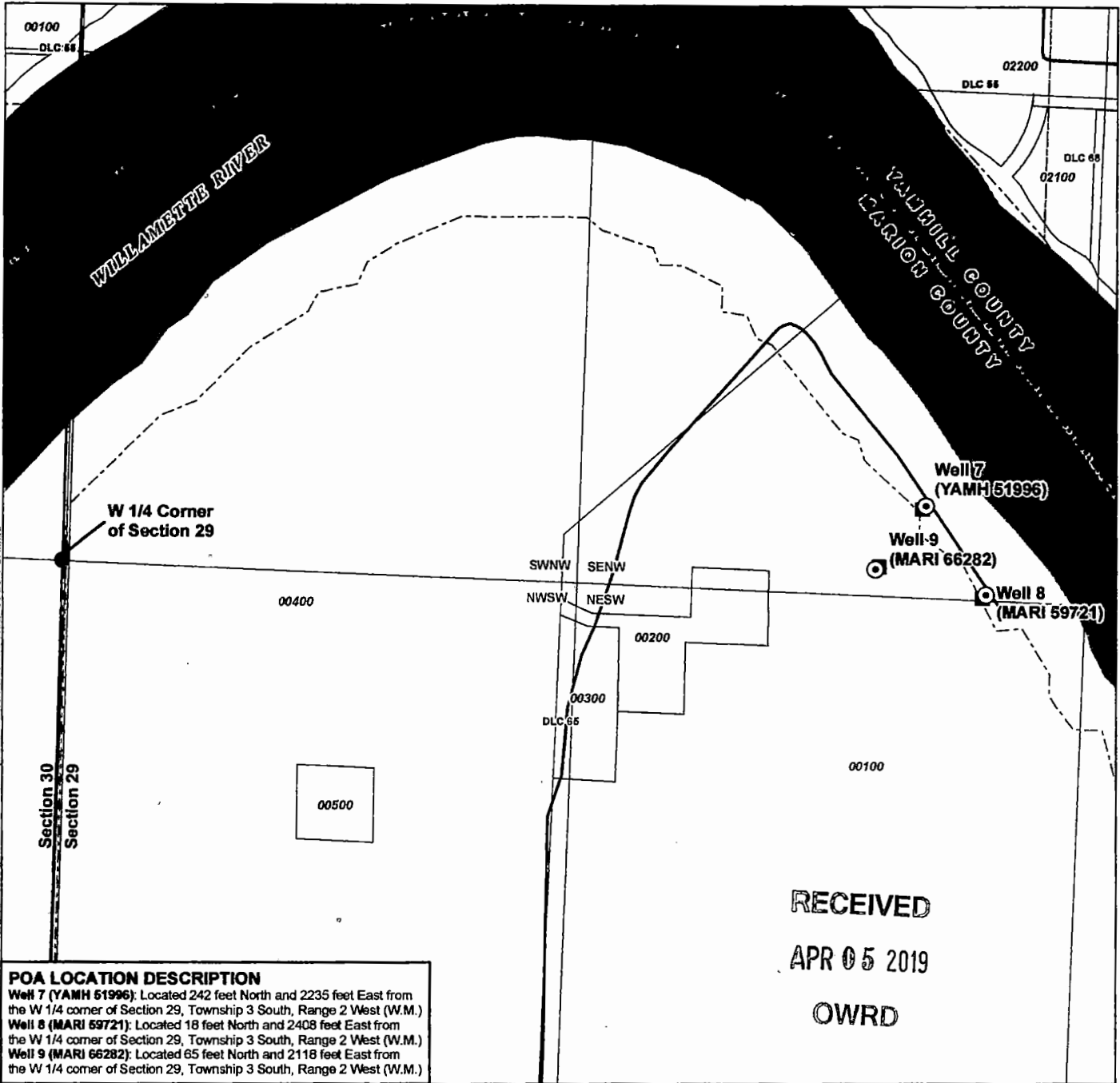

Document Path: Y:\0105 - Newberg\Source Figures\013 WMCP Update and WRR Review\Partial COBU POA.mxd

**POA LOCATION DESCRIPTION**  
**Well 7 (YAMH 51996):** Located 242 feet North and 2235 feet East from the W 1/4 corner of Section 29, Township 3 South, Range 2 West (W.M.)  
**Well 8 (MARI 59721):** Located 18 feet North and 2408 feet East from the W 1/4 corner of Section 29, Township 3 South, Range 2 West (W.M.)  
**Well 9 (MARI 66282):** Located 65 feet North and 2118 feet East from the W 1/4 corner of Section 29, Township 3 South, Range 2 West (W.M.)

RECEIVED  
APR 05 2019  
OWRD

- LEGEND**
- Point of Appropriation (POA)
  - Flow Meter
  - - - Donation Land Claim (DLC)
  - All Other Features**
  - Tax Lot
  - Major Road
  - ~ Watercourse
  - Waterbody



**DISCLAIMER**  
This map was prepared for the purpose of identifying the location of a water right only and it is not intended to provide legal dimensions or location of property ownership lines.

**MAP NOTES**  
Date: March 18, 2019  
Data Sources: OGIC, OWRD, USGS, Yamhill and Marion Co., ESRI

