

**T27S R34E, WM,  
HARNEY COUNTY, OR**



0 1,320  
Feet

1" = 1,320'

● Well & Meter

----- Pipeline

POU IR

Section

----- Quarter Quarter

Tax Lot

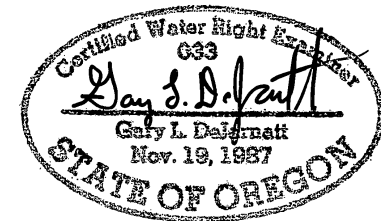

RENEWAL DATE 12/31/2019



Well 2 (L-120720) Location:  
1,220' S, 70' E of NW Cor Sec 16

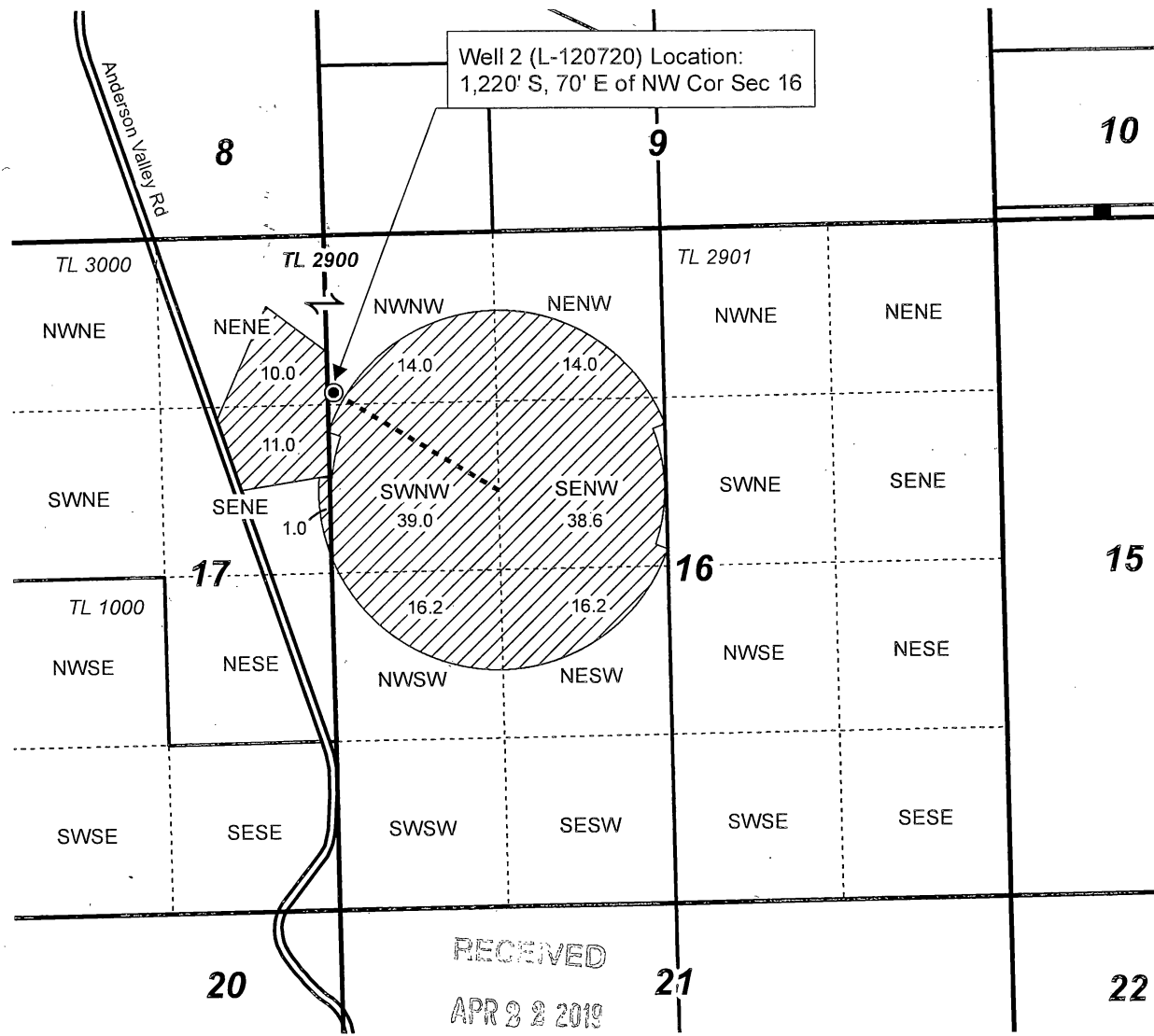

RECEIVED  
APR 22 2019  
OWRD

**CLAIM OF BENEFICIAL USE MAP  
Susan Opie**

Ap G-17014/T-12726 Permit G-18169

Date: 3/30/2019

PROJECT #18066

This map is not intended to provide legal dimensions or locations of property ownership lines.

**WATER RIGHT SERVICES, LLC**  
PO BOX 1830, BEND, OR 97709  
WWW.OREGONWATER.US CCB # 197121  
johnshort@usa.com 541-389-2837