

I, J. Elmer Nelson, of Glendale, Ore. do hereby certify that this map was made from notes taken during an actual survey made by me on March 7, 1923, and that it correctly represents the works described in the accompanying application, together with the location of other streams in the immediate vicinity.

J. Elmer Nelson
Surveyor.

Scale 1" = 200'
N.

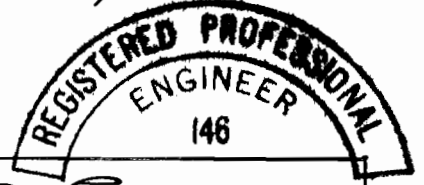

J. Elmer Nelson
OREGON
NOV. 8, 1919
J. ELMER NELSON

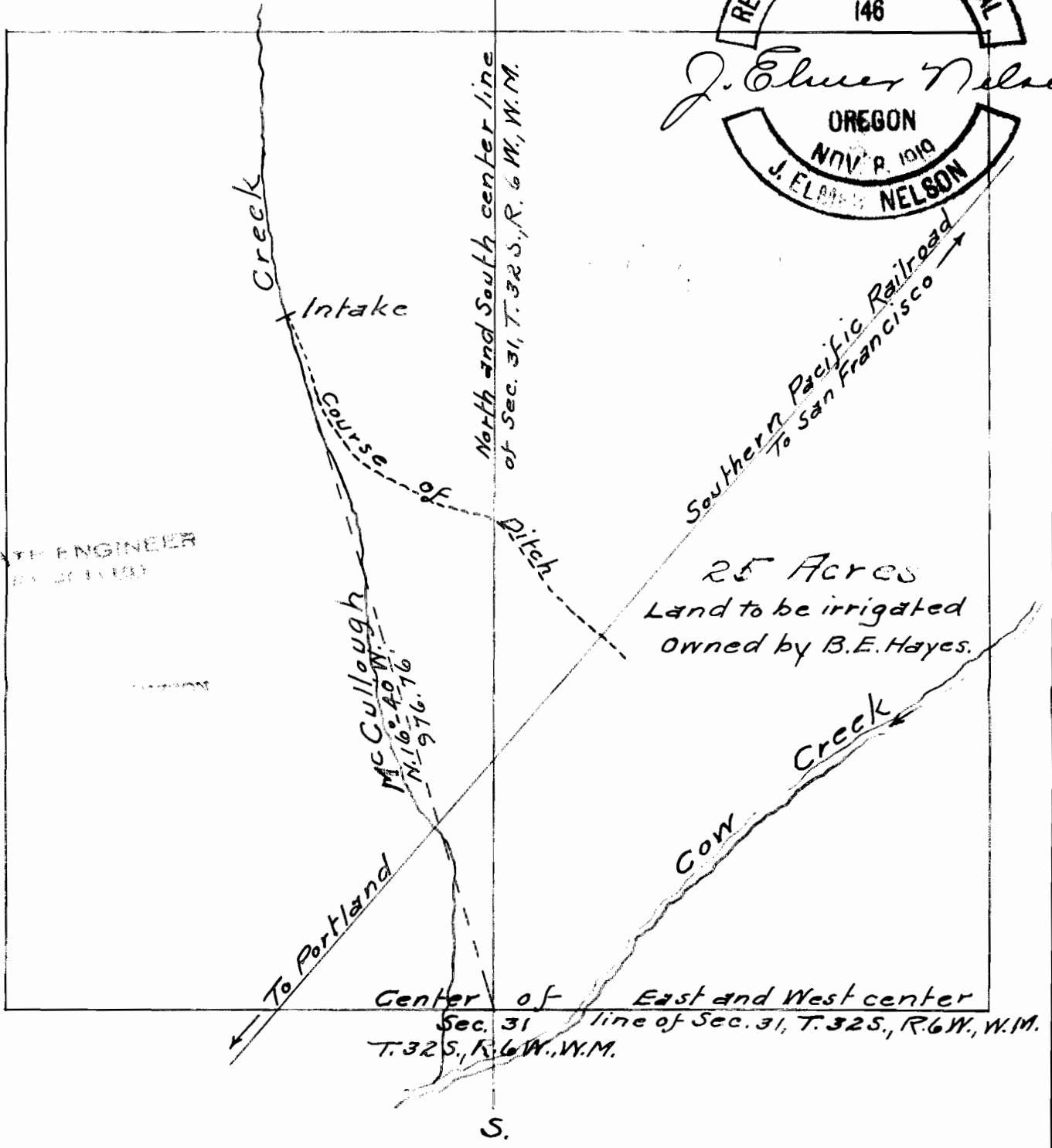

Application No 8877
Permit No 5839