

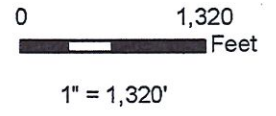

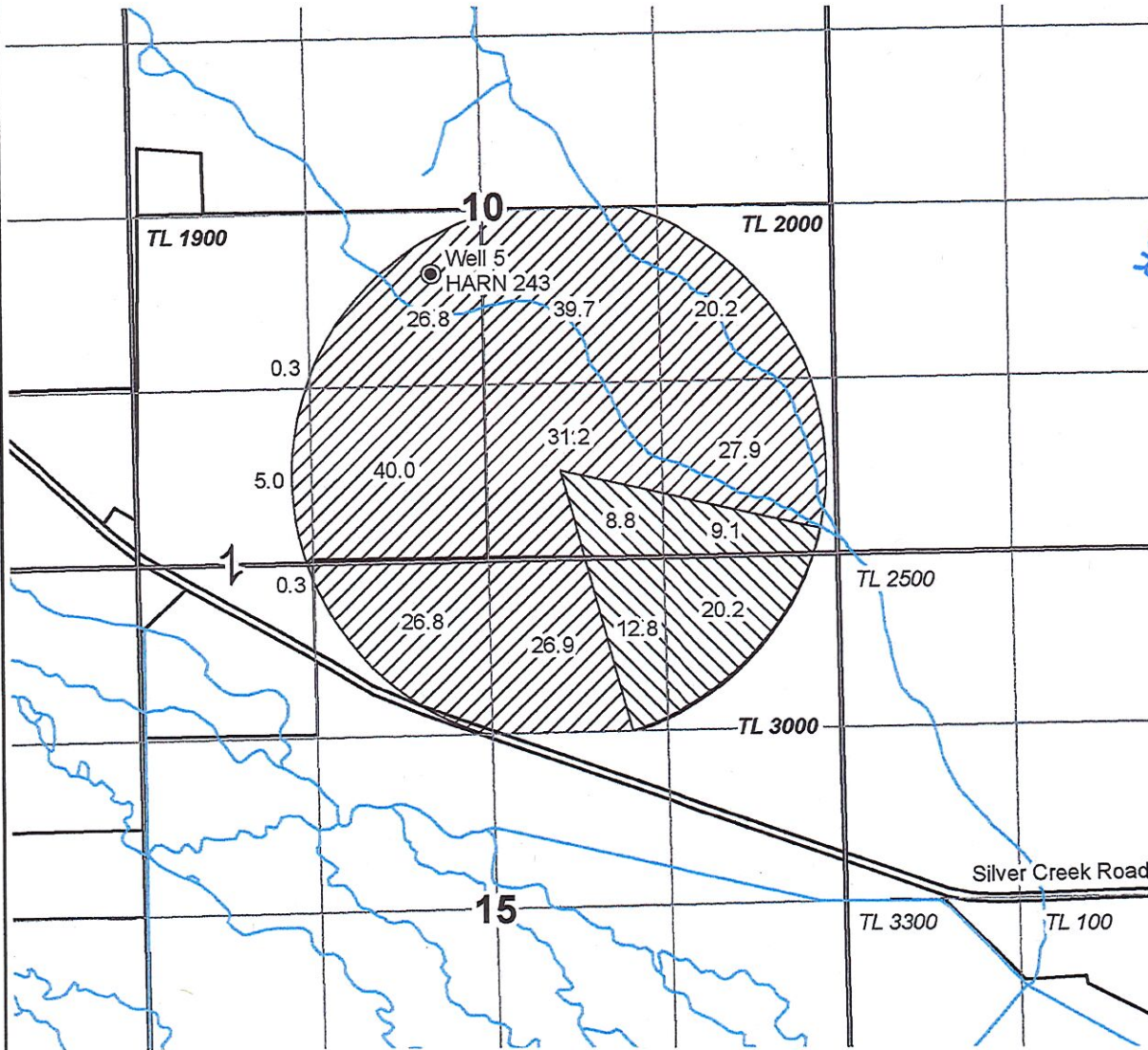



T23S R26E, WM, HARNEY COUNTY, OR



-  POU IR OFF
-  Cert 63600 Remaining
-  QQ
-  Tax Lots
-  Sections
-  Well

Well 5: 2178.5' N, 2205.1' E of SW Cor S10

Received by OWRD  
JUN 25 2019  
Salem, OR

Revised



RENEWAL DATE 12/31/2020

**TRANSFER OFF MAP**  
**Singhose Land & Cattle Company, LLC**

This map is not intended to provide legal dimensions or locations of property ownership lines.

**WATER RIGHT SERVICES, LLC**  
PO BOX 1830, BEND, OR 97709  
WWW.OREGONWATER.US CCB # 197121  
johnshort@usa.com 541-389-2837

Date: 6/8/2019 Cert 63600