

AMENDED CLAIM OF BENEFICIAL USE MAP FOR T-9454
 IN THE NAME OF EMERT RANCHES, INC. c/o JOSEPH McELIGOTT
 T1S, R24E, W.M. MORROW COUNTY
 SHEET 1 OF 3

#1172

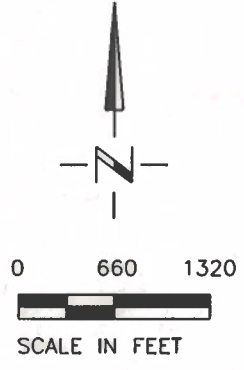
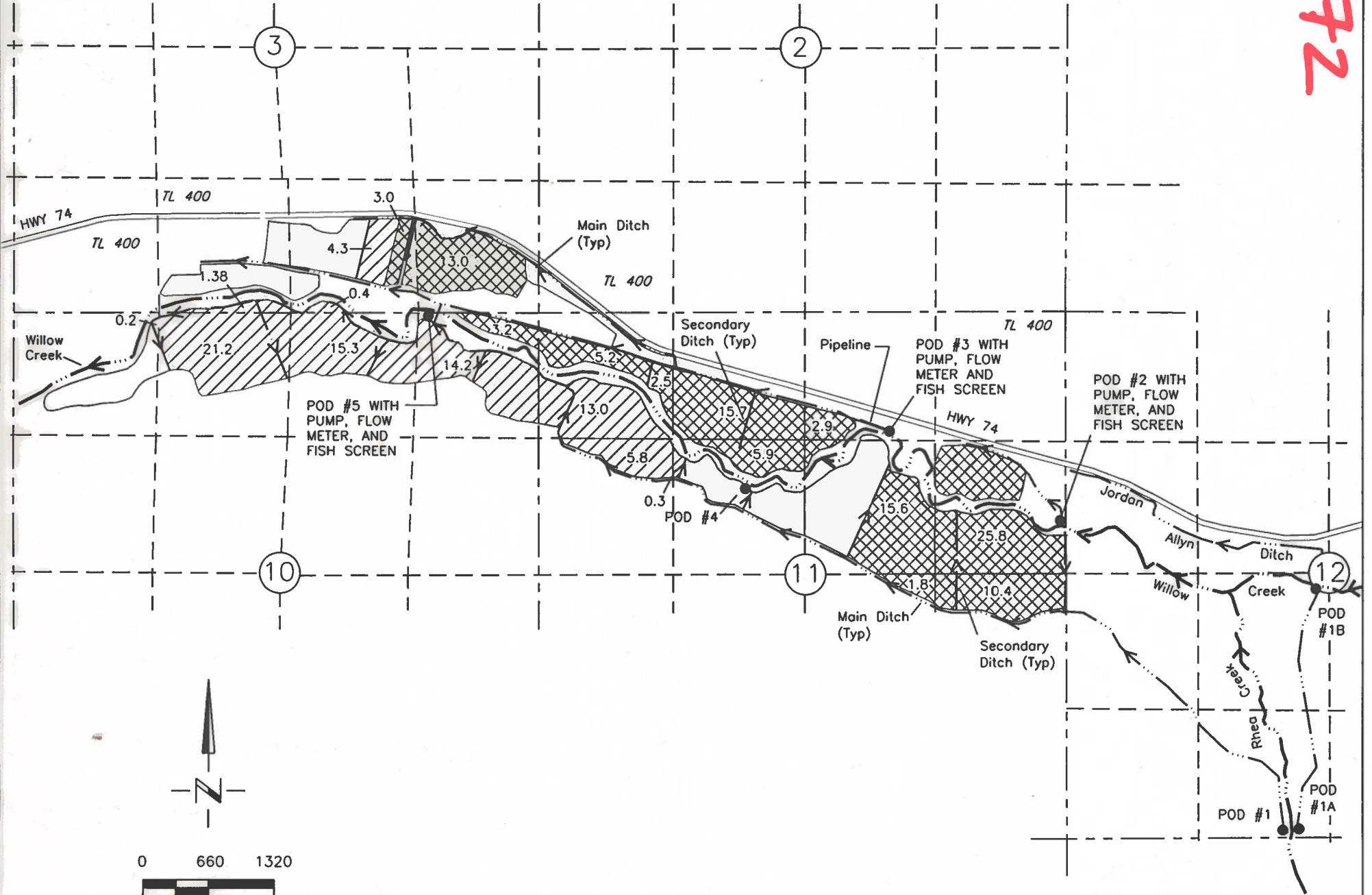

RECEIVED
 NOV 20 2019
 OWRD

LEGEND

| | AREA IRRIGATED | PRIORITY DATE | ACRES | PREVIOUSLY AUTHORIZED POD | ADDITIONAL POD CLAIMED WITH THIS COBU | |
|---|----------------|--------------------------|--------|---------------------------|---------------------------------------|--------------------------|
| 1 | | CERT 155 - 1878 | 105.00 | #1, #1A, & #1B | #5, #2 & #3 | POU MAPPED ON SHT 1 OF 3 |
| 2 | | CERT 154 - 1898 | 76.08 | #3 & #4 | #2 & #5 | POU MAPPED ON SHT 1 OF 3 |
| 3 | | CERT 152 - 1898 | 30.00 | #3 & #4 | #2 & #5 | POU MAPPED ON SHT 2 OF 3 |
| 3 | | CERT 152 - APRIL 1, 1908 | 10.00 | #4 & #5 | #2 & #3 | POU MAPPED ON SHT 2 OF 3 |
| 4 | | CERT 124 - 1906 | 7.00 | #4 | #2, #3 & #5 | POU MAPPED ON SHT 2 OF 3 |
| 5 | | CERT 79486 - 1908 | 20.00 | #3 | #2 & #5 | POU MAPPED ON SHT 3 OF 3 |
| 6 | | CERT 962 - DEC 20, 1912 | 33.31 | #3 | #2 & #5 | POU MAPPED ON SHT 3 OF 3 |

- LOCATION OF POINTS OF DIVERSIONS
- #1 PETTYS-SWAGGART DITCH RHEA CREEK - 130'N & 2160'E FROM THE SW COR OF SECTION 12
 - #1A JORDAN-ALLYN DITCH RHEA CREEK - 130'N & 2180'E FROM THE SW COR OF SECTION 12
 - #1B JORDAN-ALLYN DITCH WILLOW CREEK - 2470'N & 2360'E FROM THE SW COR OF SECTION 12
 - #2 WILLOW CREEK 2120'S & 30'W FROM THE NE COR OF SECTION 11
 - #3 PETTYS DITCH WILLOW CREEK - 1270'S & 1000'E FROM THE N 1/4 COR OF SECTION 11
 - #4 HAMMERS & HOWARD DITCH WILLOW CREEK - 1750'S & 2060'E FROM THE NW COR OF SECTION 11
 - #5 PUMP WILLOW CREEK - 20'S & 1240'W FROM THE NE CORNER OF SECTION 10

COBU MAP # 1172
 FOLGER 07

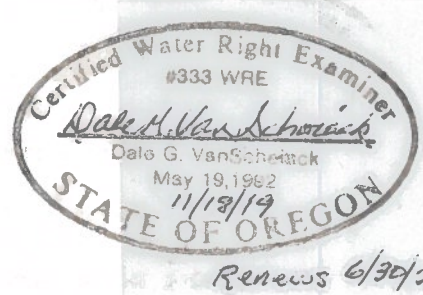

NOTE:
 THE PURPOSE OF THIS MAP IS TO IDENTIFY THE APPROXIMATE LOCATION OF THE WATER RIGHT. IT IS NOT INTENDED TO PROVIDE INFORMATION RELATIVE TO THE LOCATION OF PROPERTY OWNERSHIP BOUNDARY LINES.

DGV Consulting, PLLC
 PHONE (509) 627-8717
 dalevconsulting@gmail.com
 Date: Nov 8, 2019

AMENDED CLAIM OF BENEFICIAL USE MAP FOR T-9454
 IN THE NAME OF EMERT RANCHES, INC. c/o JOSEPH McELIGOTT
 T1S, R24E, W.M. MORROW COUNTY
 SHEET 2 OF 3

#1172

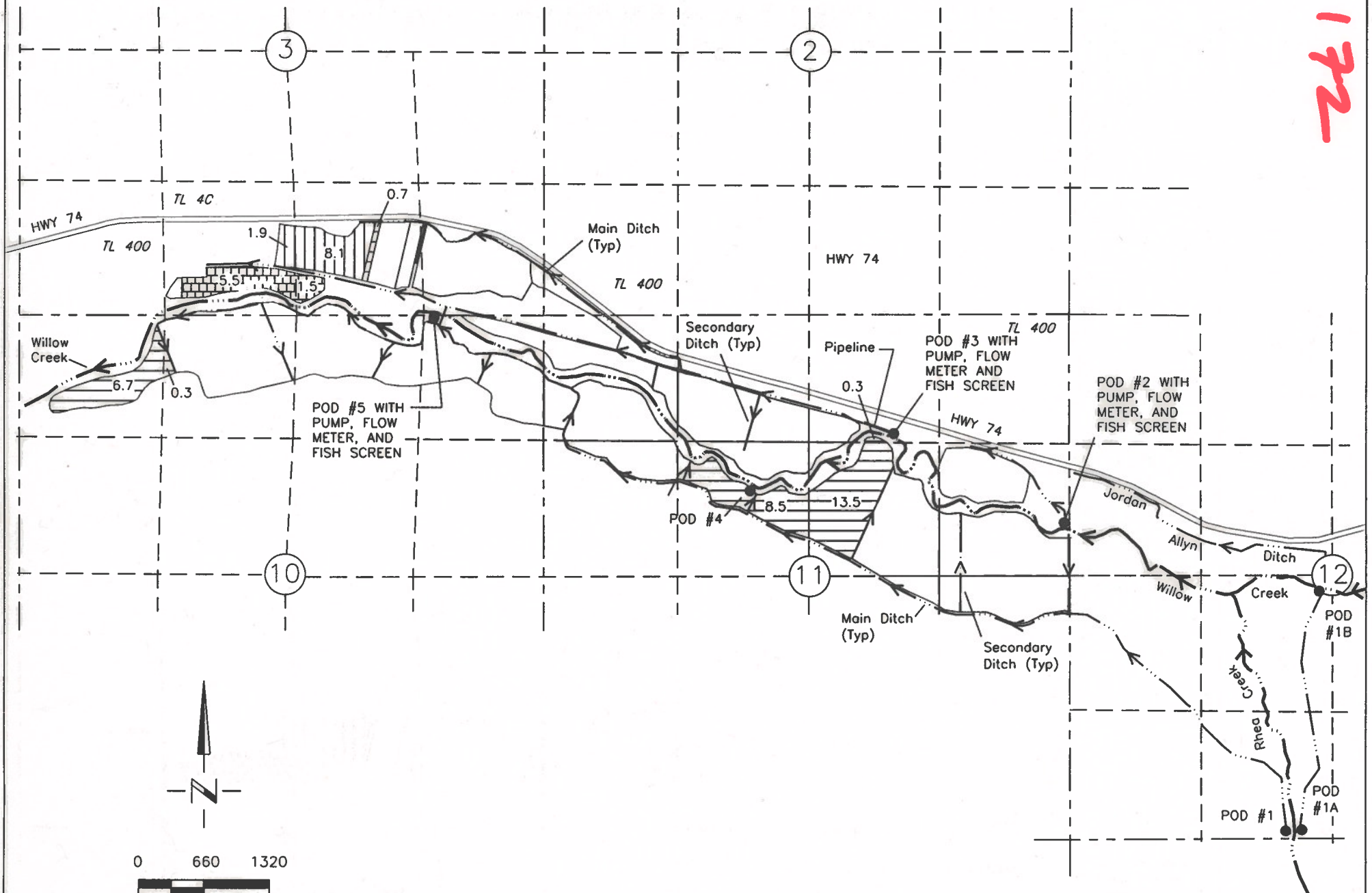

RECEIVED
 NOV 20 2019
 OWRD

LEGEND

| | AREA IRRIGATED | PRIORITY DATE | ACRES | AUTHORIZED PODS | ADDITIONAL PODS CLAIMED WITH THIS COBU | |
|---|----------------|--------------------------|--------|-----------------|--|--------------------------|
| 1 | | CERT 155 - 1878 | 105.00 | #1, #1A, & #1B | #5, #2 & #3 | POU MAPPED ON SHT 1 OF 3 |
| 2 | | CERT 154 - 1898 | 76.08 | #3 & #4 | #2 & #5 | POU MAPPED ON SHT 1 OF 3 |
| 3 | | CERT 152 - 1398 | 30.00 | #3 & #4 | #2 & #5 | POU MAPPED ON SHT 2 OF 3 |
| 3 | | CERT 152 - APRIL 1, 1908 | 10.00 | #4 & #5 | #2 & #3 | POU MAPPED ON SHT 2 OF 3 |
| 4 | | CERT 124 - 1906 | 7.00 | #4 | #2, #3 & #5 | POU MAPPED ON SHT 2 OF 3 |
| 5 | | CERT 79486 - 1908 | 20.00 | #3 | #2 & #5 | POU MAPPED ON SHT 3 OF 3 |
| 6 | | CERT 962 - DEC 20, 1912 | 33.31 | #3 | #2 & #5 | POU MAPPED ON SHT 3 OF 3 |

- LOCATION OF POINTS OF DIVERSIONS
- #1 PETTYS-SWAGGART DITCH RHEA CREEK - 130'N & 2160'E FROM THE SW COR OF SECTION 12
 - #1A JORDAN-ALLYN DITCH RHEA CREEK - 130'N & 2180'E FROM THE SW COR OF SECTION 12
 - #1B JORDAN-ALLYN DITCH WILLOW CREEK - 2470'N & 2360'E FROM THE SW COR OF SECTION 12
 - #2 WILLOW CREEK 2120'S & 30'W FROM THE NE COR OF SECTION 11
 - #3 PETTYS DITCH WILLOW CREEK - 1270'S & 1000'E FROM THE N 1/4 COR OF SECTION 11
 - #4 HAMMERS & HOWARD DITCH WILLOW CREEK - 1750'S & 2060'E FROM THE NW COR OF SECTION 11
 - #5 PUMP WILLOW CREEK - 20'S & 1240'W FROM THE NE CORNER OF SECTION 10

Certified Water Right Examiner
 #333 WRE
Dale G. VanSchoeck
 Dale G. VanSchoeck
 May 19, 1982
 11/18/19
 STATE OF OREGON
 Renew 6/30/20

COBU MAP # 1172
 FOLDER A-7

NOTE:
 THE PURPOSE OF THIS MAP IS TO IDENTIFY THE APPROXIMATE LOCATION OF THE WATER RIGHT. IT IS NOT INTENDED TO PROVIDE INFORMATION RELATIVE TO THE LOCATION OF PROPERTY OWNERSHIP BOUNDARY LINES.

DGV Consulting, PLLC
 PHONE (509) 627-8717
 dalevconsulting@gmail.com
 Date: Nov 8, 2019

AMENDED CLAIM OF BENEFICIAL USE MAP FOR T-9454
 IN THE NAME OF EMERT RANCHES, INC. c/o JOSEPH McELIGOTT
 T1S, R24E, W.M. MORROW COUNTY
 SHEET 3 OF 3

#1172

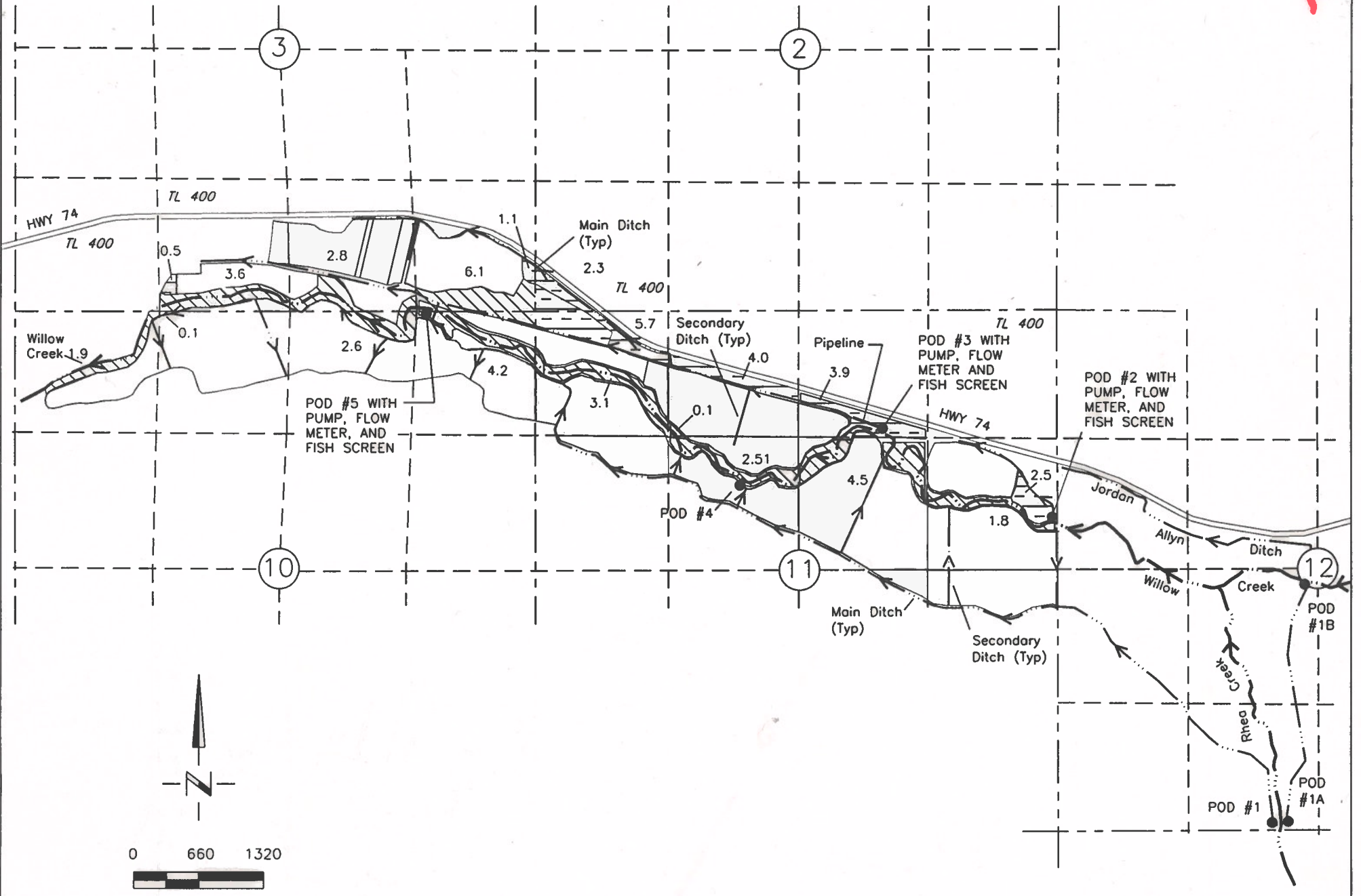

RECEIVED
 NOV 20 2019
 OWRD

LEGEND

| | AREA IRRIGATED | PRIORITY DATE | ACRES | AUTHORIZED PODS | ADDITIONAL PODS CLAIMED WITH THIS COBU | |
|---|----------------|--------------------------|--------|-----------------|--|--------------------------|
| 1 | | CERT 155 - 1878 | 105.00 | #1, #1A, & #1B | #5, #2 & #3 | POU MAPPED ON SHT 1 OF 3 |
| 2 | | CERT 154 - 1898 | 76.08 | #3 & #4 | #2 & #5 | POU MAPPED ON SHT 1 OF 3 |
| 3 | | CERT 152 - 1898 | 30.00 | #3 & #4 | #2 & #5 | POU MAPPED ON SHT 2 OF 3 |
| 3 | | CERT 152 - APRIL 1, 1908 | 10.00 | #4 & #5 | #2 & #3 | POU MAPPED ON SHT 2 OF 3 |
| 4 | | CERT 124 - 1906 | 7.00 | #4 | #2, #3 & #5 | POU MAPPED ON SHT 2 OF 3 |
| 5 | | CERT 79486 - 1908 | 20.00 | #3 | #2 & #5 | POU MAPPED ON SHT 3 OF 3 |
| 6 | | CERT 962 - DEC 22, 1912 | 33.31 | #3 | #2 & #5 | POU MAPPED ON SHT 3 OF 3 |

- LOCATION OF POINTS OF DIVERSIONS
- #1 PETTYS-SWAGGART DITCH RHEA CREEK - 130'N & 2160'E FROM THE SW COR OF SECTION 12
 - #1A JORDAN-ALLYN DITCH RHEA CREEK - 130'N & 2180'E FROM THE SW COR OF SECTION 12
 - #1B JORDAN-ALLYN DITCH WILLOW CREEK - 2470'N & 2360'E FROM THE SW COR OF SECTION 12
 - #2 WILLOW CREEK 2120'S & 30'W FROM THE NE COR OF SECTION 11
 - #3 PETTYS DITCH WILLOW CREEK - 1270'S & 1000'E FROM THE N 1/4 COR OF SECTION 11
 - #4 HAMMERS & HOWARD DITCH WILLOW CREEK - 1750'S & 2060'E FROM THE NW COR OF SECTION 11
 - #5 PUMP WILLOW CREEK - 20'S & 1240'W FROM THE NE CORNER OF SECTION 10

Certified Water Right Examiner
 #333 WRE
Dale G. VanSchoeck
 Dale G. VanSchoeck
 May 19, 1982
 11/18/19
 STATE OF OREGON
 Renews 6/30/20

COBU MAP# 1172
 Folder A-7

NOTE:
 THE PURPOSE OF THIS MAP IS TO IDENTIFY THE APPROXIMATE LOCATION OF THE WATER RIGHT. IT IS NOT INTENDED TO PROVIDE INFORMATION RELATIVE TO THE LOCATION OF PROPERTY OWNERSHIP BOUNDARY LINES.

DGV Consulting, PLLC
 PHONE (509) 627-8717
 dalevconsulting@gmail.com
 Date: Nov 8, 2019