

Smith - Historic Change in Point of Diversion

7/19/2019

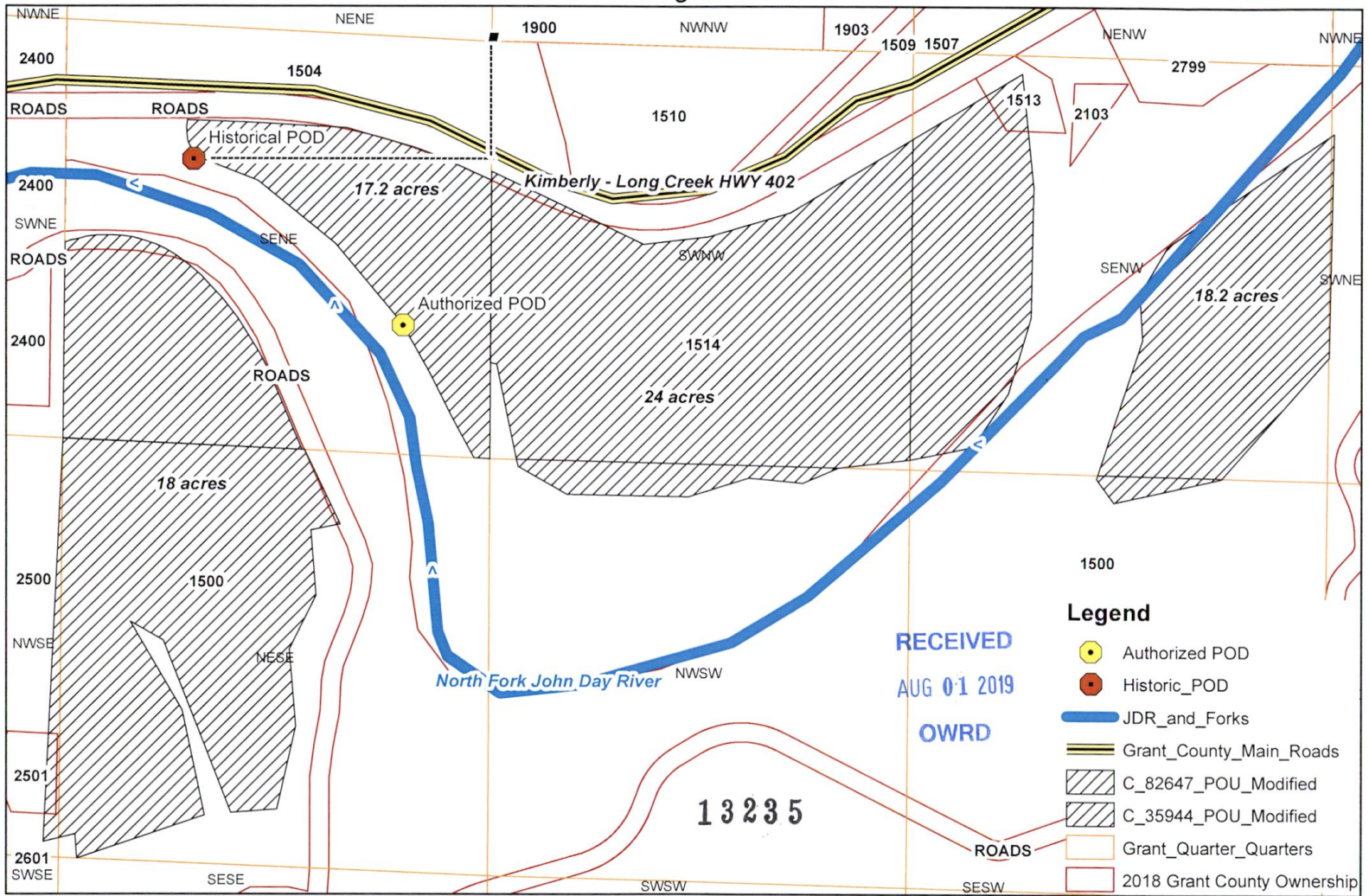

RECEIVED
AUG 01 2019
OWRD

- Legend**
- Authorized POD
 - Historic_POD
 - JDR_and_Forks
 - Grant_County_Main_Roads
 - C_82647_POU_Modified
 - C_35944_POU_Modified
 - Grant_Quarter_Quarters
 - 2018 Grant County Ownership

Authorized POD Location: 1680 feet North & 1020 feet East from NW corner SE, SE, Section 7.

Historical POD Location: 400 feet South & 930 feet West from the NE corner SE, NE, Section 7.

Location: -119.508983 44.805355 Decimal Degrees
Township: T 09S R 27E Sec: 07
QQ: SE NE Taxlot: 1514

1 inch = 400 feet
0 500 100 200 300 400

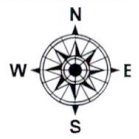

P-23605
35944

RECEIVED
AUG 01 2019
OWRD

T.9S. R.27E.W.M.

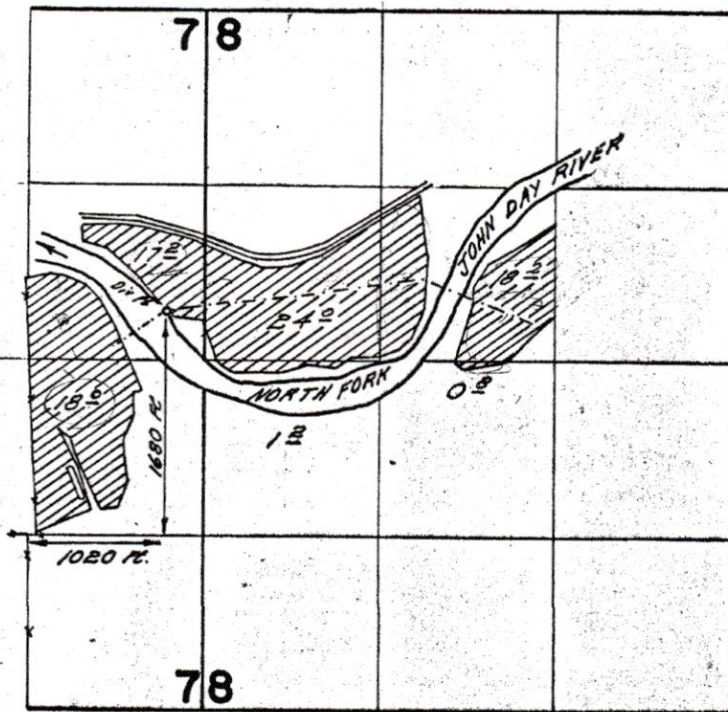

FINAL PROOF SURVEY
UNDER

Application No. *29964* Permit No. *23605*
IN NAME OF

W & E MILLER RANCHES, INC.

Surveyed *Nov. 14, 1962* by *R. JACKSON*
May 14, 1968 by *W. J. Fuggert*

1968-A
1968-M

13235